

**IN THE MATTER** of the Gambling Act 2003

**AND** on an application by **SKYCITY CASINO MANAGEMENT LIMITED** and **SKYCITY AUCKLAND LIMITED** for approval to construct cashiering facilities in the VIP Salons on Level 5

**BEFORE THE GAMBLING COMMISSION**

Members: G L Reeves (Chief Gambling Commissioner)  
P J Stanley  
L M Hansen

Date of Application: 13 April 2011

Date of Decision: 13 May 2011

Date of Notification  
of Decision: *18<sup>th</sup>* May 2011

**DECISION ON AN APPLICATION BY SKYCITY CASINO MANAGEMENT LIMITED AND SKYCITY AUCKLAND LIMITED FOR APPROVAL TO CONSTRUCT CASHIERING FACILITIES IN THE VIP SALONS ON LEVEL 5**

**Introduction**

1. SKYCITY Casino Management Limited ("**SCML**") and SKYCITY Auckland Limited ("**SCAL**") (together referred to as the "**Applicants**") applied to the Commission for approval, under conditions 6, 7 and 13 of SCAL's venue licence, and condition 22 of SCML's operator's licence, of construction and design changes to construct new cashiering facilities in the VIP salons on level 5 at the Auckland casino.
2. Submissions were sought on the proposal, from the Secretary for Internal Affairs (the "**Secretary**"), Problem Gambling Foundation, Gambling Helpline, Salvation Army and the Ministry of Health, with submissions being received from only the Secretary.

**Licence conditions**

3. The relevant licence conditions are:

**SCAL venue licence**

6. The licence Holder must obtain the approval of the Commission prior to:
  - (a) construction or design changes to Levels 2, 3, 5 and 6 of the casino venue, including the Gambling Area but excluding the SKYCITY Theatre and foyer area, restaurant and bar areas outside the Gambling Area, hotel rooms and the back of house areas used by staff (unless construction or design changes to any

of these excluded areas may impact on matters set out in condition 7 in which case prior approval must be sought);

- (b) the construction or relocation outside the Gambling Area and within the Casino Venue of bank facilities available to the public excluding ATMs, EFTPOS and like devices;
- (c) the addition or alteration of signage relating to the casino business on the exterior of the Casino Venue.

The process by which the Licence Holder may obtain approval for construction or design changes to Levels 2, 3, 5 and 6 of the casino venue, including the Gambling Area (paragraph (a) above) is set out in condition 7. The Commission will determine any application for approval under 6(b) and (c).

7. The Licence Holder must notify the Executive Director of any proposed changes to the construction or design of Levels 2, 3, 5 and 6 of the casino venue, including the Gambling Area but excluding SKYCITY Theatre and foyer area, restaurant and bar areas outside the Gambling Area, hotel rooms and the back of house areas used by staff. Notification must be accompanied by relevant drawings and an assessment of any impacts the alterations may have on:

- (a) the integrity and fairness of games;
- (b) the effectiveness of security and surveillance;
- (c) harm prevention, harm minimisation and responsible gambling;
- (d) potential access to the Gambling Area by persons under 20 years of age; and
- (e) compliance by any person with the Act, including section 11.

The Executive Director may approve the proposed changes to the construction or design if he or she is satisfied that there are no adverse impacts in relation to the matters specified in (a)-(e) above. If the Executive Director is not satisfied, he or she will refer the proposal to the Commission for determination.

13. The approval of the Commission is required for the construction and relocation of cashiering facilities additional to the principal facility in other parts of the Gambling Area to serve dedicated areas or rooms. Any such additional facilities must comply with the surveillance equipment requirements set out in the Surveillance Standard and be fitted with manually triggered and automatic silent alarm systems connected to the security/surveillance department.

#### **SCML operator's licence**

22. The approval of the Commission is required for the construction and relocation of cashiering facilities additional to the principal facility in other parts of the Gambling Area to service dedicated areas or rooms. Any such additional facilities must comply with the Surveillance Standard and be fitted with manually triggered and automatic silent alarm systems connected to the security/surveillance department.

#### **Submissions by SCML**

4. SCML submitted, in summary, as follows:

- (a) In decision GC33/10, the Commission approved construction and design changes to levels 5 and 6 of the Auckland casino to allow it to create an exclusive new VIP area. The level 5 Gambling Area will be made up of four international gaming salons and a general VIP area.
- (b) A principal cashiering facility is being constructed on the north side of the VIP area, and while they expect international patrons to use this facility, they also need to provide customised cashiering facilities in each of the VIP salons to provide an enhanced service consistent with international standards.
- (c) They propose constructing a stand-alone cashiering station adjoining the pit stand in each of the salons. The station will consist of a computer monitor, keyboard and printer, a dedicated area for transactions, and lockable cash and chip drawers. They will also meet the necessary alarm, CCTV and surveillance requirements.
- (d) Transactions conducted from these facilities will primarily consist of deposits into and drawdowns from patron accounts, exchange of commission play chips for non-negotiable chips used on commission programmes, and programme settlements involving telegraphic transfers and the issue of cheques.
- (e) The facilities will not be equipped with EFTPOS terminals.
- (f) They seek approval to construct the cashiering facilities generally in accordance with the plans attached to the application.

#### **The Secretary's submissions**

- 5. The Secretary submitted that the proposal raised no issues of regulatory concern.

#### **Analysis**

- 6. SKYCITY wants to install individual cashiering stations in each of the four VIP salons on level 5 in order to provide an enhanced service to its VIP patrons. The Commission consulted widely on the application as past proposals to increase access to money have been viewed with caution by the Concern Sector as they consider such moves to be contradictory to purpose 3(b) of the Act; namely "to prevent and minimise harm caused by gambling, including problem gambling". The Concern Sector did not file any submissions on the current application.
- 7. The proposal did not raise any issues of regulatory concern. While the Commission must be alert to the possibility that VIP patrons can suffer harm in the same manner that "regular" patrons can, the Commission considered it unlikely that they would be at an

increased risk as a result of this proposal. This view was confirmed by the lack of opposition by either the Secretary or the Concern Sector.

#### **Decision of the Commission**

8. The Commission approved, under conditions 6, 7 and 13 of SCAL's venue licence and condition 22 of SCML's operator's licence, the proposed construction and design changes, and to allow the Applicants to construct cashiering facilities in the four VIP salons on level 5.
9. The facilities must be constructed generally in accordance with the plan **attached** to this decision.

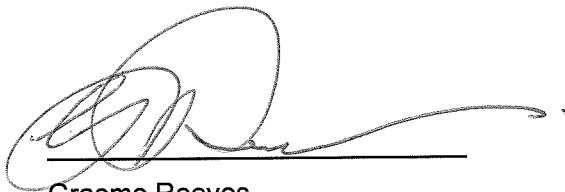

Graeme Reeves  
Chief Gambling Commissioner

for and on behalf of the  
Gambling Commission

18<sup>th</sup> May 2011



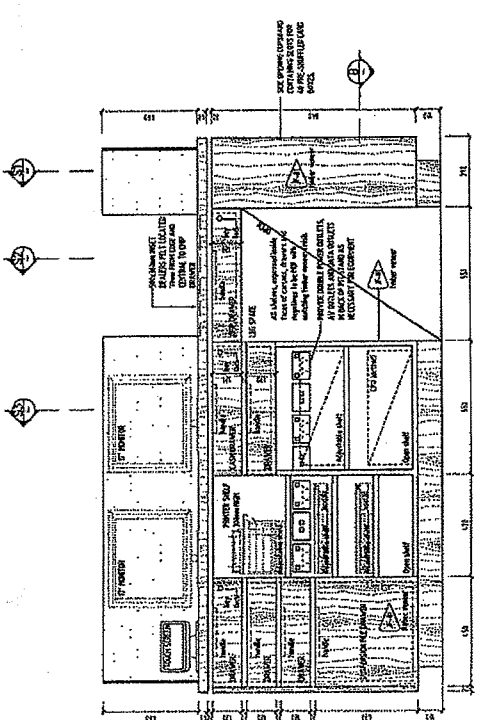

1 PIT STAND BACK ELEVATION  
1:10 @ A1 1:20 @ A3

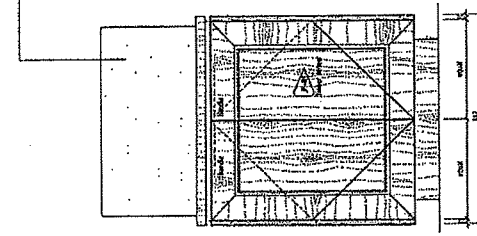

2 PIT STAND SIDE ELEVATION  
1:10 @ A1 1:20 @ A3

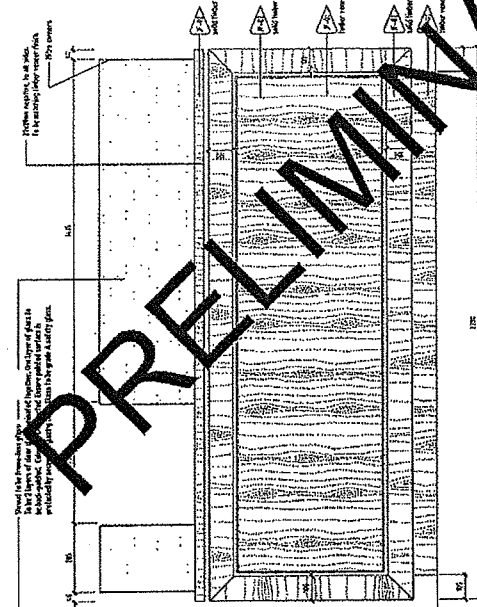

3 PIT STAND FRONT ELEVATION  
1:10 @ A1 1:20 @ A3

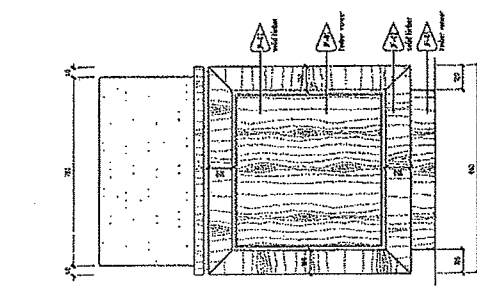

4 PIT STAND SIDE ELEVATION  
1:10 @ A1 1:20 @ A3

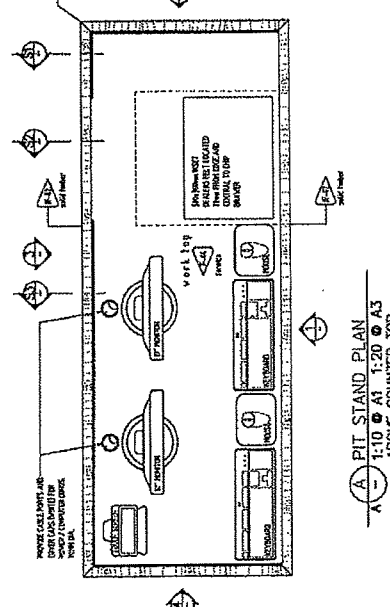

A PIT STAND PLAN ABOVE COUNTER TOP  
1:10 @ A1 1:20 @ A3

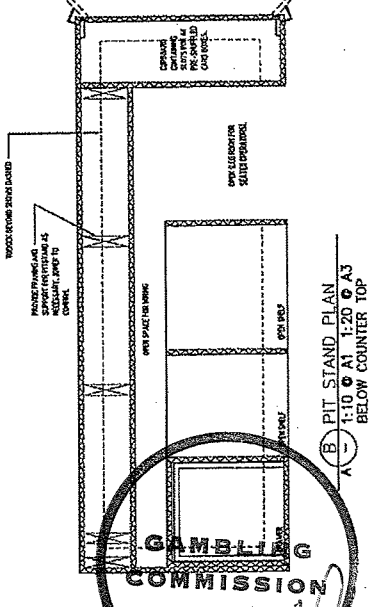

B PIT STAND PLAN BELOW COUNTER TOP  
1:10 @ A1 1:20 @ A3

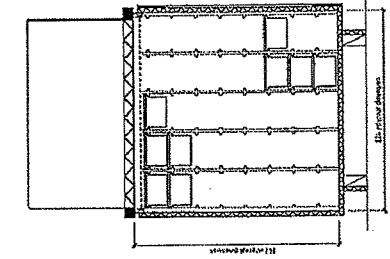

S1 PIT STAND SECTION  
1:10 @ A1 1:20 @ A3

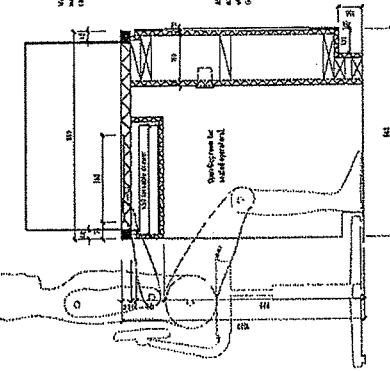

S2 PIT STAND SECTION  
1:10 @ A1 1:20 @ A3

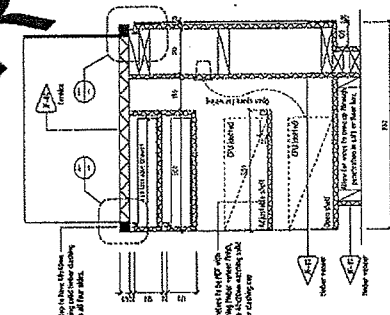

S3 PIT STAND SECTION  
1:10 @ A1 1:20 @ A3

PRELIMINARY

**Moller Architects**  
 1000 17th Street, Suite 1000  
 Denver, CO 80202  
 Tel: 303.733.1111  
 Fax: 303.733.1112  
 www.mollerarchitects.com

**SKY CITY**  
 Level H4, H5 & H6  
 New VIP Gaming for  
 SkyCity

**CLIENT AND PROJECT**  
 SKY CITY  
 Level H4, H5 & H6  
 New VIP Gaming for  
 SkyCity

**STARTING INFORMATION**  
 Sheet No. 01  
 Project No. 01  
 Date of Issue: 1/1/10  
 Scale: 1:10 @ A1 1:20 @ A3  
 Drawing No. 01  
 Revision: 01

**JOINERY COMPONENT**  
 PIT STANDS  
 SALONS: A, B, C & D  
 SHEET 01

- JOINERY NOTES**
1. ALL DRAWERS AND COMPONENTS TO BE FINISHED TO MATCH THE FINISH OF THE PIT STANDS.
  2. ALL DRAWERS TO BE FINISHED TO MATCH THE FINISH OF THE PIT STANDS.
  3. ALL DRAWERS TO BE FINISHED TO MATCH THE FINISH OF THE PIT STANDS.
  4. ALL DRAWERS TO BE FINISHED TO MATCH THE FINISH OF THE PIT STANDS.
  5. ALL DRAWERS TO BE FINISHED TO MATCH THE FINISH OF THE PIT STANDS.
  6. ALL DRAWERS TO BE FINISHED TO MATCH THE FINISH OF THE PIT STANDS.
  7. ALL DRAWERS TO BE FINISHED TO MATCH THE FINISH OF THE PIT STANDS.
  8. ALL DRAWERS TO BE FINISHED TO MATCH THE FINISH OF THE PIT STANDS.
  9. ALL DRAWERS TO BE FINISHED TO MATCH THE FINISH OF THE PIT STANDS.
  10. ALL DRAWERS TO BE FINISHED TO MATCH THE FINISH OF THE PIT STANDS.

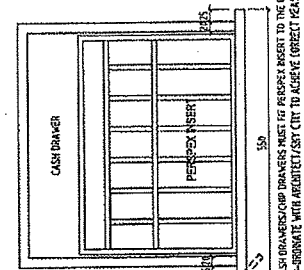
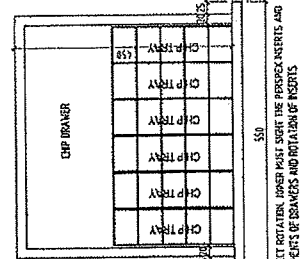

CASH DRAWERS/CUP DRAWERS MUST FIT PERFECTLY INTO THE CORRECT ROTATION. LOWER MUST SWIFT THE PERFECT INSERTS AND CO-ORDINATE WITH ARCHITECT/SITEY TO ACHIEVE CORRECT MEASUREMENTS OF DRAWERS AND ROTATION OF INSERTS.

