

IN THE MATTER of the Gambling Act 2003

AND on applications by
**CHRISTCHURCH CASINOS
LIMITED** relating to the
Christchurch casino

BEFORE THE GAMBLING COMMISSION

Members: P Chin (Chief Gambling Commissioner)
M M Lythe
P J Stanley
G L Reeves

Date of Application: 11 January 2010

Date of Decision: 19 February 2010

Date of Notification
of Decision: 26 February 2010

**DECISION ON APPLICATIONS BY CHRISTCHURCH CASINOS LIMITED
RELATING TO THE CHRISTCHURCH CASINO**

Introduction

1. Christchurch Casinos Limited ("**CCL**") applied:
 - (a) for approval of new floor plans, under conditions 11 and 12 of its operator's licence, to relocate its electronic roulette table and reconfigure its gaming machines on level 3;
 - (b) for approval of construction and design changes, under conditions 6 and 7 of its venue licence, to construct a chilled storage area and upgrade public toilet facilities, both on level 3 of the casino; and
 - (c) to temporarily redesignate the casino's Gambling Area, under condition 9 of CCL's operator's licence, to allow it to operate 14 gaming machines in the Velvet Room during the casino's refurbishment.

2. The relevant licence conditions are as follows:
 6. Subject to the provisions of condition 7, the Licence Holder must obtain the approval of the Commission prior to:
 - (a) construction or design changes to Levels 3 and 4 of the Casino Venue, including the Gambling Area but excluding the foyer, restaurant and bar areas on Level 3 outside the Gambling Area (unless construction or design changes to any of these excluded areas may impact on matters set out in condition 7 in which case prior approval must be sought);

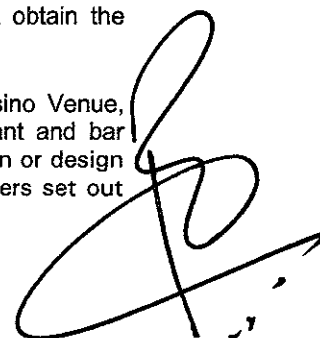

- (b) the construction or relocation outside the Gambling Area and within the Casino Venue of bank facilities available to the public excluding ATMs, EFTPOS and like devices;
- (c) the addition or alteration of signage relating to the casino business on the exterior of the Casino Venue.

The process by which the Licence Holder may obtain approval for construction or design changes to Levels 3 and 4 of the Casino Venue, (paragraph (a) above) is set out in condition 7. The Commission will determine any application for approval under 6(b) and (c).

- 7. The Licence Holder must notify the Executive Director of any proposed changes to the construction or design of Levels 3 and 4 of the Casino Venue, including the Gambling Area but excluding the foyer, restaurant and bar areas outside the Gambling Area. Notification must be accompanied by relevant drawings and an assessment of any impacts the alterations may have on:
 - (a) the integrity and fairness of games;
 - (b) the effectiveness of security and surveillance;
 - (c) harm prevention, harm minimisation and responsible gambling;
 - (d) potential access to the Gambling Area by persons under 20 years of age; and
 - (e) compliance by any person with the Act, including section 11 of the Act.

The Executive Director may approve the proposed changes to the construction or design if he or she is satisfied that there are no adverse impacts in relation to the matters specified in (a)-(e) above. If the Executive Director is not satisfied, he or she will refer the proposal to the Commission for determination.

- 9. The Gambling Area within the Casino Venue comprises the areas specified in plans approved by the Commission dated 22 September 2008.
- 11. The Licence Holder shall operate in accordance with approved floor layouts showing the position of gaming tables and gaming machines.
- 12. The Licence Holder shall obtain the approval of the Commission for new floor plans prior to relocating or installing tables or machines in positions not specified in approved floor layouts. When applying the Licence Holder must submit fresh plans showing the floor layout for the Gambling Area and details of the proposed CCTV layout for the consideration of the Commission. Any change must comply with the Surveillance Standard.

Submissions by CCL

- 3. CCL stated that:
 - (a) As part of its ongoing refurbishment of the Christchurch casino, it intends to replace its Touchbet Roulette table with a new Rapid Roulette table, and relocate it to the middle of the table gaming area.
 - (b) It wants to upgrade the gaming machine area on level 3. This will involve removing the gaming machines in two phases between 19 April 2010 and 16 July 2010, and relocating them in a straight formation, rather than their current diagonal formation.
 - (c) It will upgrade the existing public toilet facilities on level 3, to accommodate wheelchair access.

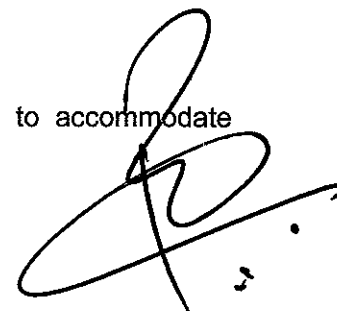

- (d) Once the refurbishment commences in April, it will remove a significant number of gaming machines from operation. In order to minimise the impact of this, it wants to temporarily designate the Velvet Room as gambling area, and to operate 14 gaming machines in this area.

4. CCL submitted that:

- (a) It will remove the gaming machines on level 3 in two stages during the refurbishment, and reinstall them in straight lines for a better use of space.
- (b) The additional space that this will create will allow it to relocate the gaming machines currently in the Diamond Bar to the main area of level 3. This will in turn free-up space in the Diamond Bar and allow it to better act as a respite area.
- (c) As part of the refurbishment, it wants to create a small chilled storage area adjacent to the Valley Bar, which will allow it to extend the amount of stock currently available in that bar.
- (d) The construction changes are consistent with conditions 6 and 7 of its venue licence.
- (e) It will work closely with the local gambling inspectors regarding the transitional changes to ensure continued compliance with Minimum Operating Standards and CCTV requirements.
- (f) There are no changes to level 4.

The Secretary's submissions

5. The Secretary submitted that he had no regulatory concerns with CCL's proposals, provided that CCL notifies his inspectorate at least 24 hours prior to the implementation of any part, and particularly prior to any gaming equipment being withdrawn from, or commissioned back into service in their new location.

6. He also noted that:

- (a) Should the Commission consider a transitional plan to be appropriate, CCL has indicated to him that this can be provided.
- (b) Any approval of gaming machines in the Velvet Room should be clearly shown on a plan (which they are not at present), and CCL may wish to remove the jackpot names from the plan submitted for approval.

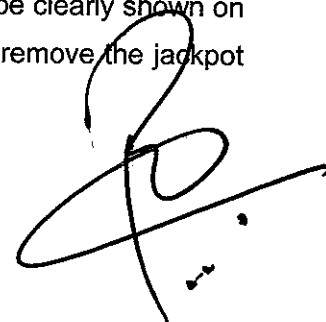
A handwritten signature in black ink, consisting of a large, stylized 'R' followed by a horizontal line and a small flourish.

CCL's submissions in reply

7. In reply, CCL submitted as follows:

- (a) It is happy to address the Secretary's suggestions regarding transitional plans and removal of the jackpot names. It therefore provides for approval, two transitional floor plans and an amended final floor plan, which are all free of jackpot references.
- (b) Transitional floor plan 1 shows the installation of the new Rapid Roulette table in its central location. This is expected to be completed by mid-March 2010.
- (c) Transitional plan 2 shows the Stage 1 area of the refurbishment and 14 gaming machines in the Velvet Room. There will be a net removal of 112 gaming machines during this stage.
- (d) The exact timing for the decommissioning and commissioning of gaming machines is still being worked through but this process will be completed in liaison with the local gambling inspectors.
- (e) When it opens up the Stage 1 area post-refurbishment, it will reinstall gaming machines in the manner set out in the final level 3 floor plan. Stage 2 work will then commence with the removal of the remainder of the gaming machines on level 3, before they are reinstalled in the manner set out in the final plan, post-refurbishment.

Analysis

- 8. CCL plans to refurbish the level 3 gaming area of the Christchurch casino and seeks a number of approvals to allow it to do this, and to reconfigure its layout of tables and machines. This will involve disruption at the Christchurch casino for approximately three months.
- 9. CCL's proposals do not raise any issues of regulatory concern – the Commission has previously allowed CCL to temporarily offer gambling in the Velvet Room and CCL has, following the Secretary's suggestion, provided a temporary floor plan for approval depicting 14 gaming machines in this area. CCL has also, sensibly, provided two transitional floor plans depicting its refurbishment in stages as it works towards the reinstallation of gambling product in the layout depicted in its new final plan.
- 10. The two transitional plans (transitional floor plans 1 and 2), the current permanent plans (September 2009) cease to be valid once CCL is reliant on the new permanent plan (January 2010).

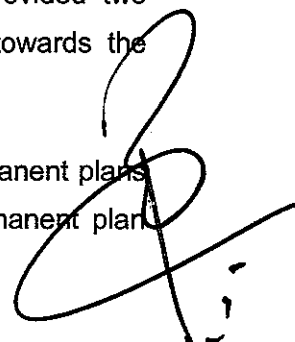

Decision of the Commission

11. The Commission decided:

- (a) to approve new floor plans (transitional floor plans 1 and 2, and January 2010) (all **attached**), under conditions 11 and 12 of CCL's operator's licence. The transitional plans and the current permanent plan (September 2009) will cease to be valid once CCL is fully reliant on plan "January 2010";
- (b) to approve the proposed construction and design changes, under conditions 6 and 7 of CCL's venue licence; and
- (c) to approve the temporary redesignation of the Velvet Room as Gambling Area, under condition 9 of its operator's licence. The temporary designation (defined in the **attached** plan) will conclude once CCL is reliant on plan "January 2010".

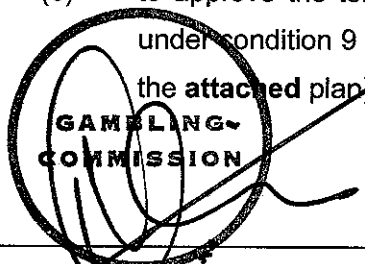

Peter Chin
Chief Gambling Commissioner

for and on behalf of the
Gambling Commission

26 February 2010

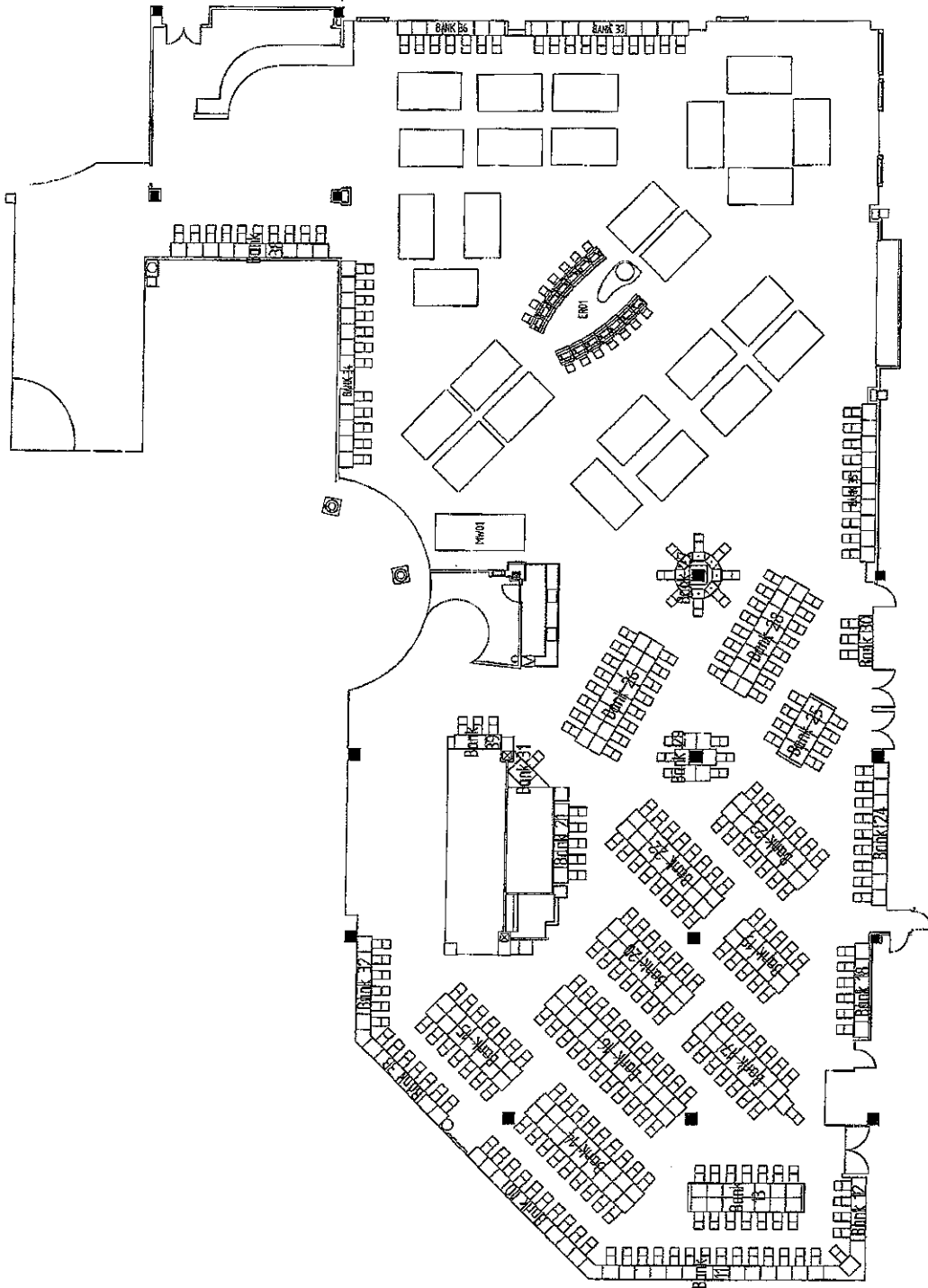

DATE: January 2010

SCALE 1:250

LEVEL 3 - Transitional floor plan 1

309 MACHINES, 28 TABLES

Christchurch Casinos Limited
 Stuart Scott

GAMBLING COMMISSION

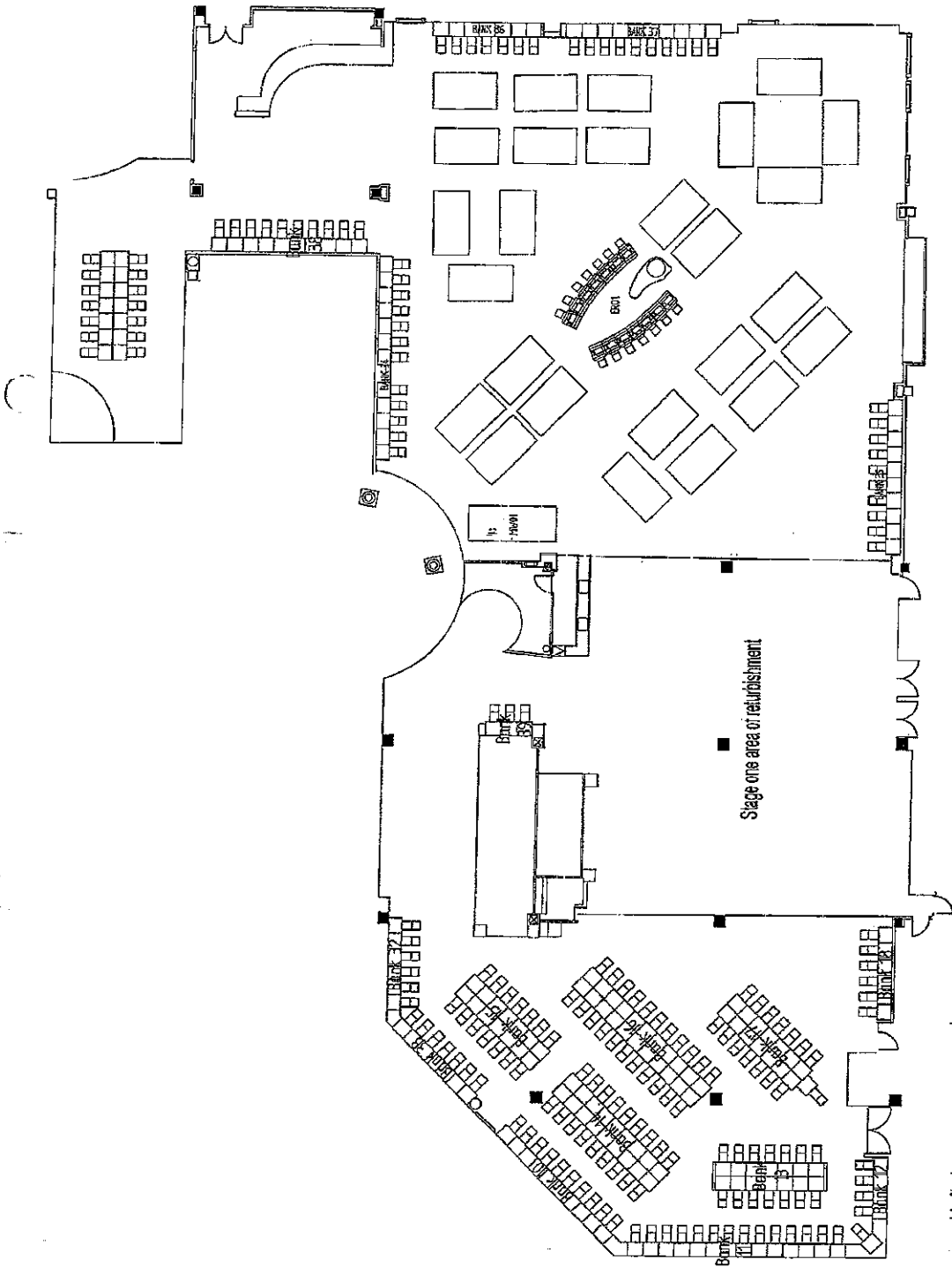

LEVEL 3 - Transitional floor plan 2

UP TO 309 MACHINES, 28 TABLES

DATE January 2010

SCALE 1:250

Christchurch Casinos Limited

Shaun Scott

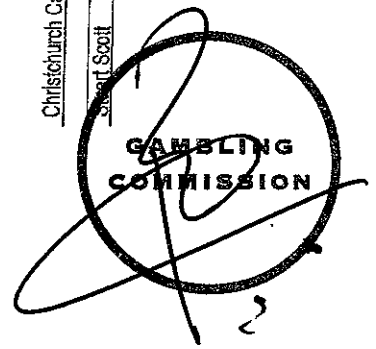

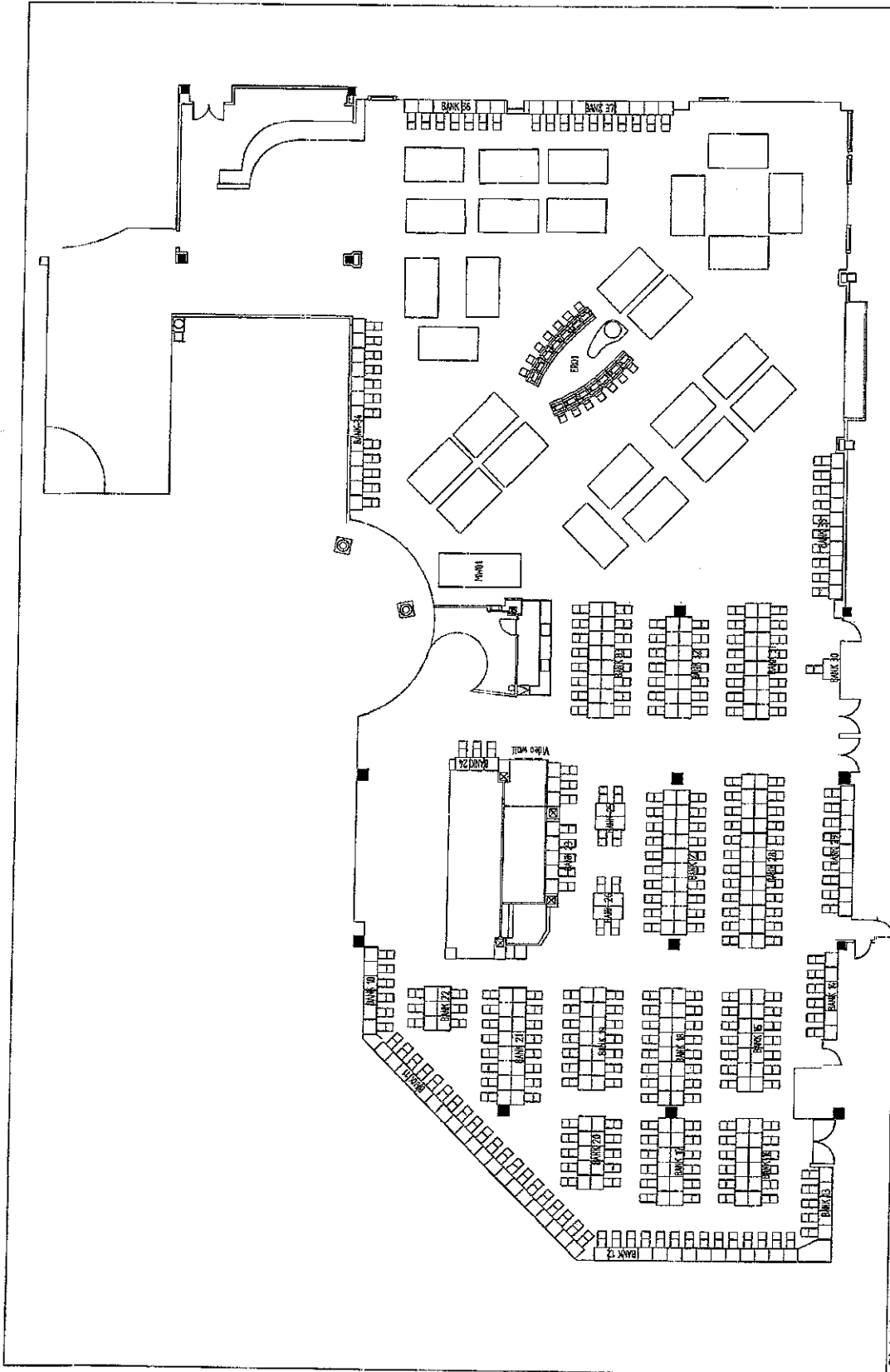

Christchurch Casinos Limited

Stuart Scott

LEVEL 3 - floor plan

309 MACHINES, 28 TABLES

DATE: January 2010

SCALE 1:250

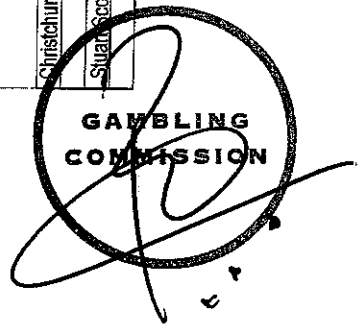

GAMBLING COMMISSION

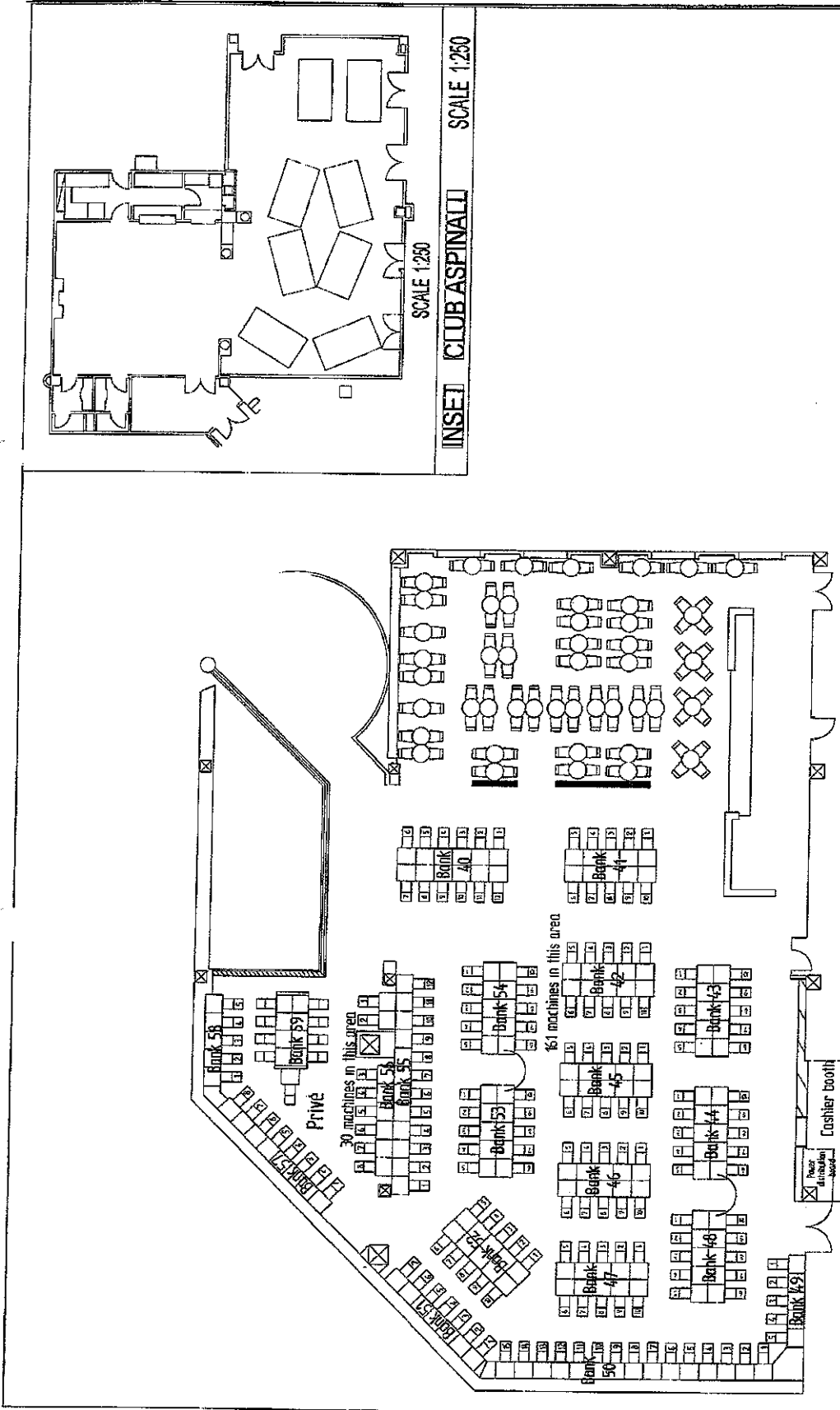

Christchurch Casinos Limited

Siva Scott

LEVEL 4 - Gallery floor plan
191 MACHINES - 8 Tables

DATE: JANUARY 2010

SCALE 1:250

INSET CLUB ASPINALL SCALE 1:250

SCALE 1:250

GAMBLING COMMISSION



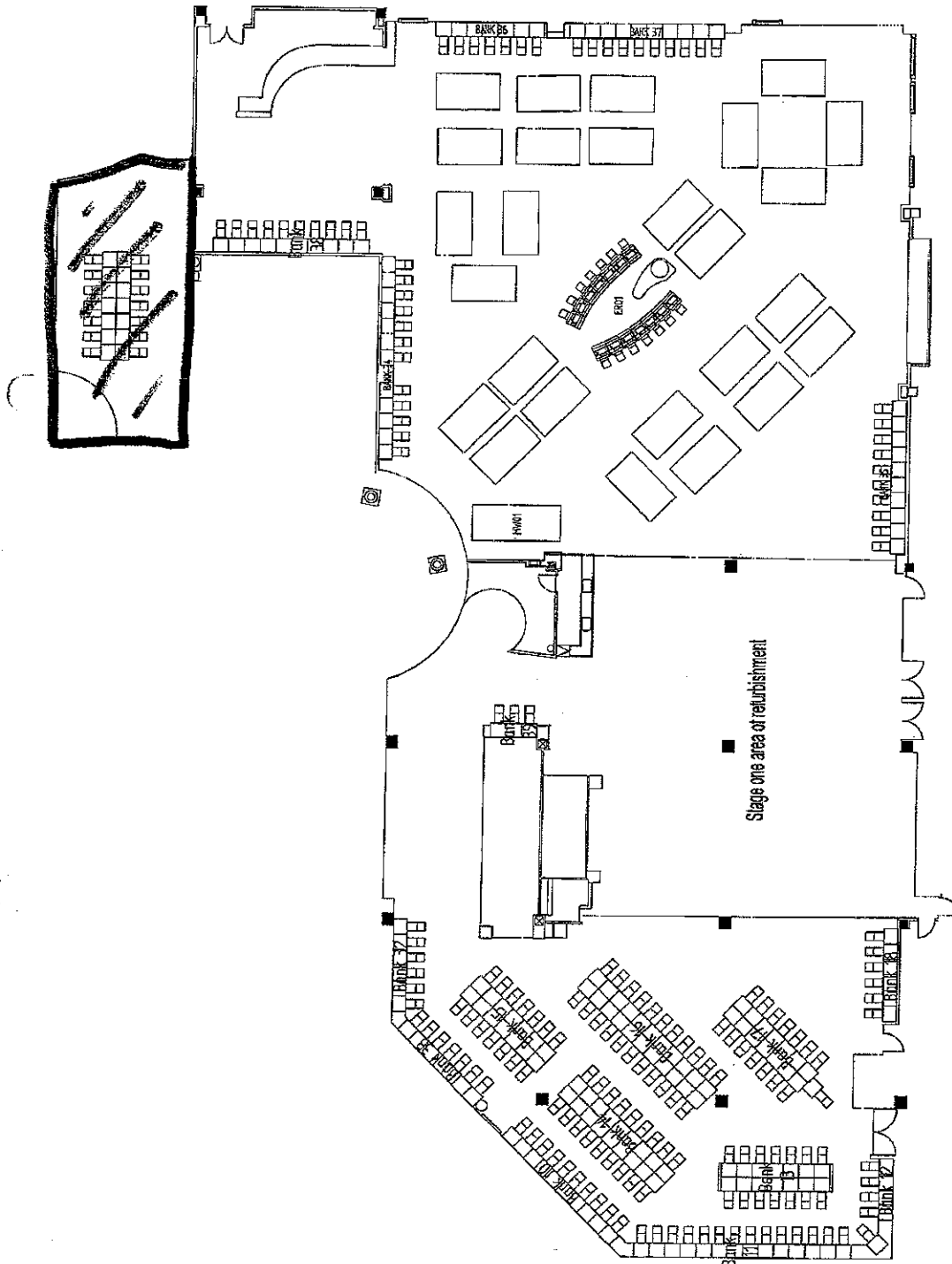

Christchurch Casinos Limited

Stuart Scott

LEVEL 3 - Transitional floor plan 2

UP TO 309 MACHINES, 28 TABLES

DATE: January 2010

SCALE 1:250

