

**DECISION UNDER DELEGATED AUTHORITY ON AN APPLICATION
BY SKYCITY AUCKLAND LIMITED FOR APPROVAL OF
CONSTRUCTION AND DESIGN CHANGES TO THE AUCKLAND CASINO**

Date of Decision: 17 November 2017

1. On 2 November 2017, SKYCITY Auckland Limited ("**SCAL**") applied, pursuant to conditions 6 and 7 of its venue licence, for approval of construction and design changes on level 2 of the casino.
2. Conditions 6 and 7 provide as follows:
 6. The Licence Holder must obtain the approval of the Commission prior to:
 - (a) construction or design changes to Levels 1, 2, 3, 5 and 6 of the casino venue, including the Gambling Area but excluding the SKYCITY Theatre and foyer area, restaurant and bar areas outside the Gambling Area, hotel rooms and the back of house areas used by staff (unless construction or design changes to any of these excluded areas may impact on matters set out in condition 7 in which case prior approval must be sought);
 - (b) the construction or relocation outside the Gambling Area and within the Casino Venue of bank facilities available to the public excluding ATMs, EFTPOS and like devices;
 - (c) the addition or alteration of signage relating to the casino business on any building, road or structure within the block of land bounded by Hobson Street, Wellesley Street West, Federal Street and Victoria Street West, including the Casino Venue, Sky Tower, car park, bus terminal and walkways between the casino and the Sky Tower and the convention centre.

The process by which the Licence Holder may obtain approval for construction or design changes to Levels 1, 2, 3, 5 and 6 of the casino venue, including the Gambling Area (paragraph (a) above) is set out in condition 7. The Commission will determine any application for approval under 6(b). The Executive Director may approve the addition or alteration of signage relating to the casino business on any building, road or structure within the casino block (paragraph (c) above) if he/she is satisfied the proposed changes will have no potentially adverse effects. If he/she is not so satisfied, the proposed changes must be referred to the Commission for a decision on approval.

7. The Licence Holder must notify the Executive Director of any proposed changes to the construction or design of Levels 1, 2, 3, 5 and 6 of the casino venue, including the Gambling Area but excluding SKYCITY Theatre and foyer area, restaurant and bar areas outside the Gambling Area, hotel rooms and the back of house areas used by staff. Notification must be accompanied by relevant drawings and an assessment of any impacts the alterations may have on:
 - (a) the integrity and fairness of games;
 - (b) the effectiveness of security and surveillance;
 - (c) harm prevention, harm minimisation and responsible gambling;
 - (d) potential access to the Gambling Area by persons under 20 years of age; and



- (e) compliance by any person with the Act, including section 11.

The Executive Director may approve the proposed changes to the construction or design if he or she is satisfied that there are no adverse impacts in relation to the matters specified in (a)-(e) above. If the Executive Director is not satisfied, he or she will refer the proposal to the Commission for determination.

Submissions

3. SCAL submitted as follows:
- (a) In decision GC17/17 the Commission varied the designated Gambling Area at the Casino to include an open area off the Rouge Room following a proposal from SCAL to deploy a small number of gaming machines in the area. In that application, it indicated that it may need to make some minor construction/design changes to the area in question before it could be used in gambling.
 - (b) There is no change to the design of the deck itself however minor construction is required for cabling to provide power and bases for the EGMs it wants to relocate to the area.
 - (c) The proposed changes will have no adverse impact on any of the matters set out in condition 7.

Decision

4. The Commission was satisfied that the proposal would not adversely impact upon any of the matters set out in condition 7. The construction and design changes proposed are approved by the Chief Gambling Commissioner and Executive Director under delegated authority pursuant to conditions 6 and 7 of SCAL's venue licence. The construction and design changes are to be generally in accordance with the application.

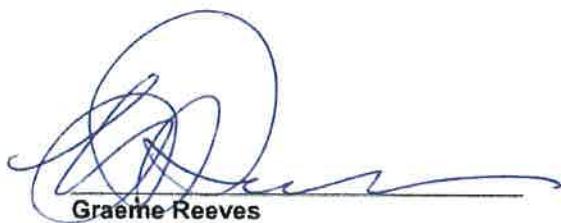

Graeme Reeves
Chief Gambling Commissioner
Gambling Commission

17 November 2017





Tim McIvor
Executive Director
Gambling Commission

NOTES:

1. DRAWING SHALL BE READ IN CONJUNCTION WITH ARCHITECTURAL SPECIFICATION AND DRAWINGS.
2. RUN ALL NEW TELECOMMUNICATION OUTLETS BACK TO GP2 COMMS ROOM.
3. PROVIDE CLASS E (CAT 6 UTP) SOLUTION FOR THE SECURITY CAMERA. TELECOMMUNICATION OUTLET SHALL BE LOCATED IN CEILING CAVITY AND BE PRESENTED WITH AMP NETCONNECT 1 PORT MODULAR JACK BOX.
4. TELECOMMUNICATIONS CABLEING TO THE GAMING MACHINES SHALL BE A CLASS E SOLUTION (CAT 6 UTP). THE SECOND CABLE SHALL BE A 25 PAIR CAT 6 BE LEFT UNTERMINATED WITHIN THE MACHINE BASE.
5. THE CAT 6 25 PAIR SHALL BE LEFT UNTERMINATED AT GP2 AND THE CAT 6 CABLES SHALL BE TERMINATED WITH RAK JACK PRESENTED ON THE NEXT AVAILABLE PATCH PANEL LOCATION FOR GAMING OR CCTV SERVICES. SUPPLY PATCH PANEL WHERE CURRENT CAPACITY IS NOT SUFFICIENT TO SUPPORT QUANTITY OF NEW CLASS E LINKS.
6. COMMS CONTRACTOR SHALL LAMBE WITH SKY CITY SURVEILLANCE TO PROVIDE CUT OUT FOR CCTV. ENSURE CCTV PATCH LEAD IS BOUGHT TO THE CAMERA CUT OUT READY FOR SKY CITY TO INSTALL.
7. SKY CITY SURVEILLANCE SHALL PROVIDE AND INSTALL CCTV CAMERA.
8. ELECTRICAL CONTRACTOR SHALL PROVIDE TRUNKING FOR COMMUNICATIONS CABLEING. COORDINATE CABLE DROP POINT WITH ELECTRICAL TRADE.

LEGEND:

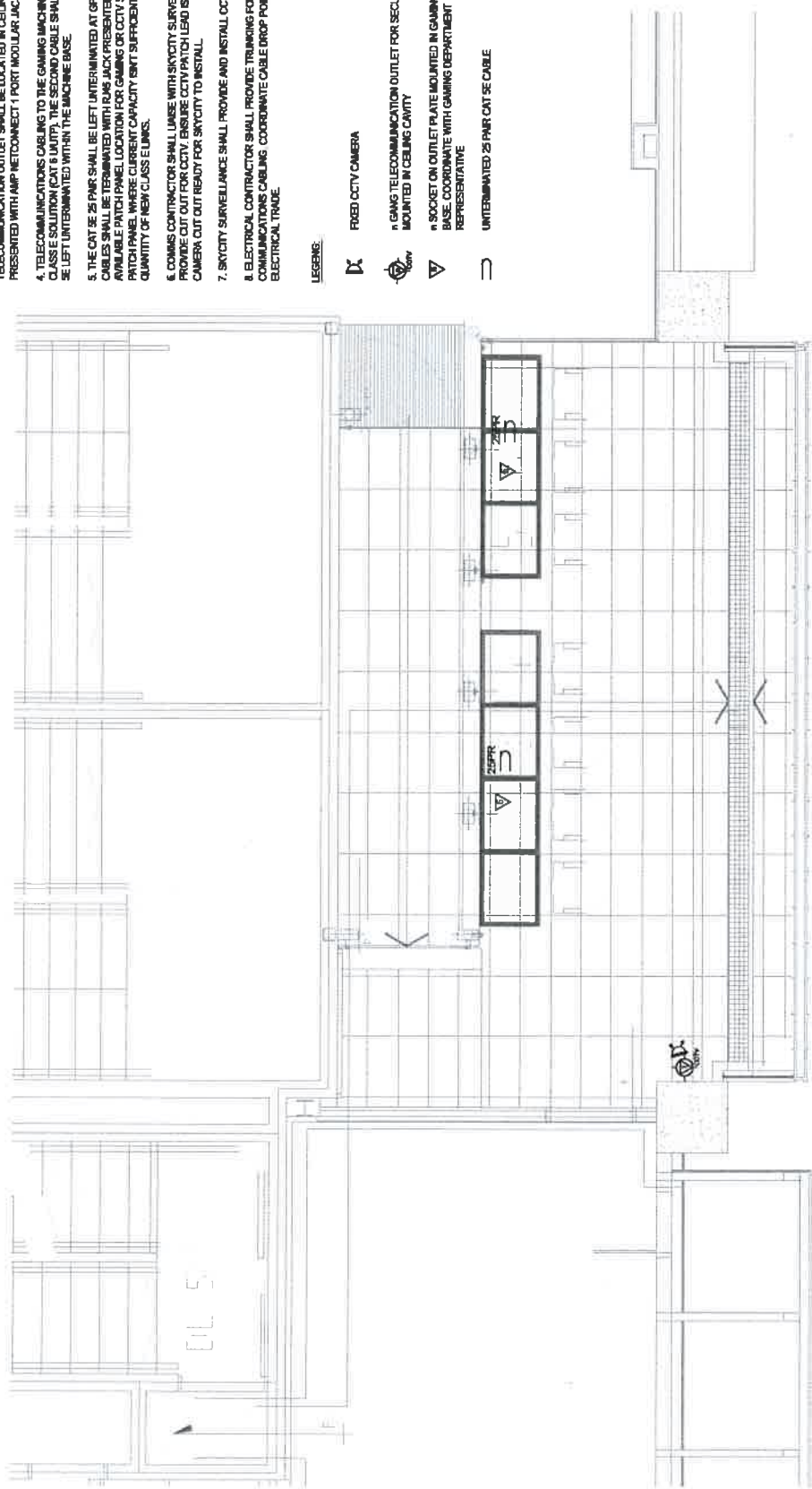
- ☒ FIXED CCTV CAMERA
- ☒ GANG TELECOMMUNICATION OUTLET FOR SECURITY CAMERA MOUNTED IN CEILING CAVITY
- ☒ SOCKET ON OUTLET PLATE MOUNTED IN GAMING MACHINE BASE. COORDINATE WITH GAMING DEPARTMENT REPRESENTATIVE
- ☐ UNTERMINATED 25 PAIR CAT 6 CABLE



FOR TENDER / CONSTRUCTION

				COMMS & SECURITY SERVICES COMMUNICATIONS & SECURITY LAYOUT 519186-300-BC-001	
COMMUNICATIONS & SECURITY LAYOUT		ROUSE DESIGNS		COMMUNICATIONS & SECURITY SERVICES COMMUNICATIONS & SECURITY LAYOUT 519186-300-BC-001	

