

**DECISION UNDER DELEGATED AUTHORITY ON AN APPLICATION
BY CHRISTCHURCH CASINOS LIMITED FOR APPROVAL OF
A NEW FLOOR PLAN FOR LEVEL 4 OF THE CHRISTCHURCH CASINO**

Date of Decision: ^{24th} March 2016

1. On 22 March 2016, Christchurch Casinos Limited ("CCL") applied, pursuant to condition 12 of its operator's licence, for approval of a new floor plan, "April 2016", for level 4 of the Christchurch casino.

2. Condition 12 provides as follows:

The Licence Holder shall obtain the approval of the Commission for new floor plans prior to relocating or installing tables or machines in positions not specified in approved floor layouts. When applying the Licence Holder must submit fresh plans showing the floor layout for the Gambling Area and details of the proposed CCTV layout for the consideration of the Commission. Any change must comply with the Surveillance Standard. The Executive Director and a single Gambling Commissioner may approve the new floor plans if they are satisfied that the floor layout has no potentially adverse effects. If they are not so satisfied, the proposed floor plan must be referred to the Commission for a decision on approval.

3. CCL submitted that wants to remove an oversized gaming machine (called "Big Bertha") and one standard electronic gaming machine ("EGM") and return two EGMs back on to level 4. The total number of EGMs will remain unchanged at 205.

4. The proposal raises no issues of regulatory concern for the Commission. Accordingly a new plan for level 4, April 2016 (**attached**), is approved by the Chief Gambling Commissioner and the Executive Director under delegated authority pursuant to condition 12 of CCL's operator's licence for the Christchurch casino. For ease of reference, the floor plan for level 3 is also **attached**.

5. Once CCL is reliant on plan April 2016, plan August 2015 will cease to be valid.



Graeme Reeves
Chief Gambling Commissioner
Gambling Commission

^{24th} March 2016

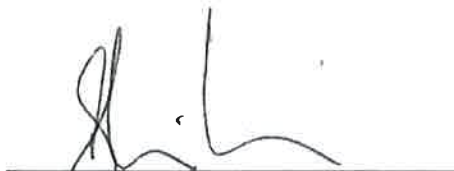

Blair Cairncross
Executive Director
Gambling Commission

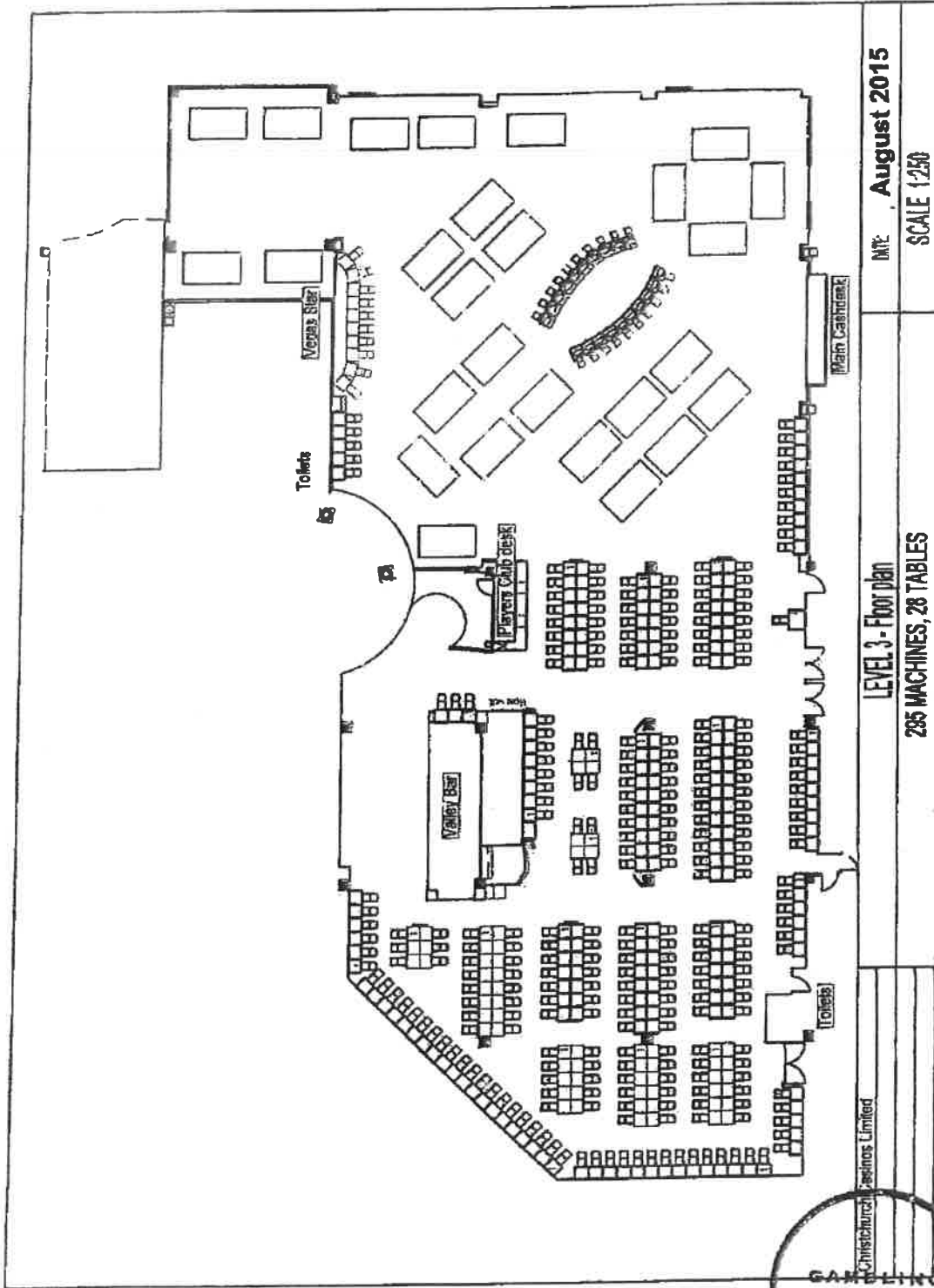

MTZ August 2015

SCALE 1:250

LEVEL 3 - Floor Plan

235 MACHINES, 28 TABLES

Christchurch Casinos Limited

GAMBLING COMMISSION

[Handwritten signature]

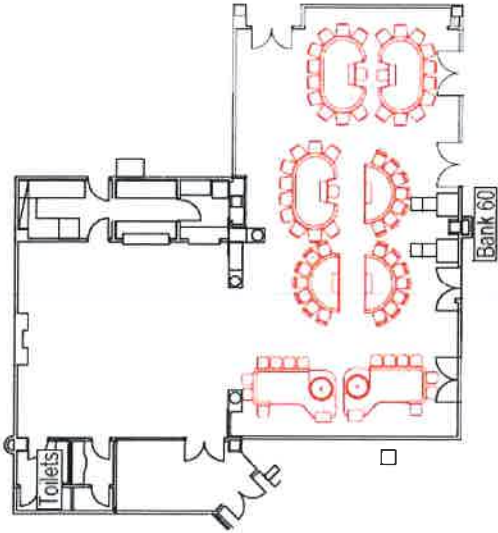
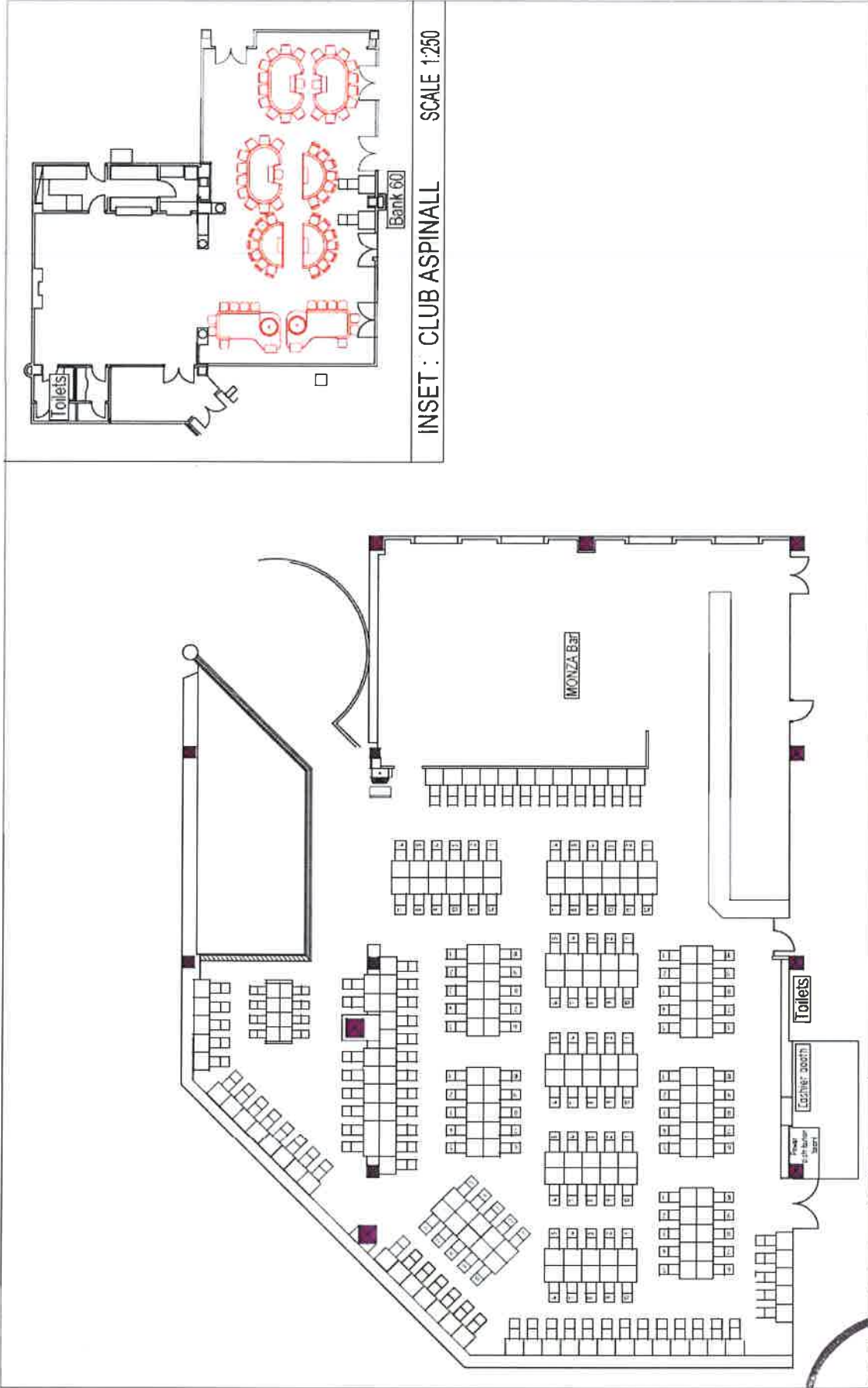

INSET : CLUB ASPINALL SCALE 1:250

Christchurch Casinos Limited
 Stuart Scott

LEVEL 4 - Gallery floor plan
 205 MACHINES - 8 Tables

DATE: April 2016
 SCALE 1:250

