

**DECISION UNDER DELEGATED AUTHORITY ON AN APPLICATION  
BY SKYCITY CASINO MANAGEMENT LIMITED FOR APPROVAL OF  
NEW FLOOR PLANS FOR THE AUCKLAND CASINO**

Date of Decision:  February 2016

1. On 24 February 2016, SKYCITY Casino Management Limited ("SCML") applied, pursuant to condition 11 of its operator's licence for the Auckland casino, for approval of three new floor plans: 2016 L2 001, 2016 L3 001 and 2016 L3 002.
2. Condition 11 provides as follows:
  11. The Licence Holder shall operate in accordance with approved floor layouts showing the position of gaming tables and gaming machines. The Licence Holder shall obtain approval for new floor plans prior to relocating or installing tables or machines in positions not specified in approved floor layouts. When applying, the Licence Holder must submit fresh plans showing the floor layout for the Gambling Area and details of the proposed CCTV layout for consideration. Any change must comply with the Surveillance Standard. The Executive Director and a single Gambling Commissioner may approve the new floor plans if they are satisfied that the floor layout has no potentially adverse effects. If they are not so satisfied, the proposed floor plan must be referred to the Commission for a decision on approval.
3. SCML submitted as follows:
  - (a) It wants to relocate the Rapid Baccarat game from level 3 to level 2 and reduce the number of terminals on this game from 30 to 20. To accommodate the placement of the new game, it also wants to reduce the number of Rapid Roulette terminals on level 2 by two.
  - (b) Following the relocation of Rapid Baccarat to level 2, it wants to install two substitute tables in the space created on level 3.
  - (c) It wants to reduce six tables to four on level 3, and change the status of the two substitute tables so that they become active tables.
4. The proposal raised no issues of regulatory concern for the Commission. Accordingly new plans 2016 L2 001, 2016 L3 001 and 2016 L3 002 (**attached**) are approved by the Chief Gambling Commissioner and the Executive Director under delegated authority pursuant to condition 11 of SCML's operator's licence for the Auckland casino.
5. Once SCML is reliant on plan 2016 L2 001, plan NZICC Level 2 Stage 2 will cease to be valid.



6. Once SCML is reliant on plan 2016 L3 001, plan NZICC Level 3 Stage 2 will cease to be valid.

7. Once SCML is reliant on plan 2016 L3 002, plan 2016 L3 001 will cease to be valid.



**Graeme Reeves**  
Chief Gambling Commissioner  
Gambling Commission



**Blair Cairncross**  
Executive Director  
Gambling Commission

26 February 2016



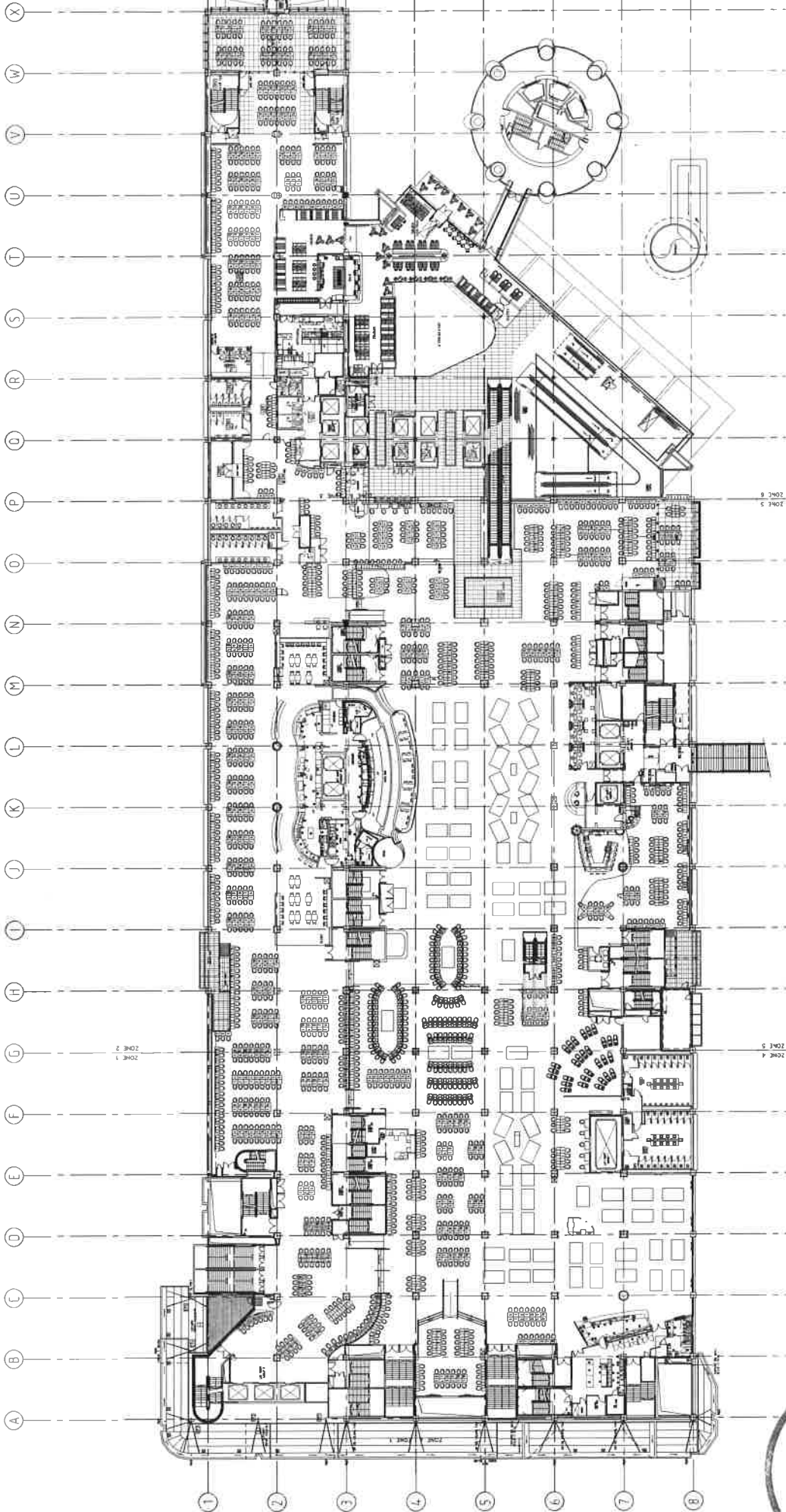

**GAMBLING COMMISSION**

**moller.** Moller Architects

**SKYCITY ENTERTAINMENT GROUP**  
Gaming Layouts

Sky City Entertainment Group  
1500 Kona Mall  
Honolulu, HI 96813  
www.skycityentertainment.com

SECRET AND PRIVATE

Call: 849-457-0466  
Fax: 849-457-0466  
www.mollerarchitects.com

DRAWING TITLE		DATE	
Level 2 Gaming Layout	11/11/2015	By: CHS	Draw: CHS
SKYCITY	11/11/2015	By: CHS	Draw: CHS
Delta Machines Removal	11/11/2015	By: CHS	Draw: CHS
21 OCT 2015	11/11/2015	By: CHS	Draw: CHS

5132C A1202

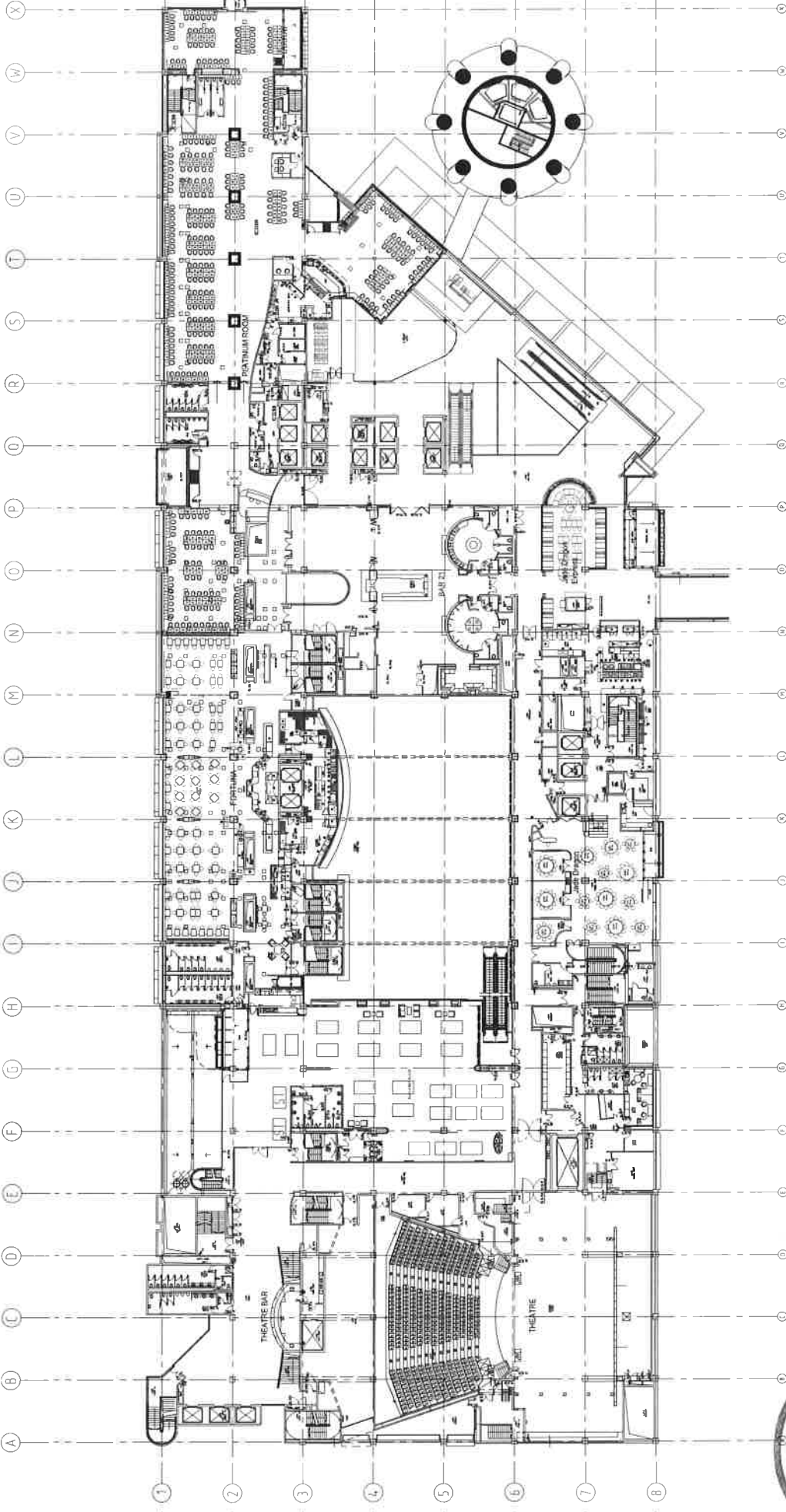

**MOller Architects**  
 1001 West 13th Street  
 Suite 200  
 Anchorage, Alaska 99501  
 www.mollerarchitects.com

**Sky City Entertainment Group**  
 Gaming Layouts

**SKY CITY ENTERTAINMENT GROUP**

**Level 3 Gaming Layout**  
**SKY CITY**  
 Delta Machines Displacement  
 21 Oct 2015

5132C A1205 A

**REVISIONS**

No.	Description	By	Date
1	Initial	...	11/10/15
2	...	...	...

**DRAWING INFORMATION**

Sheet: A1205  
 Project: SKY CITY  
 Title: Level 3 Gaming Layout  
 Date: 11/10/15

**CLIENT AND PROJECT**

Client: Sky City Entertainment Group  
 Project: Level 3 Gaming Layout

**NOTES**

\* Refer to Revision 1 for Original Signatures  
 \* All Contractors shall verify all dimensions before commencing work  
 \* All dimensions are in feet and inches unless otherwise noted  
 \* Copyright © Moller Architects Limited

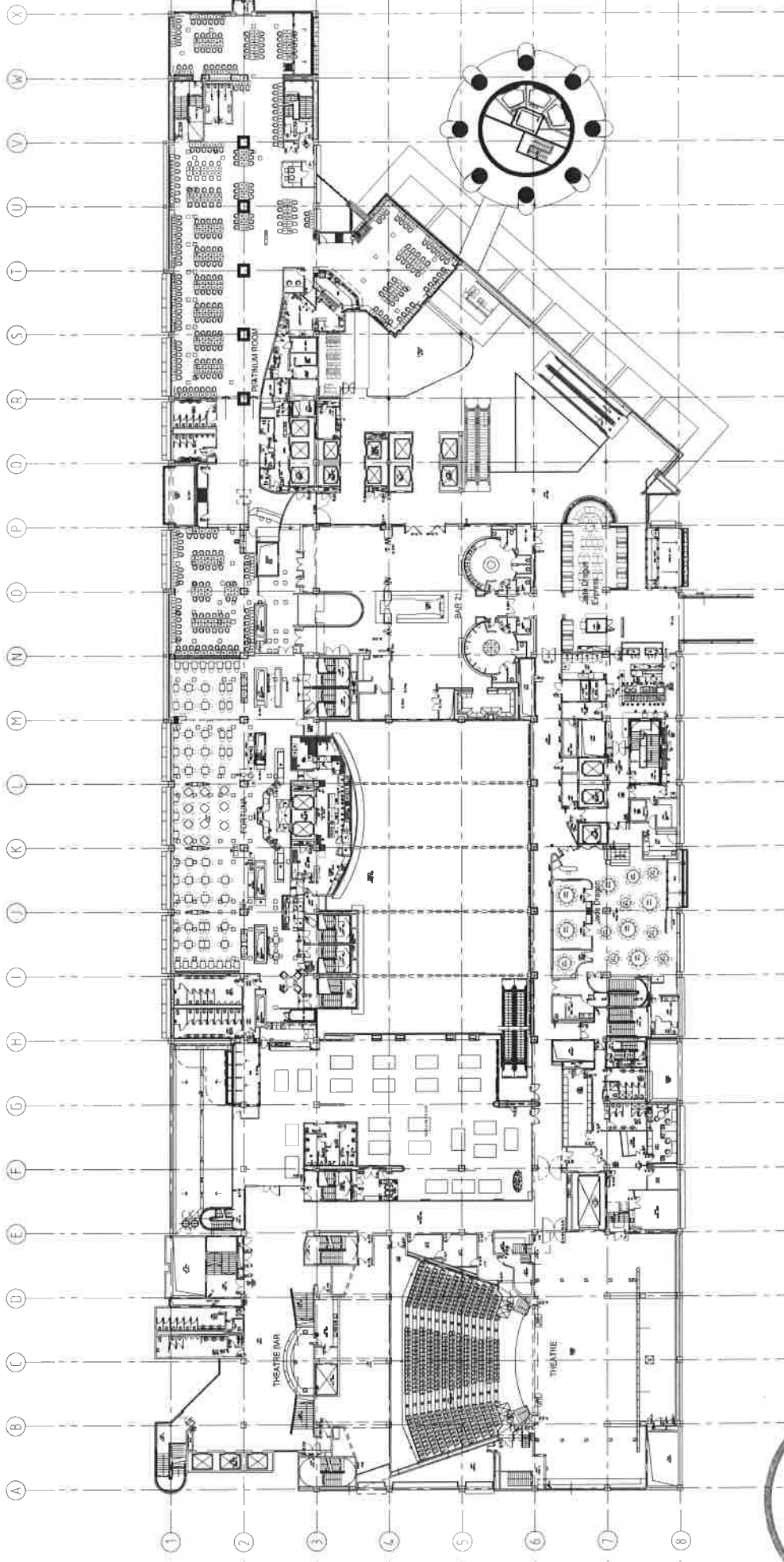

**CLIENT AND PROJECT**

Call+64 9 3570663  
 Fax+64 9 3570663  
 Level 13 West Plaza  
 100 Albert Street  
 Auckland, New Zealand  
 www.mollerarchitects.com

**SKY CITY ENTERTAINMENT GROUP**

Sky City Entertainment Group  
 Gaming Layouts

**DESIGNED AND DRAWN BY**

Design: Moller Architects (NZ) Ltd  
 Drawn: ABB  
 Date: 15/10/15  
 Scale: 1:100  
 Date: 15/10/15  
 Scale: 1:100

**REVISIONS**

No.	Description	By	Check	Date
1	Issue for Construction	ABB	ABB	15/10/15
2	Issue for Construction	ABB	ABB	15/10/15
3	Issue for Construction	ABB	ABB	15/10/15
4	Issue for Construction	ABB	ABB	15/10/15
5	Issue for Construction	ABB	ABB	15/10/15
6	Issue for Construction	ABB	ABB	15/10/15
7	Issue for Construction	ABB	ABB	15/10/15
8	Issue for Construction	ABB	ABB	15/10/15
9	Issue for Construction	ABB	ABB	15/10/15
10	Issue for Construction	ABB	ABB	15/10/15
11	Issue for Construction	ABB	ABB	15/10/15
12	Issue for Construction	ABB	ABB	15/10/15
13	Issue for Construction	ABB	ABB	15/10/15
14	Issue for Construction	ABB	ABB	15/10/15
15	Issue for Construction	ABB	ABB	15/10/15
16	Issue for Construction	ABB	ABB	15/10/15
17	Issue for Construction	ABB	ABB	15/10/15
18	Issue for Construction	ABB	ABB	15/10/15
19	Issue for Construction	ABB	ABB	15/10/15
20	Issue for Construction	ABB	ABB	15/10/15

**DETAILED TITLE**

Level 3 Gaming Layout  
 SKY CITY  
 Delta Machines Displacement  
 21 Oct 2015

5132C | A1205 | A

**NOTES**

\* Refer to Revision 1 for Original Signatures  
 Main Contractor may verify all dimensions before commencing work  
 All dimensions are in millimeters unless otherwise stated  
 Copyright © Moller Architects Limited

Scale: 1:100

Plot Date: 15/10/15