

**DECISION UNDER DELEGATED AUTHORITY ON AN  
APPLICATION BY SKYCITY CASINO MANAGEMENT LIMITED FOR APPROVAL OF NEW  
FLOOR PLANS, AND BY SKYCITY AUCKLAND LIMITED FOR APPROVAL OF  
CONSTRUCTION AND DESIGN CHANGES FOR THE AUCKLAND CASINO**

**Date of Decision: 19 March 2025**

1. On 12 March 2025, SkyCity Casino Management Limited (“**SCML**”) applied, pursuant to condition 11 of its operator’s licence for the Auckland casino, for approval of nine new floor plans, “2025 L5 TEMP A”, “2025 L5 TEMP B”, “2025 L5 001”, “2025 L3 TEMP A”, “2025 L3 TEMP B”, “2025 L3 001”, “2025 L2 TEMP A”, “2025 L2 TEMP B”, and “2025 L2 001”; and SkyCity Auckland Limited (“**SCAL**”) applied, pursuant to conditions 6 and 7 of its venue licence, for approval of construction and design changes at the Auckland casino. The approvals are sought as part of SkyCity’s rollout of Account Based Play (“**ABP**”) at the Auckland casino. Zones will be created in some table game areas.
2. Condition 11 of SCML’s operator’s licence for the Auckland casino provides as follows:
  11. The Licence Holder shall operate in accordance with approved floor layouts showing the position of gaming tables and gaming machines. The Licence Holder shall obtain approval for new floor plans prior to relocating or installing tables or machines in positions not specified in approved floor layouts. When applying, the Licence Holder must submit fresh plans showing the floor layout for the Gambling Area and details of the proposed CCTV layout for consideration. Any change must comply with the Surveillance Standard. The Executive Director and a single Gambling Commissioner may approve the new floor plans if they are satisfied that the floor layout has no potentially adverse effects. If they are not so satisfied, the proposed floor plan must be referred to the Commission for a decision on approval.
3. Conditions 6 and 7 of SCAL’s venue licence provide as follows:
  6. The Licence Holder must obtain the approval of the Commission prior to:
    - (a) construction or design changes to Levels 1, 2, 3, 5 and 6 of the casino venue, including the Gambling Area but excluding the SKYCITY Theatre and foyer area, restaurant and bar areas outside the Gambling Area, hotel rooms and the back of house areas used by staff (unless construction or design changes to any of these excluded areas may impact on matters set out in condition 7 in which case prior approval must be sought);
    - (b) the construction or relocation outside the Gambling Area and within the Casino Venue of bank facilities available to the public excluding ATMs, EFTPOS and like devices;
    - (c) the addition or alteration of signage relating to the casino business on any building, road or structure within the block of land bounded by Hobson Street, Wellesley Street West, Federal Street and Victoria Street West, including the Casino Venue, Sky Tower, car park, bus terminal and walkways between the casino and the Sky Tower and the convention centre.

The process by which the Licence Holder may obtain approval for construction or design changes to Levels 1, 2, 3, 5 and 6 of the casino venue, including the Gambling Area (paragraph (a) above) is set out in condition 7. The Commission will determine any application for approval under 6(b). The

Executive Director may approve the addition or alteration of signage relating to the casino business on any building, road or structure within the casino block (paragraph (c) above) if he/she is satisfied the proposed changes will have no potentially adverse effects. If he/she is not so satisfied, the proposed changes must be referred to the Commission for a decision on approval.

The Licence Holder must notify the Executive Director of any proposed changes to the construction or design of Levels 1, 2, 3, 5 and 6 of the casino venue, including the Gambling Area but excluding SKYCITY Theatre and foyer area, restaurant and bar areas outside the Gambling Area, hotel rooms and the back of house areas used by staff. Notification must be accompanied by relevant drawings and an assessment of any impacts the alterations may have on:

- (a) the integrity and fairness of games;
- (b) the effectiveness of security and surveillance;
- (c) harm prevention, harm minimisation and responsible gambling;
- (d) potential access to the Gambling Area by persons under 20 years of age; and
- (e) compliance by any person with the Act, including section 11.

The Executive Director may approve the proposed changes to the construction or design if he or she is satisfied that there are no adverse impacts in relation to the matters specified in (a)-(e) above. If the Executive Director is not satisfied, he or she will refer the proposal to the Commission for determination.

#### *Submissions*

4. SCAL wants to create Zones at the Auckland casino as it works towards introducing ABP. SCAL submitted as follows:

#### *Level 2*

- (a) It wants to install two fixed 1.1m high glass balustrades, with a top rail and steel posts. These will create a monitored entranceway to the gaming tables area which will be sectioned off.

#### *Level 3*

- (b) It wants to install fixed 1.1m high glass balustrades, with a top rail and steel posts in the Baccarat Room. These will create a monitored entranceway to the gaming tables in that area which will be sectioned off.
- (c) Where there are breaks in the balustrades, they will be filled with planter tables/boxes, and a bar leaner will be installed at the balcony end of the Baccarat Room.
- (d) It wants to remove a section of the partition/cabinet wall at the entrance to the Baccarat Room (at the top of the escalators) and install a host desk.

*Level 5*

- (e) It wants to install two fixed 1.1m high glass balustrades, with a top rail and steel posts in the VIP area. These will create a monitored entrance way to selected gaming tables area which will be monitored by the host.

The proposed construction and design changes will have no adverse impact on the matters specified in condition 7.

5. SCML submitted as follows:

- (a) It wants to make changes to the placing of gaming product on levels 2, 3 and 5. If approved, the changes are intended to be completed by June 2025.
- (b) There are a number of phases to each of the plans, as follows:

*Level 5*

<b>Plan</b>	<b>Summary of changes</b>	<b>Estimated date of implementation</b>
2025 L5 TEMP A	Relocate 6 tables within the same area	31/3/25 – 6/4/25
2025 L5 TEMP B	<ul style="list-style-type: none"> <li>- Remove 1 table</li> <li>- Install 2 tables</li> <li>- Reconfigure layout</li> </ul>	7/4/25 – 14/4/25
2025 L5 001	<ul style="list-style-type: none"> <li>- Remove 1 table</li> <li>- Plan updated to show location of glass balustrades, once completed.</li> </ul>	Final plan from 14/4/25

*Level 3*

<b>Plan</b>	<b>Summary of changes</b>	<b>Estimated date of implementation</b>
2025 L3 TEMP A	<ul style="list-style-type: none"> <li>- Remove 1 table</li> <li>- Reconfigure layout</li> </ul>	22/4/25 – 27/4/25
2025 L5 TEMP B	<ul style="list-style-type: none"> <li>- Remove 13 ATG terminals</li> <li>- Install 2 tables</li> <li>- Remove 1 table</li> <li>- Relocate 2 tables</li> <li>- Install 10 ATG terminals</li> </ul>	28/4/25 – 25/5/25
2025 L3 001	<ul style="list-style-type: none"> <li>- Remove 1 table</li> <li>- Plan updated to show location of glass balustrades, once completed.</li> </ul>	Final plan from 26/5/25

*Level 2*

Plan	Summary of changes	Estimated date of implementation
2025 L2 TEMP A	- Remove 1 table - Reconfigure layout	12/5/25 – 18/6/25
2025 L2 TEMP B	- Remove 1 table - Reconfigure layout	19/5/25 – 1/6/25
2025 L2 001	- Remove 2 tables - Plan updated to show location of glass balustrades, once completed.	Final plan from 2/6/25

- (c) At all times, the number of EGMs and gaming tables (including Substitute Tables) will comply with the requirements of its licence conditions. Similarly the mix of games will comply with approved game mixes.
- (d) Changes to the CCTV layout will be implemented to ensure compliance with the Surveillance Standard.
6. The Secretary had no regulatory concerns in relation to the changes proposed by SCML and SCAL.

*Decision*

7. The Commission was satisfied that the proposed construction and design changes would not adversely impact any of the matters set out in condition 7. The construction and design changes are approved by the Executive Director under delegated authority pursuant to conditions 6 and 7 of SCAL's venue licence.
8. The Commission was satisfied that the proposed floor plans raised no issues of regulatory concern. Accordingly, plans "2025 L5 TEMP A", "2025 L5 TEMP B", "2025 L5 001", "2025 L3 TEMP A", "2025 L3 TEMP B", "2025 L3 001", "2025 L2 TEMP A", "2025 L2 TEMP B", and "2025 L2 001" (**attached**) are approved by the Chief Gambling Commissioner and the Executive Director under delegated authority, pursuant to condition 11 of SCML's operator's licence, for the Auckland casino.
9. Once SCML is reliant on plan "2025 L5 TEMP A", plan "2024 L5 002" will cease to be valid.
10. Once SCML is reliant on plan "2025 L5 TEMP B", plan "2025 L5 TEMP A" will cease to be valid.
11. Once SCML is reliant on plan "2025 L5 001", plan "2025 L5 TEMP B" will cease to be valid.
12. Once SCML is reliant on plan "2025 L3 TEMP A", plan "2024 L3 003" will cease to be valid.

13. Once SCML is reliant on plan "2025 L3 TEMP B", plan "2025 L3 TEMP A" will cease to be valid.
14. Once SCML is reliant on plan "2025 L3 001", plan "2025 L3 TEMP B" will cease to be valid.
15. Once SCML is reliant on plan "2025 L2 TEMP A", plan "2024 L2 004 " will cease to be valid.
16. Once SCML is reliant on plan "2025 L2 TEMP B", plan "2025 L2 TEMP A" will cease to be valid.
17. Once SCML is reliant on plan "2025 L2 001", plan "2025 L2 TEMP B " will cease to be valid.



---

**Susan Hughes**  
Chief Gambling Commissioner  
Gambling Commission



---

**Blair Cairncross**  
Executive Director  
Gambling Commission

19 March 2025



2025 L2 TEMP A

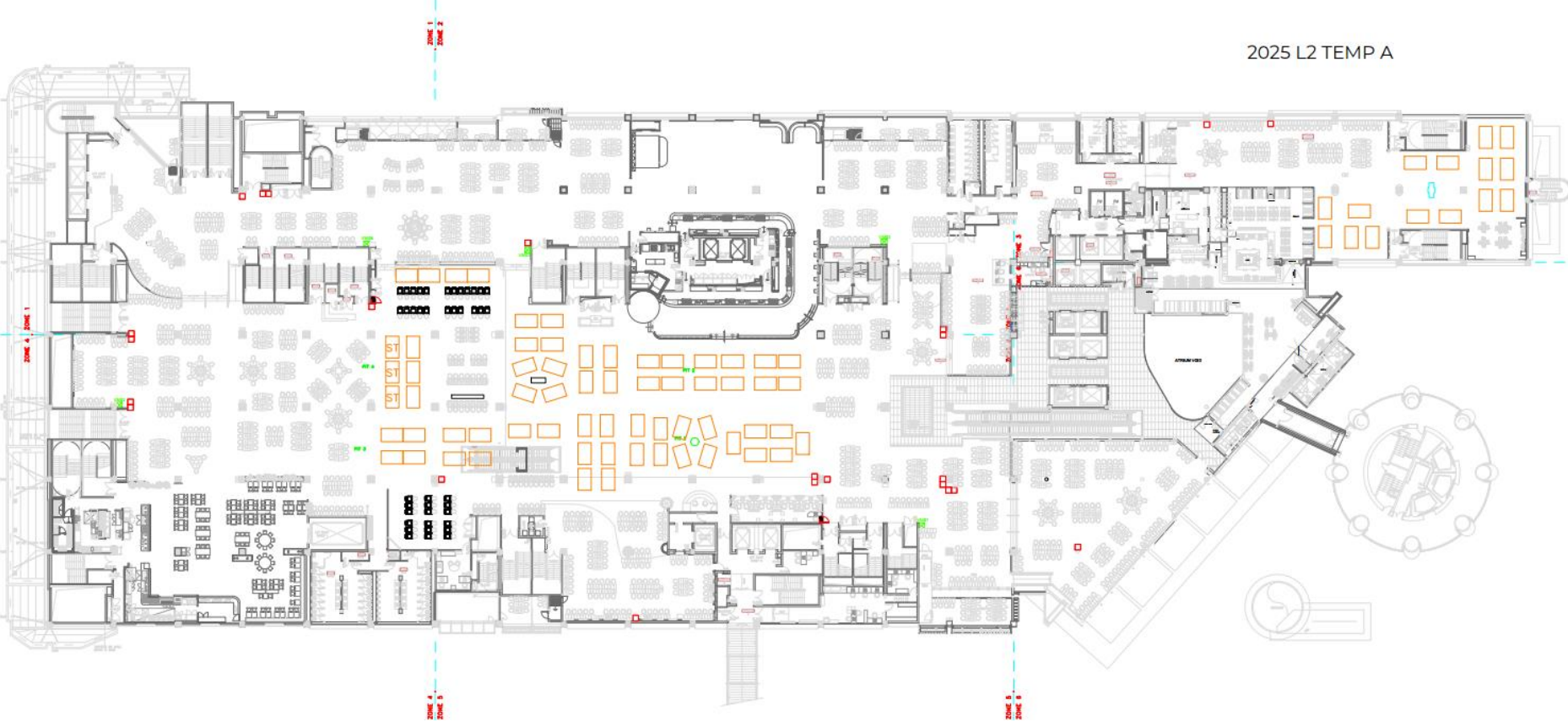

2025 L2 TEMP B

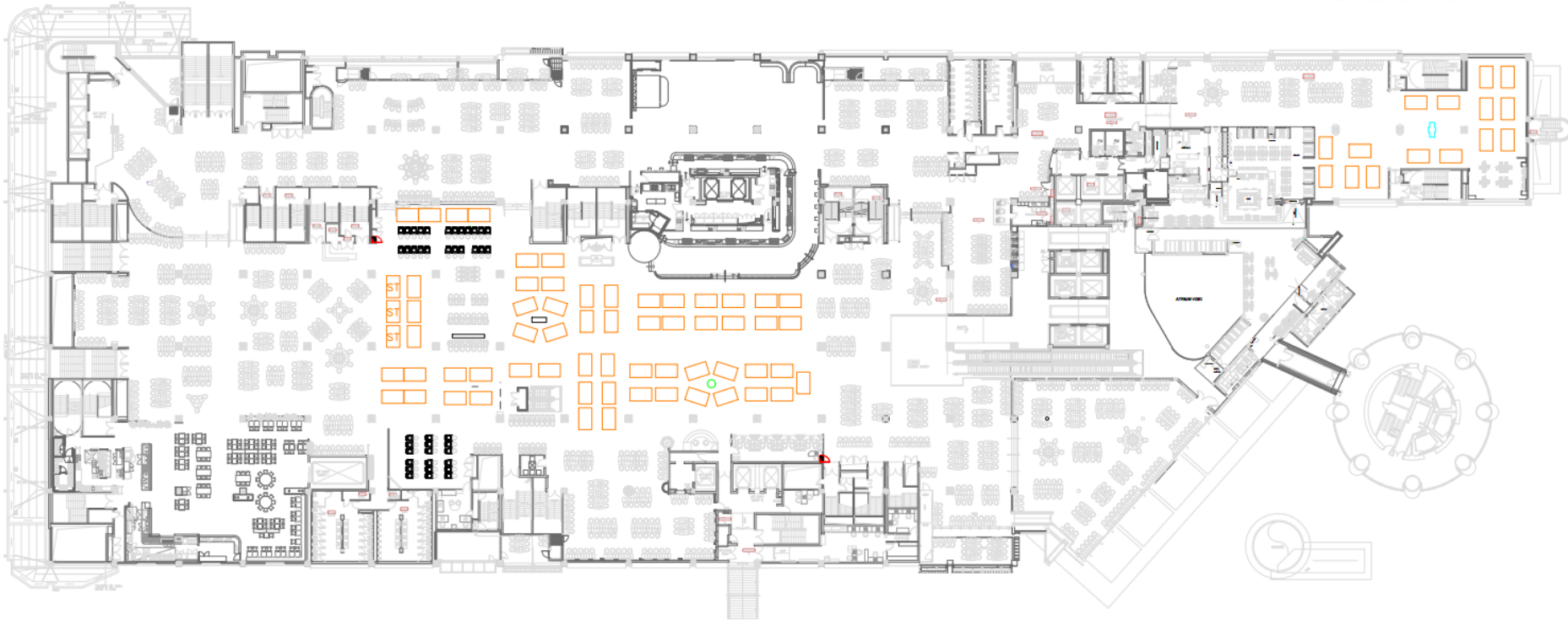

2025 L2 001

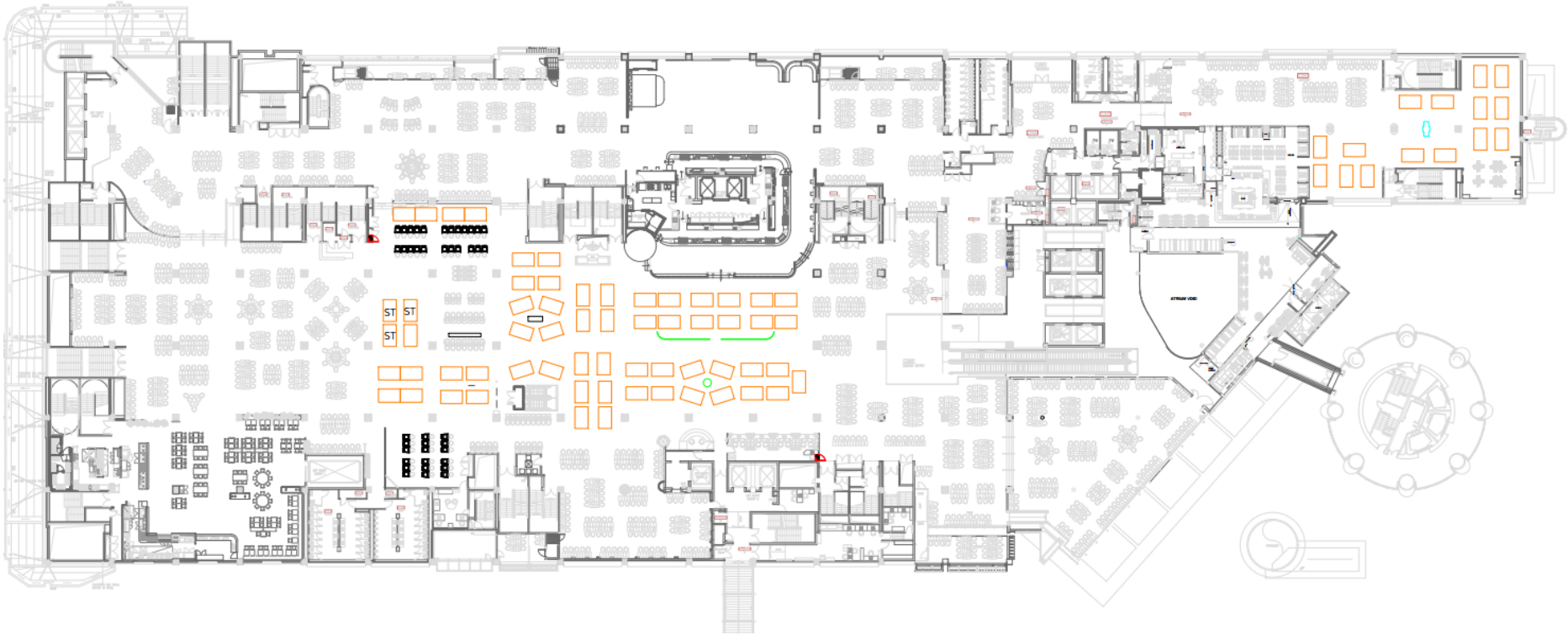

2025 L5 TEMP A

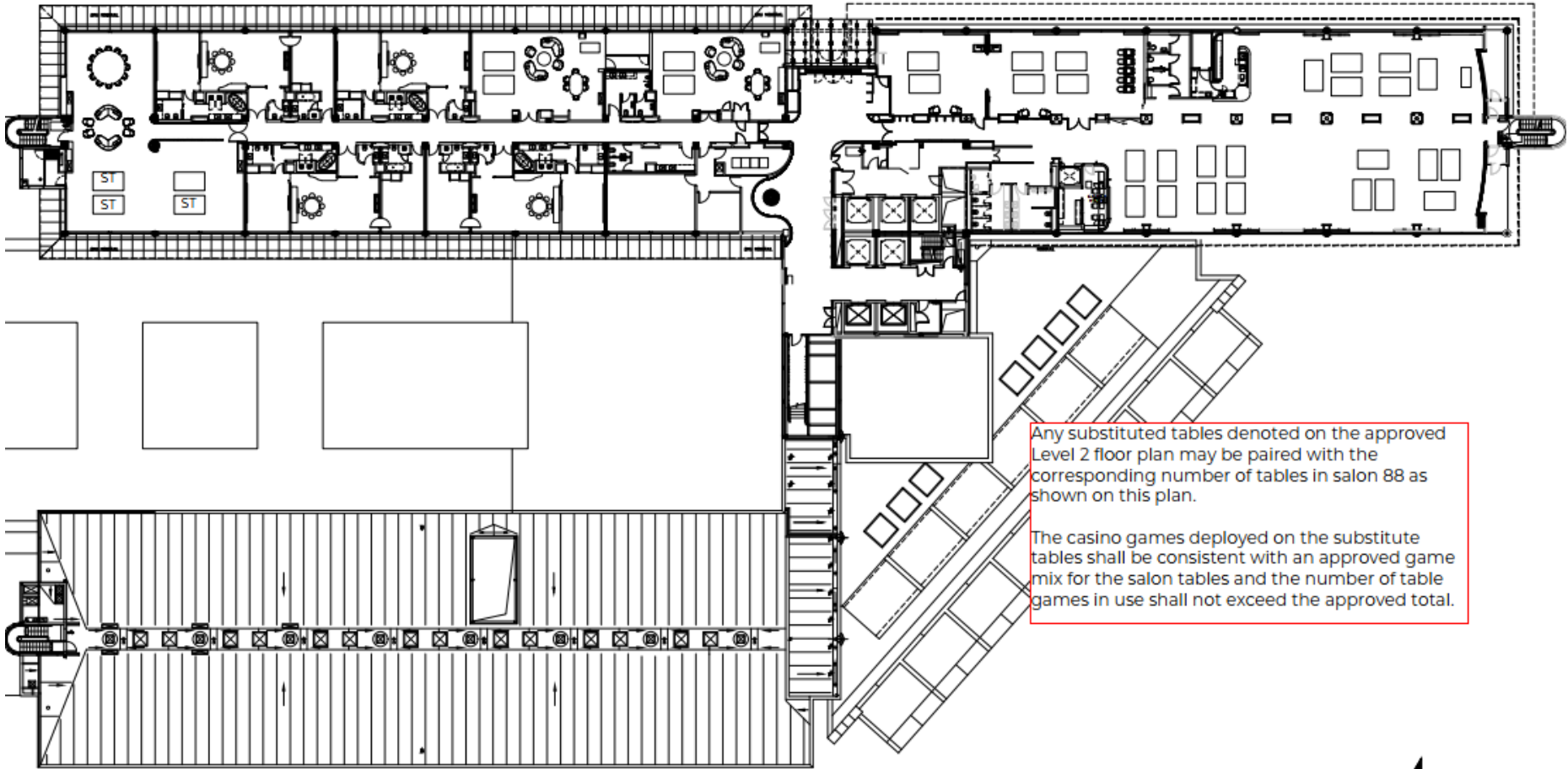

Any substituted tables denoted on the approved Level 2 floor plan may be paired with the corresponding number of tables in salon 88 as shown on this plan.

The casino games deployed on the substitute tables shall be consistent with an approved game mix for the salon tables and the number of table games in use shall not exceed the approved total.

2025 L5 TEMP B

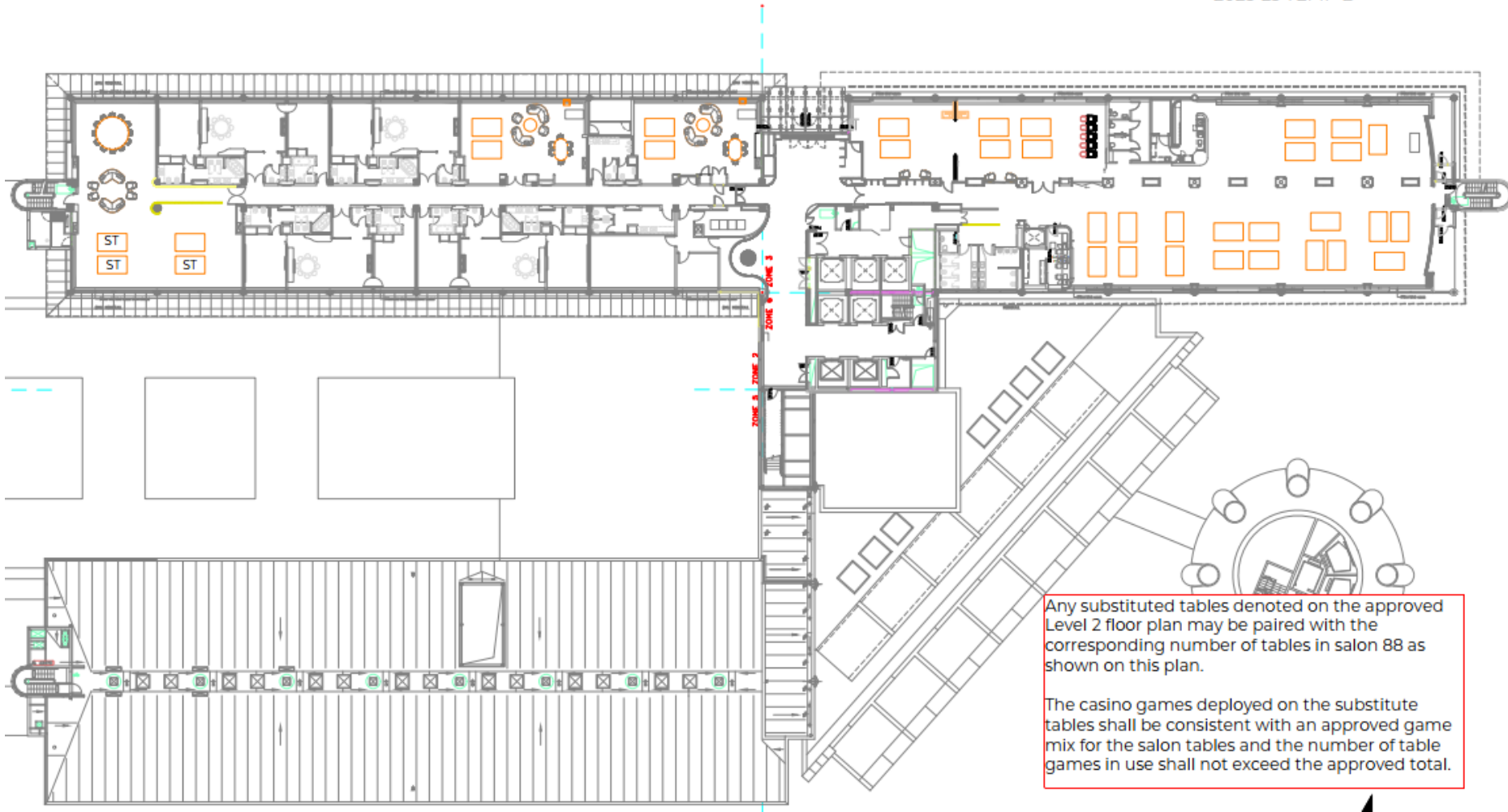

Any substituted tables denoted on the approved Level 2 floor plan may be paired with the corresponding number of tables in salon 88 as shown on this plan.

The casino games deployed on the substitute tables shall be consistent with an approved game mix for the salon tables and the number of table games in use shall not exceed the approved total.

# 2025 L5 001

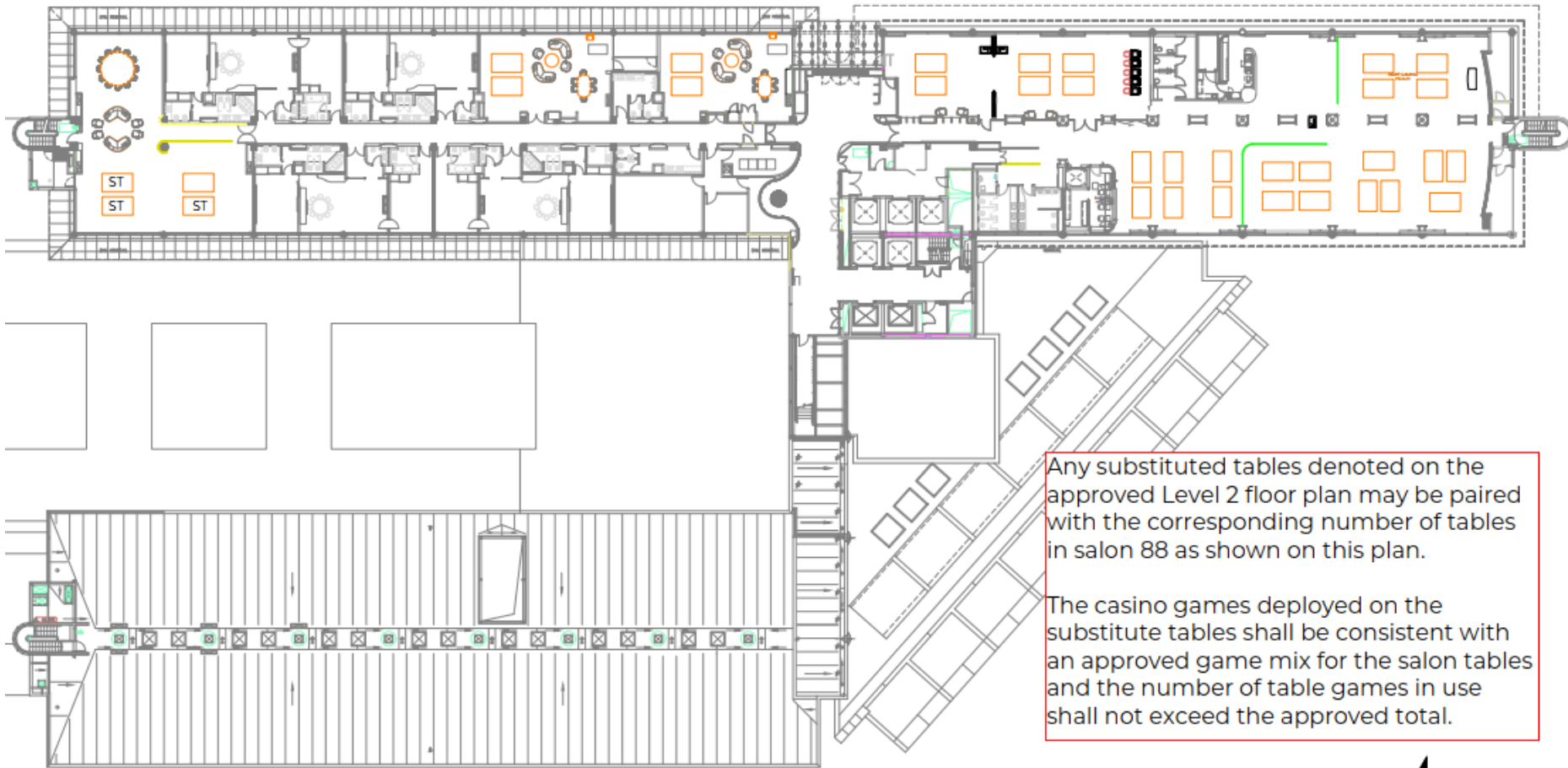

Any substituted tables denoted on the approved Level 2 floor plan may be paired with the corresponding number of tables in salon 88 as shown on this plan.

The casino games deployed on the substitute tables shall be consistent with an approved game mix for the salon tables and the number of table games in use shall not exceed the approved total.

2025 L3 TEMP A

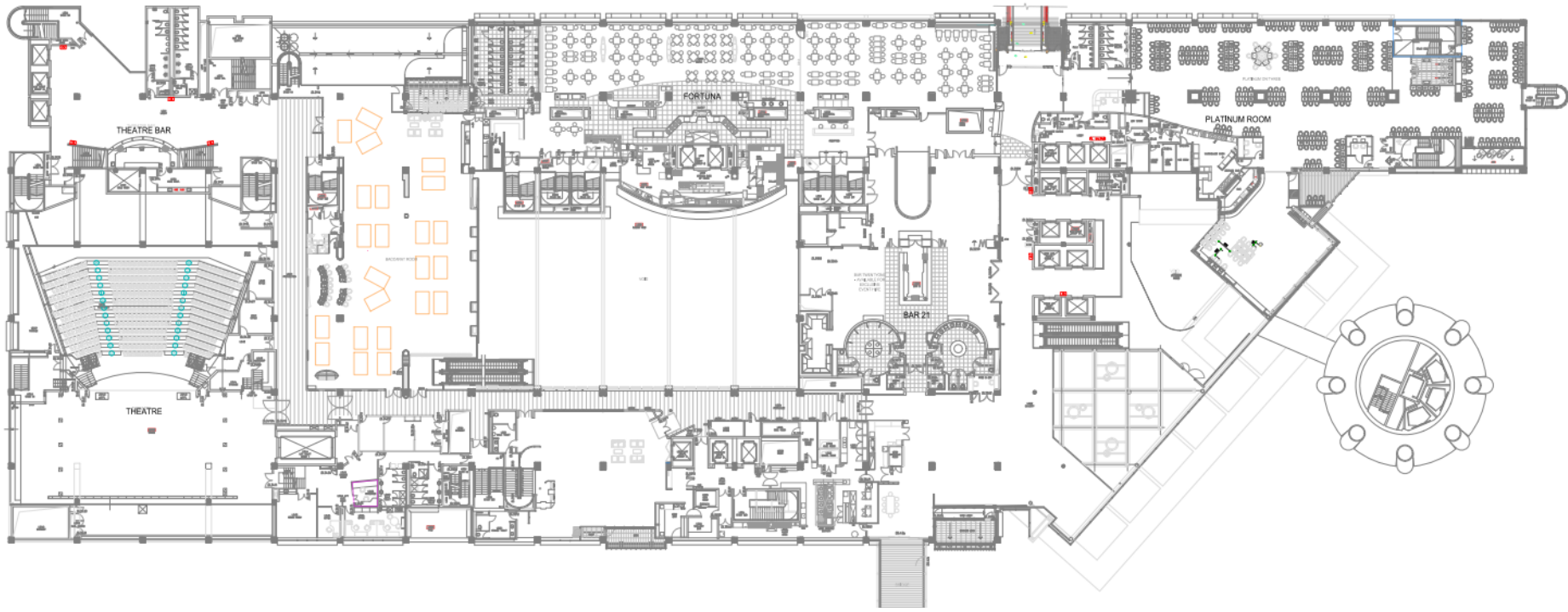

2025 L3 TEMP B

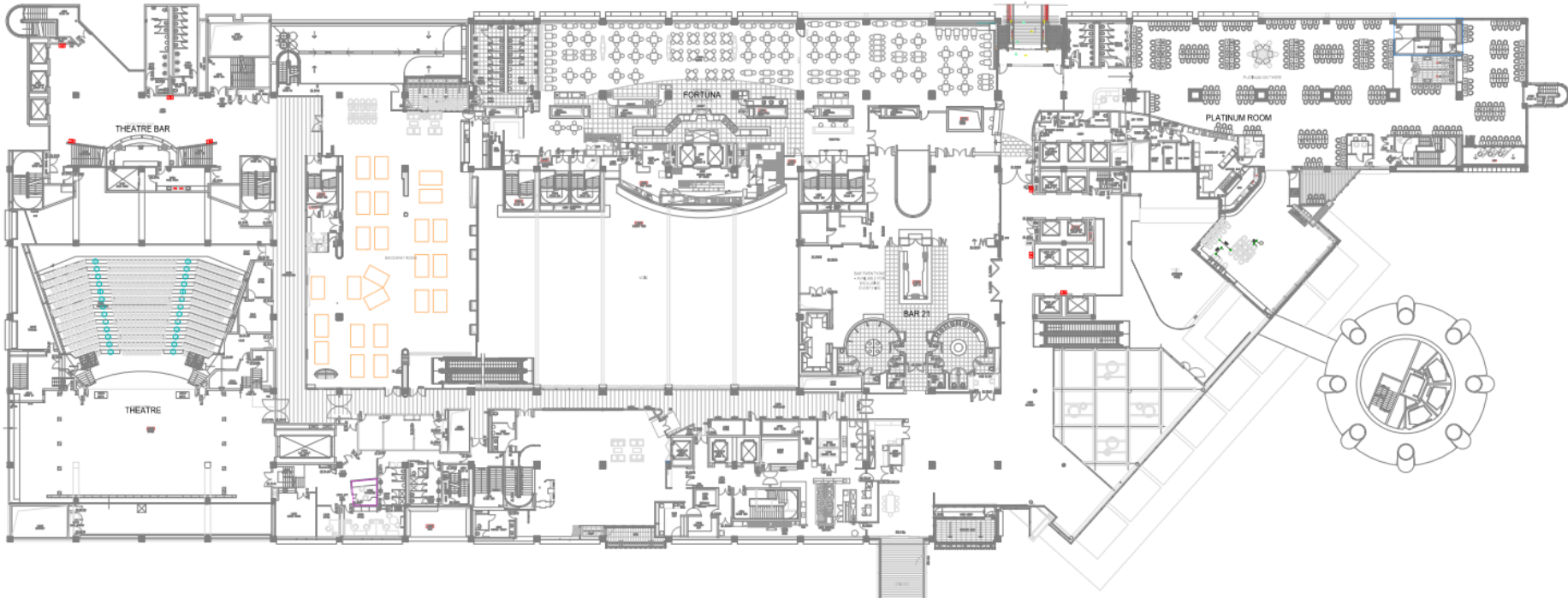

2025 L3 001

