

**DECISION UNDER DELEGATED AUTHORITY ON AN APPLICATION
BY CHRISTCHURCH CASINOS LIMITED FOR APPROVAL OF A
NEW FLOOR PLAN FOR THE CHRISTCHURCH CASINO**

Date of Decision: 2 June 2023

1. On 16 May 2023, Christchurch Casinos Limited Limited (“**CCL**”) applied, pursuant to condition 12 of its operator’s licence, for approval of a new floor plan, “Level 2 Gallery Floor Plan – June 2023”.
2. Condition 12 of its operator’s licence provides as follows:
 12. The Licence Holder shall obtain the approval of the Commission for new floor plans prior to relocating or installing tables or machines in positions not specified in approved floor layouts. When applying the Licence Holder must submit fresh plans showing the floor layout for the Gambling Area and details of the proposed CCTV layout for the consideration of the Commission. Any change must comply with the Surveillance Standard. The Executive Director and a single Gambling Commissioner may approve the new floor plans if they are satisfied that the floor layout has no potentially adverse effects. If they are not so satisfied, the proposed floor plan must be referred to the Commission for a decision on approval.

Submissions

3. CCL submitted as follows:
 - (a) It wants to increase EGM Bank 62 in Aspinall on Level 2 from four to five EGMs.
 - (b) If approved, it wants to make the change in late May, following completion of the floor plans approved under Delegated Approval 1374.
 - (c) The total number of EGMs deployed at the Casino will increase from 474 to 475, which is fewer than the 500 permitted by its licence conditions.
 - (d) All other areas of the Casino remain unchanged.
4. The proposed floor plan raises no issues of regulatory concern for the Commission. Accordingly, plan “Level 2 Gallery Floor Plan – June 2023” (**attached**) is approved by the Chief Gambling Commissioner and the Executive Director under delegated authority pursuant to condition 12 of CCL’s operator’s licence for the Christchurch casino.

- 5. Once CCL is reliant on "Level 2 Gallery Floor Plan – June 2023", "Level 2 Gallery – April 2023".



Lisa Hansen
Chief Gambling Commissioner
Gambling Commission

Blair Cairncross
Executive Director
Gambling Commission

2 June 2023



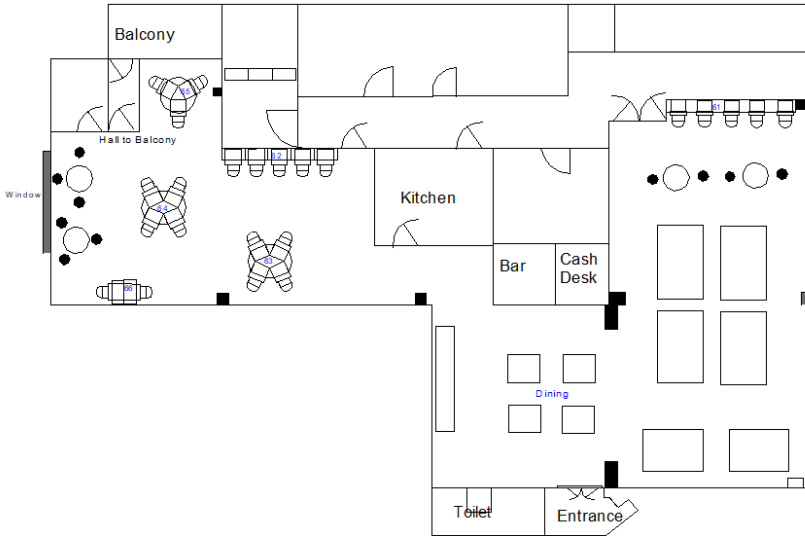

Christchurch Casinos Limited	Aspinall Floor Plan	DATE: June 2023
	23 Machines - 6 Tables	

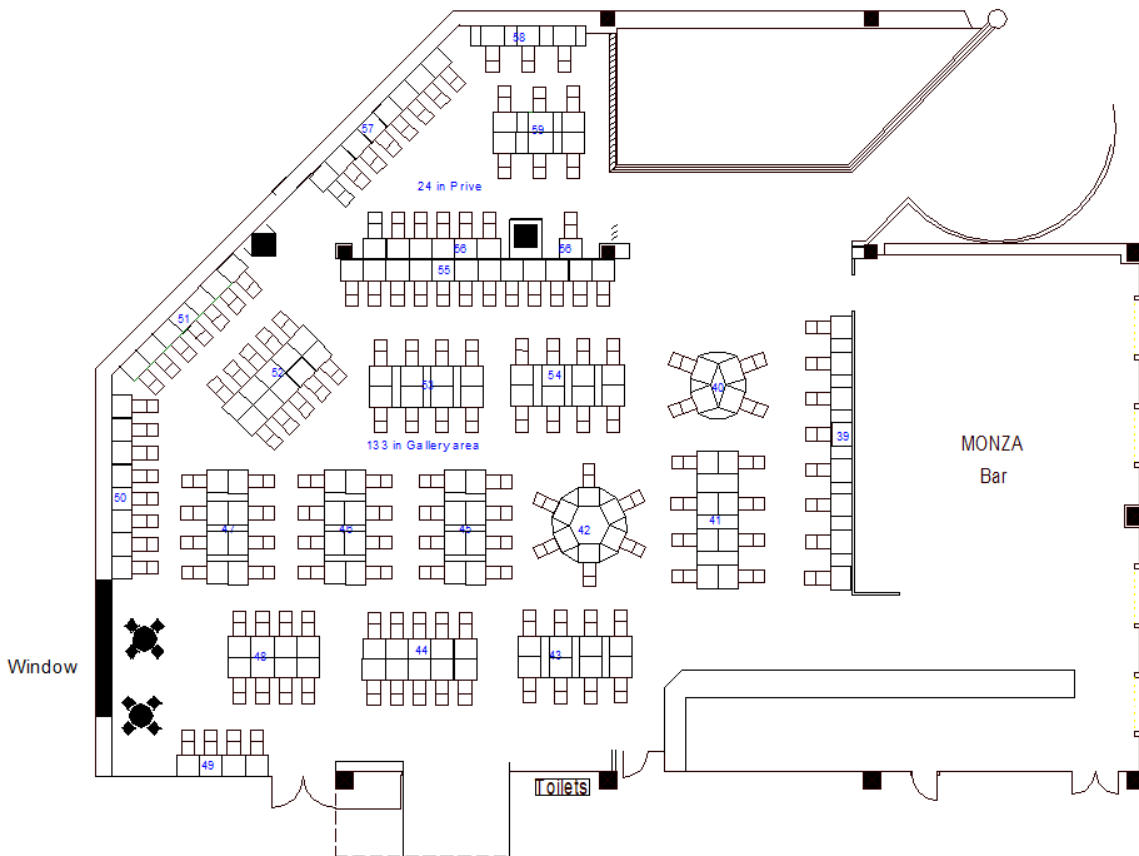

Christchurch Casinos Limited	LEVEL 2 - Gallery Floor Plan	DATE: June 2023
	157 MACHINES	SCALE 1:250