

**DECISION UNDER DELEGATED AUTHORITY ON AN APPLICATION
APPLICATION BY DUNEDIN CASINOS MANAGEMENT LIMITED FOR APPROVAL OF NEW
FLOOR PLANS, AND BY DUNEDIN CASINOS LIMITED FOR APPROVAL OF
CONSTRUCTION AND DESIGN CHANGES FOR THE DUNEDIN CASINO**

Date of Decision: 15 December 2021

1. On 14 December 2021, Dunedin Casinos Management Limited (“**DCML**”) applied, pursuant to condition 12 of its operator’s licence for the Dunedin Casino, for approval of two new floor plans, “Grand Casino COVID Protection Framework-Red Floor Plan – No Zones December 2021” and “Grand Casino COVID Protection Framework-Red Floor Plan – 2 Zones December 2021”; and Dunedin Casinos Limited (“**DCL**”) applied, pursuant to conditions 6 and 7 of its venue licence, for approval of construction and design changes to install partitions at the Dunedin Casino.

2. Conditions 11 and 12 of SCML’s operator’s licence provide as follows:

11. The Licence Holder shall operate in accordance with approved floor layouts showing the position of gaming tables and gaming machines.
12. The Licence Holder shall obtain approval for new floor plans prior to relocating or installing tables or machines in positions not specified in approved floor layouts. When applying, the Licence Holder must submit fresh plans showing the floor layout for the Gambling Area and details of the proposed CCTV layout for consideration. Any change must comply with the Surveillance Standard. The Executive Director and a single Gambling Commissioner may approve the new floor plans if they are satisfied that the floor layout has no potentially adverse effects. If they are not so satisfied, the proposed floor plan must be referred to the Commission for a decision on approval.

3. Conditions 6 and 7 of DCL’s venue licence provide as follows:

6. The Licence Holder must obtain the approval of the Commission prior to:
 - (a) construction or design changes to Level 1 of the Casino Venue, including the Gambling Area;
 - (b) the construction or relocation outside the Gambling Area and within the Casino Venue of bank facilities available to the public excluding ATMs, EFTPOS and like devices;
 - (c) the addition or alteration of signage relating to the casino business on the exterior of the Casino Venue or on or around the building within which it is located.

The process by which the Licence Holder may obtain approval for construction or design changes to Level 1 of the Casino Venue, (paragraph (a) above) is set out in condition 7. The Commission will determine any application for approval under 6(b). The Executive Director may approve the addition or alteration of signage relating to the casino business on the exterior of the Casino Venue or on or around the building within which it is located (paragraph (c) above) if he/she is satisfied the proposed changes will have no potentially

adverse effects. If he/she is not so satisfied the proposed changes must be referred to the Commission for a decision on approval.

7. The Licence Holder must notify the Executive Director of any proposed changes to the construction or design of Level 1 of the Casino Venue. Notification must be accompanied by relevant drawings and an assessment of any impacts the alterations may have on:
- (a) the integrity and fairness of games;
 - (b) the effectiveness of security and surveillance;
 - (c) harm prevention, harm minimisation and responsible gambling;
 - (d) potential access to the Gambling Area by persons under 20 years of age; and
 - (e) compliance by any person with the Act, including section 11 of the Act.

The Executive Director may approve the proposed changes to the construction or design if he or she is satisfied that there are no adverse impacts in relation to the matters specified in (a)-(e) above. If the Executive Director is not satisfied, he or she will refer the proposal to the Commission for determination.

8. DCML submitted as follows:

- (a) It is currently operating under floor plan "Grand Casino Main Gaming Floor Plan December 2021".
- (b) With COVID 19 still being prevalent and with the pending Christmas/New Year break, it seeks approval of floor plans "Grand Casino COVID Protection Framework-Red Floor Plan – No Zones December 2021" and "Grand Casino COVID Protection Framework-Red Floor Plan – 2 Zones December 2021". The proposed new floor plans would be utilised only if new restrictions were placed on the Casino as a result of COVID 19.
- (c) It wants to install partitions, which are detailed in plan "Grand Casino COVID Protection Framework-Red Floor Plan – 2 Zones December 2021" within the Casino
- (d) Plans "Grand Casino COVID Protection Framework-Red Floor Plan – No Zones December 2021" and "Grand Casino COVID Protection Framework-Red Floor Plan – 2 Zones December 2021" are similar to those approved in delegated approvals 1207 and 1223. They would allow the Casino to operate with 119 EGMs and eight gaming tables and comply with the likely conditions imposed by the New Zealand Government.

- (e) There will be no need to make any adjustments to the CCTV layout to accommodate the new floor plan and it will remain fully compliant with the Surveillance Standard.

- 9. The proposed floor plans raised no issues of regulatory concern for the Commission. Accordingly, plans “Grand Casino COVID Protection Framework-Red Floor Plan – No Zones December 2021” and “Grand Casino COVID Protection Framework-Red Floor Plan – 2 Zones December 2021” (**attached**) are approved by the Chief Gambling Commissioner and the Executive Director under delegated authority pursuant to conditions 11 and 12 of DCML’s operator’s licence for the Dunedin Casino.

- 10. When the casino partitions are no longer required, floor plans Grand Casino COVID Protection Framework-Red Floor Plan – No Zones December 2021” and “Grand Casino COVID Protection Framework-Red Floor Plan – 2 Zones December 2021” will cease to be valid.

- 11. The Commission was satisfied that the proposed construction and design changes in relation to the partitions would not adversely impact any of the matters set out in condition 7. The construction and design changes are approved by the Executive Director under delegated authority pursuant to conditions 6 and 7 of DCL’s venue licence.



Lisa Hansen
Chief Gambling Commissioner
Gambling Commission



Blair Cairncross
Executive Director
Gambling Commission

15 December 2021



GRAND CASINO

Grand Casino
 COVID Protection Framework-Red
 Floor Plan-No Zones
 December 2021
 119 Machines
 8 Tables

A missing chair denotes a deactivated or
 relocated machine.

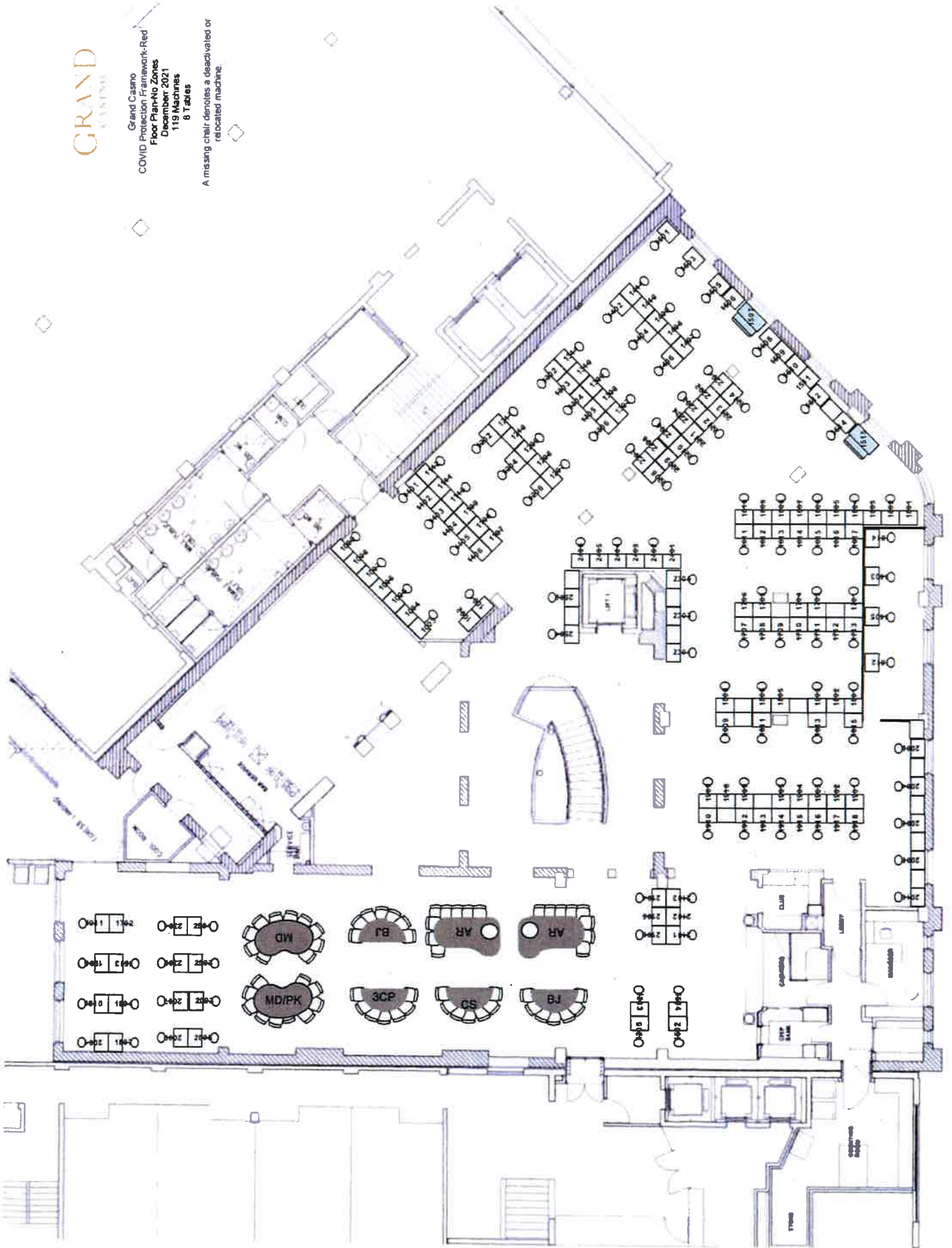

GRAND CASINO

Grand Casino
 COVID Protection Framework-Red
 Floor Plan-Zones
 December 2021
 119 Machines
 8 Tables

A missing chair denotes a deactivated or
 relocated machine

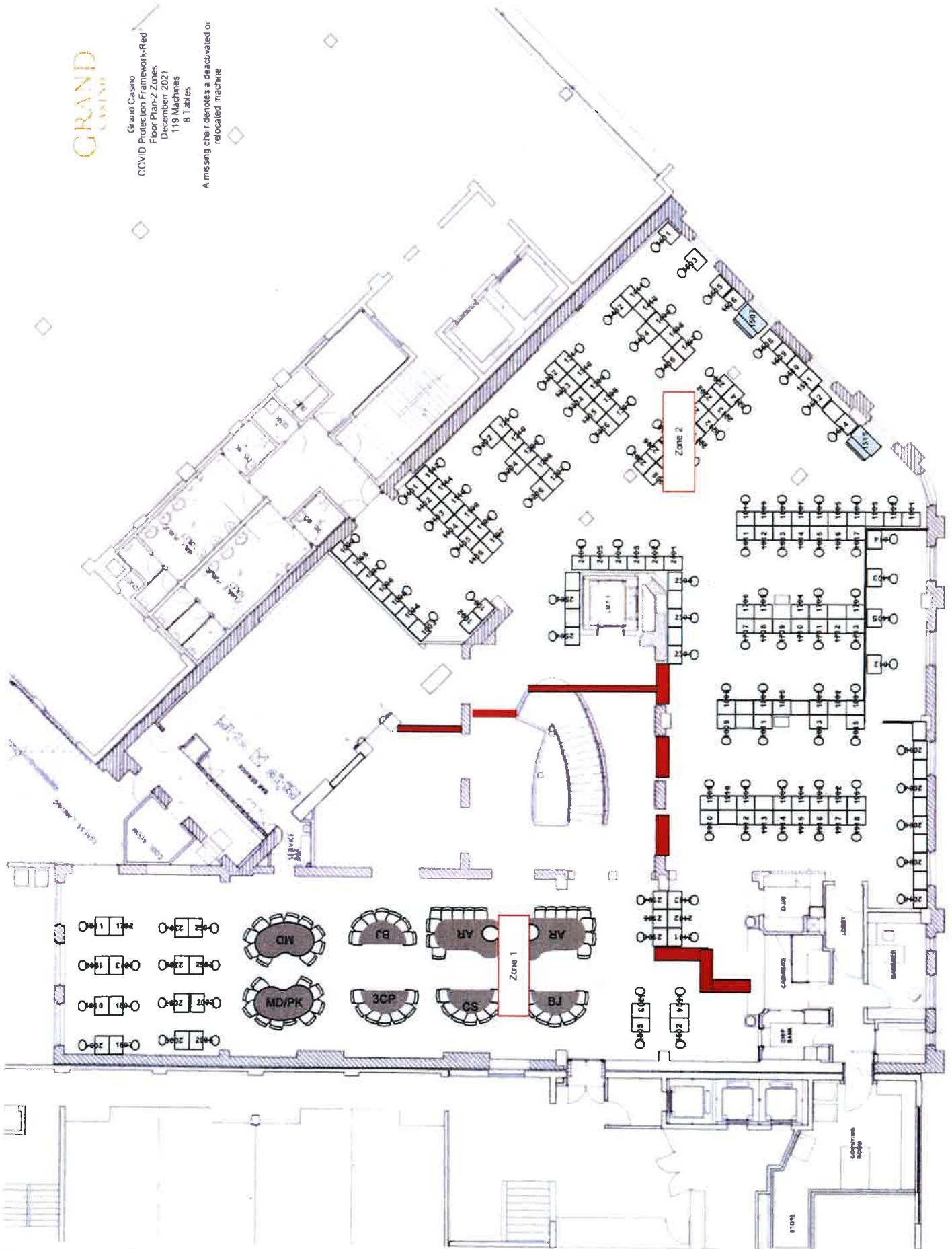

CRAND

Grand Casino
Main Gaming Floor Plan
Dec 2021 Traffic Study
17 Tables
180 Machines

