

**DECISION UNDER DELEGATED AUTHORITY ON AN APPLICATION
BY CHRISTCHURCH CASINOS LIMITED FOR APPROVAL OF
CONSTRUCTION AND DESIGN CHANGES, AND FOR APPROVAL OF TEMPORARY FLOOR
PLANS FOR THE CHRISTCHURCH CASINO**

Date of Decision: 18 November 2021

1. On 15 November 2021, Christchurch Casinos Limited Limited (“CCL”) applied, pursuant to conditions 6 and 7 of its venue licence, for approval to expose an existing, but covered window at the Christchurch casino; and for approval, pursuant to condition 12 of its operator’s licence, of temporary floor plans, “Level 1 Valley Floor Plan – November 2021” and Level 2 Gallery Floor Plan – November 2021”.

2. Conditions 6 and 7 of CCL’s venue licence provide as follows:

6. Subject to the provisions of condition 7, the Licence Holder must obtain the approval of the Commission prior to:

- (a) any construction or design changes whatsoever in the Gambling Area (Schedule 1) and Additional Gambling Areas (Schedules 2, 3 or 4) and for any construction or design changes elsewhere in the Casino Venue which may impact on the matters set out in condition 7;
- (b) the construction or relocation outside the Gambling Area and Additional Gambling Areas and within the Casino Venue of bank facilities available to the public excluding ATMs, EFTPOS and like devices; and
- (c) the addition or alteration of signage relating to the casino business on the exterior of the Casino Venue or on or around the building within which it is located.

The process by which the Licence Holder may obtain approval for construction or design changes to Levels 3 and 4 and the rooftop area of the Casino Venue, (paragraph (a) above) is set out in condition 7. The Commission will determine any application for approval under 6(b). The Executive Director may approve the addition or alteration of signage relating to the casino business on the exterior of the Casino Venue or on or around the building within which it is located (paragraph (c) above) if he/she is satisfied the proposed changes will have no potentially adverse effects. If he/she is not so satisfied, the proposed changes must be referred to the Commission for a decision on approval.

7. The Licence Holder must notify the Executive Director of any proposed changes to the construction or design for which approval is required under condition 6. Notification must be accompanied by relevant drawings and an assessment of any impacts the alterations may have on:

- (a) the integrity and fairness of games;
- (b) the effectiveness of security and surveillance;
- (c) harm prevention, harm minimisation and responsible gambling;
- (d) potential access to the Gambling Area by persons under 20 years of age; and
- (e) compliance by any person with the Act, including section 11 of the Act.

The Executive Director may approve the proposed changes to the construction or design if he or she is satisfied that there are no adverse impacts in relation to the matters specified in (a)-€ above. If the Executive Director is not satisfied, he or she will refer the proposal to the Commission for determination.

3. Condition 12 of CCL's operator's licence provides as follows:

12. The Licence Holder shall obtain the approval of the Commission for new floor plans prior to relocating or installing tables or machines in positions not specified in approved floor layouts. When applying the Licence Holder must submit fresh plans showing the floor layout for the Gambling Area and details of the proposed CCTV layout for the consideration of the Commission. Any change must comply with the Surveillance Standard. The Executive Director and a single Gambling Commissioner may approve the new floor plans if they are satisfied that the floor layout has no potentially adverse effects. If they are not so satisfied, the proposed floor plan must be referred to the Commission for a decision on approval.

4. CCL submitted:

Construction and design changes

- It wants to remove Gib from the wall on Level 2 and expose the window that sits behind it. This window was part of the original Casino build but was covered over with Gib board in the early 2000s. Uncovering this window will allow natural light into the Gallery. No gambling activity will be visible through the window.

Floor plans

- It recently obtained approval of temporary floor plans which allows it to deploy 370 EGMs and 28 gaming tables.
- It now seeks approval to deploy 353 EGMs and 28 gaming tables; 238 EGMs and 22 gaming tables on the MGF and 115 EGMs and 6 gaming tables on Level 2. These numbers are below current levels, and they are below its permitted maximum of 500 EGMs and 36 gaming tables.
- At some time following 29 November 2021, the "traffic light" COVID-19 Protection Framework will be enacted. When the Government announces "Green" or "Orange", the EGMs which are currently turned off will become operational. It will submit new plans depicting this at that time.

5. The construction and design changes proposed are approved by the Executive Director under delegated authority pursuant to conditions 6 and 7 of CCL's venue licence. The construction and design changes are to be generally in accordance with the application.
6. The proposed temporary floor plans raise no issues of regulatory concern for the Commission. Accordingly plans "Level 1 Valley Floor Plan – November 2021" and Level 2 Gallery Floor Plan – November 2021" are approved by the Chief Gambling Commissioner

and the Executive Director under delegated authority pursuant to condition 12 of CCL's operator's licence for the Christchurch casino. The floor plans are **attached**.

7. The Commission's approvals are limited to the construction and design changes and floor plans only, and do not extend to matters over which it has no jurisdiction, such as compliance with the Government's guidelines for COVID-19.



Lisa Hansen
Chief Gambling Commissioner
Gambling Commission



Blair Cairncross
Executive Director
Gambling Commission

18 November 2021



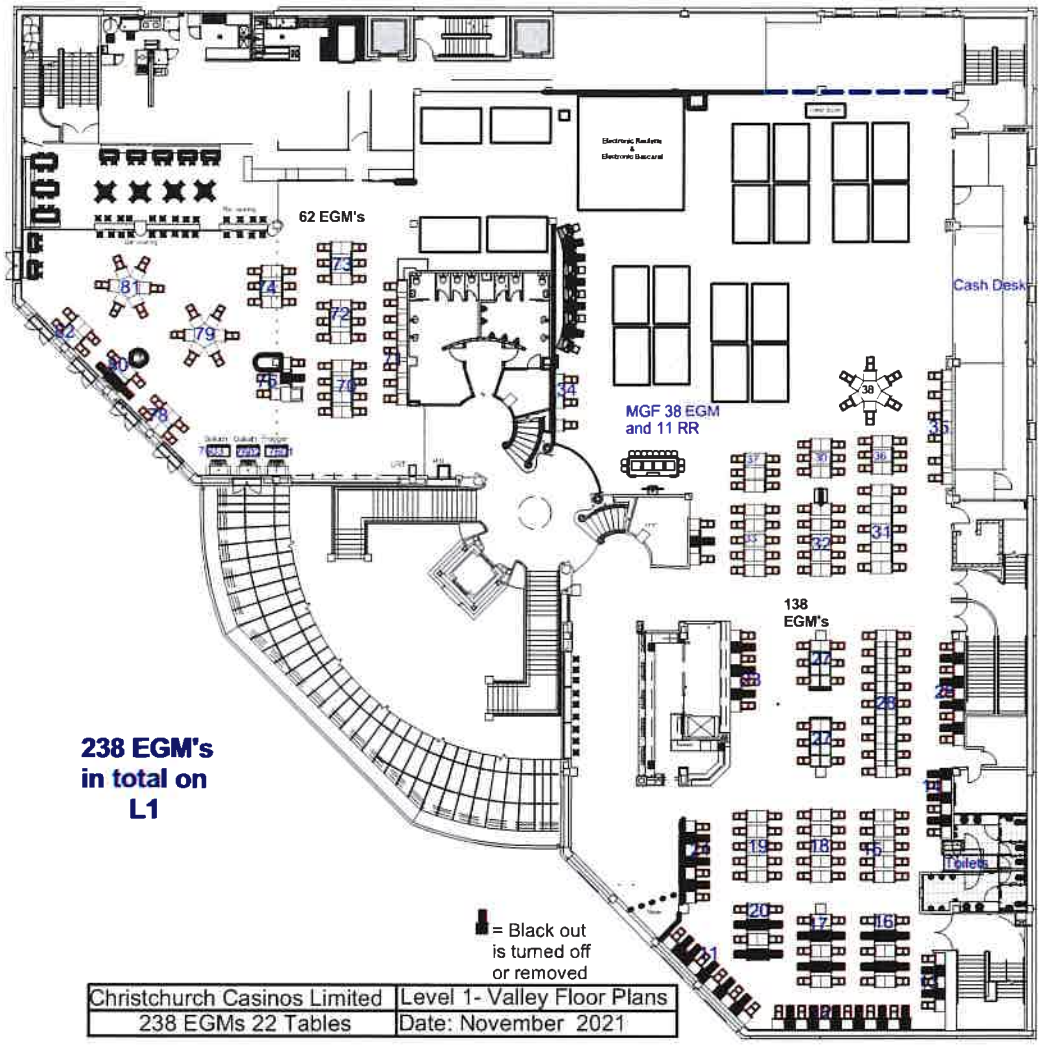

**238 EGM's
in total on
L1**

Christchurch Casinos Limited	Level 1- Valley Floor Plans
238 EGMs 22 Tables	Date: November 2021

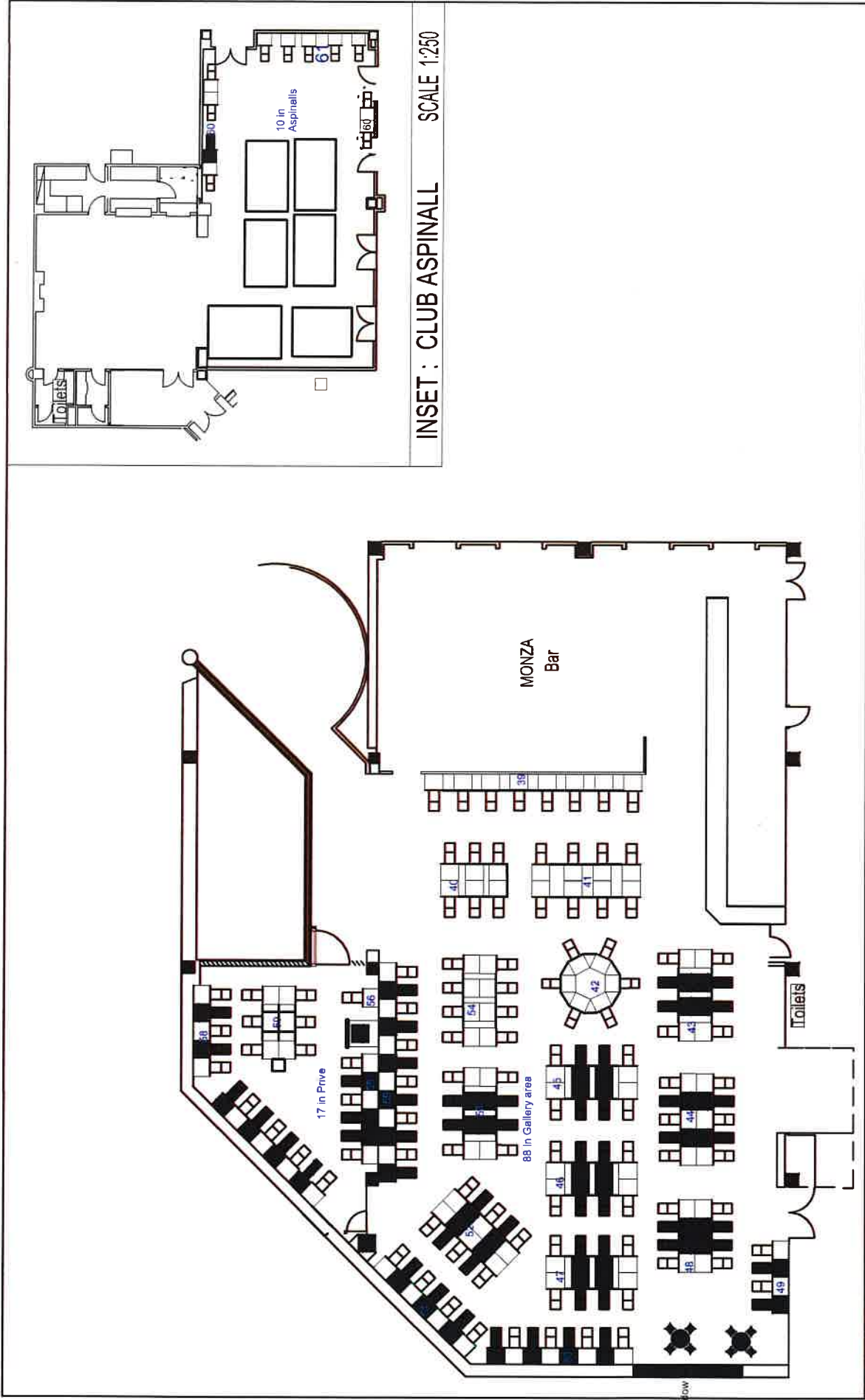

INSET : CLUB ASPINALL SCALE 1:250

Christchurch Casinos Limited

LEVEL 2 - Gallery Floor Plan
115 MACHINES 6 Tables

DATE:

November 2021

SCALE 1:250