

**DECISION UNDER DELEGATED AUTHORITY ON AN APPLICATION  
BY CHRISTCHURCH CASINOS LIMITED FOR APPROVAL OF  
CONSTRUCTION AND DESIGN CHANGES, AND FOR APPROVAL OF TEMPORARY FLOOR  
PLANS FOR THE CHRISTCHURCH CASINO**

**Date of Decision: 8 September 2021**

1. On 7 September 2021, Christchurch Casinos Limited Limited (“CCL”) applied, pursuant to conditions 6 and 7 of its venue licence, for approval to install temporary hoardings on the MGF and Level 2 of the Christchurch casino; and for approval, pursuant to condition 12 of its operator’s licence, of temporary floor plans, “Alert Level 2 Delta Main Floor September 2021” and “Alert Level 2 Delta Top Floor September 2021”.

2. Conditions 6 and 7 of CCL's venue licence provide as follows:

6. Subject to the provisions of condition 7, the Licence Holder must obtain the approval of the Commission prior to:

- (a) any construction or design changes whatsoever in the Gambling Area (Schedule 1) and Additional Gambling Areas (Schedules 2, 3 or 4) and for any construction or design changes elsewhere in the Casino Venue which may impact on the matters set out in condition 7;
- (b) the construction or relocation outside the Gambling Area and Additional Gambling Areas and within the Casino Venue of bank facilities available to the public excluding ATMs, EFTPOS and like devices; and
- (c) the addition or alteration of signage relating to the casino business on the exterior of the Casino Venue or on or around the building within which it is located.

The process by which the Licence Holder may obtain approval for construction or design changes to Levels 3 and 4 and the rooftop area of the Casino Venue, (paragraph (a) above) is set out in condition 7. The Commission will determine any application for approval under 6(b). The Executive Director may approve the addition or alteration of signage relating to the casino business on the exterior of the Casino Venue or on or around the building within which it is located (paragraph (c) above) if he/she is satisfied the proposed changes will have no potentially adverse effects. If he/she is not so satisfied, the proposed changes must be referred to the Commission for a decision on approval.

7. The Licence Holder must notify the Executive Director of any proposed changes to the construction or design for which approval is required under condition 6. Notification must be accompanied by relevant drawings and an assessment of any impacts the alterations may have on:

- (a) the integrity and fairness of games;
- (b) the effectiveness of security and surveillance;
- (c) harm prevention, harm minimisation and responsible gambling;
- (d) potential access to the Gambling Area by persons under 20 years of age; and
- (e) compliance by any person with the Act, including section 11 of the Act.

The Executive Director may approve the proposed changes to the construction or design if he or she is satisfied that there are no adverse impacts in relation to the matters specified in (a)-(e) above. If the Executive Director is not satisfied, he or she will refer the proposal to the Commission for determination.

3. Condition 12 of CCL's operator's licence provides as follows:

12. The Licence Holder shall obtain the approval of the Commission for new floor plans prior to relocating or installing tables or machines in positions not specified in approved floor layouts. When applying the Licence Holder must submit fresh plans showing the floor layout for the Gambling Area and details of the proposed CCTV layout for the consideration of the Commission. Any change must comply with the Surveillance Standard. The Executive Director and a single Gambling Commissioner may approve the new floor plans if they are satisfied that the floor layout has no potentially adverse effects. If they are not so satisfied, the proposed floor plan must be referred to the Commission for a decision on approval.

4. CCL submitted:

*Construction and design changes*

- It wants to erect temporary 2m high hoardings sectioning the Casino into four separate/defined areas, to allow it to reopen under Alert Level 2. Each area will safely accommodate guests within the permitted maximum of 50 guests per area.
- The four separate areas in the casino will be as follows:
  - the Café and the northern portion of the MGF;
  - the Valley Bar slots area and the southern portion of the MGF;
  - Level 2, excluding Aspinalls and the smoker's area; and
  - the VIP Room, Aspinalls, and the smoker's area (available for Aspinall members use).
- Each area will have its own mix of EGMs and/or gaming tables, together with its own bathrooms and cashiering facilities. To assist with contact tracing, casino members in each defined area will swipe their membership card at a designated area kiosk, while non-members will scan the area's COVID-19 QR code. All guests and staff will be required to wear masks unless engaging in our food and beverage offerings, at which time they will be required to be seated.

*Floor plans*

- It recently obtained approval of a temporary floor plan which allows it to deploy 327 EGMs. It wants to reopen the Casino with 341 EGMs and 28 gaming (219 EGMs and 22 gaming tables on Level 1, and 122 EGMs and 6 gaming tables on Level 2), which is still below its permitted maximum of 500 EGMs and 36 gaming tables.

5. The Executive Director was satisfied that CCL's proposal to erect temporary hoardings would not adversely impact upon any of the matters set out in condition 7. The construction and design changes proposed are approved by the Executive Director under delegated authority pursuant to conditions 6 and 7 of CCL's venue licence. The construction and design changes are to be generally in accordance with the application.
6. The proposed temporary floor plans raise no issues of regulatory concern for the Commission. Accordingly plans "Alert Level 2 Delta Main Floor September 2021" and "Alert Level 2 Delta Top Floor September 2021" are approved by the Chief Gambling Commissioner and the Executive Director under delegated authority pursuant to condition 12 of CCL's operator's licence for the Christchurch casino. The floor plans are **attached**.
7. Floor plans "Alert Level 2 Delta Main Floor September 2021" and "Alert Level 2 Delta Top Floor September 2021" will cease to be valid once Christchurch leaves COVID Alert Level 2 and enters Alert Level 1.
8. The Commission's approvals are limited to the construction and design changes and floor plans only, and do not extend to matters over which it has no jurisdiction, such as compliance with the Government's guidelines for COVID-19.



---

**Lisa Hansen**  
Chief Gambling Commissioner  
Gambling Commission



---

**Blair Cairncross**  
Executive Director  
Gambling Commission

8 September 2021





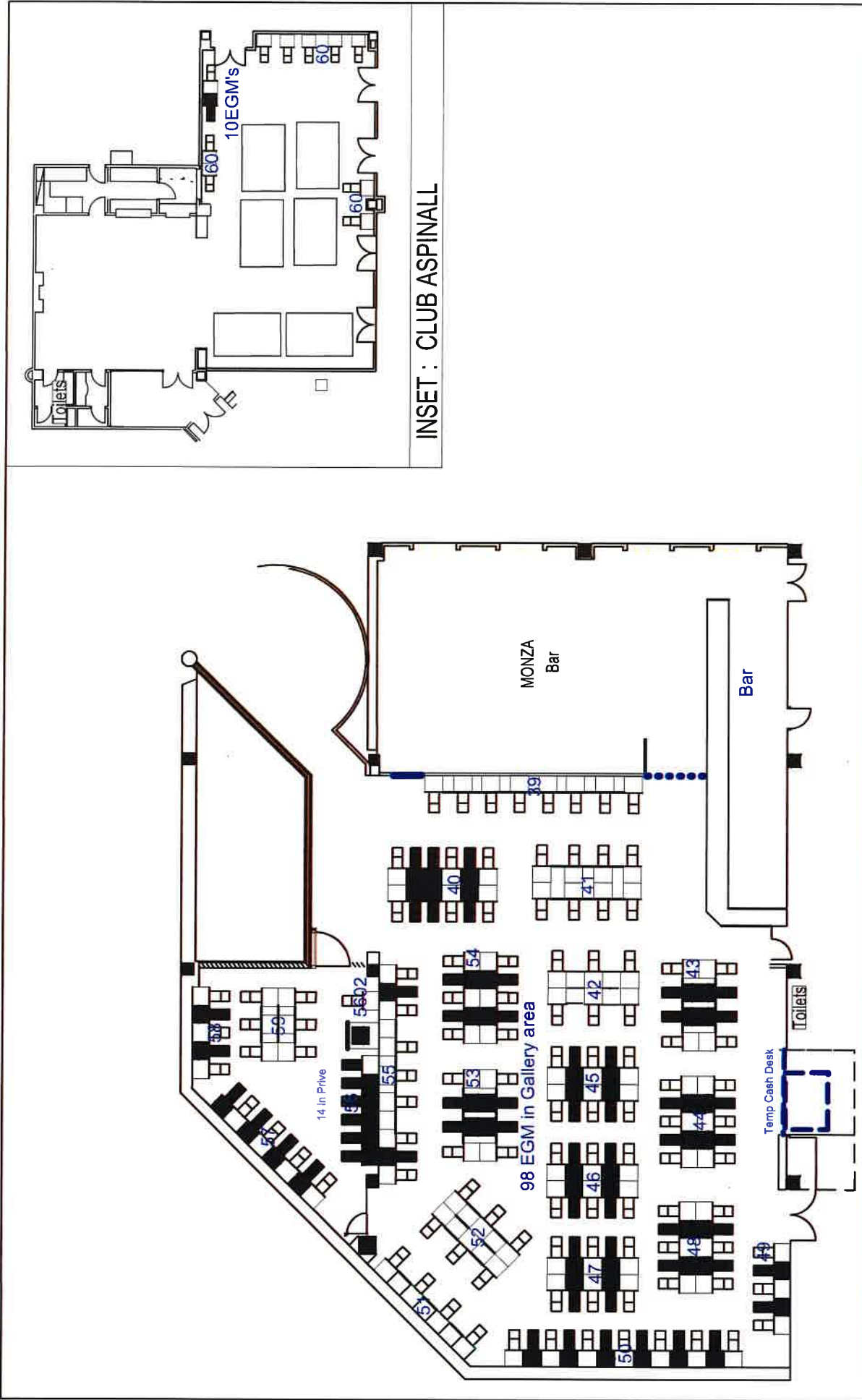

INSET : CLUB ASPINALL

Christchurch Casinos Limited

LEVEL 2 - Gallery Floor Plan

122 MACHINES - 6 Tables

DATE:

September 2021

SCALE 1:250

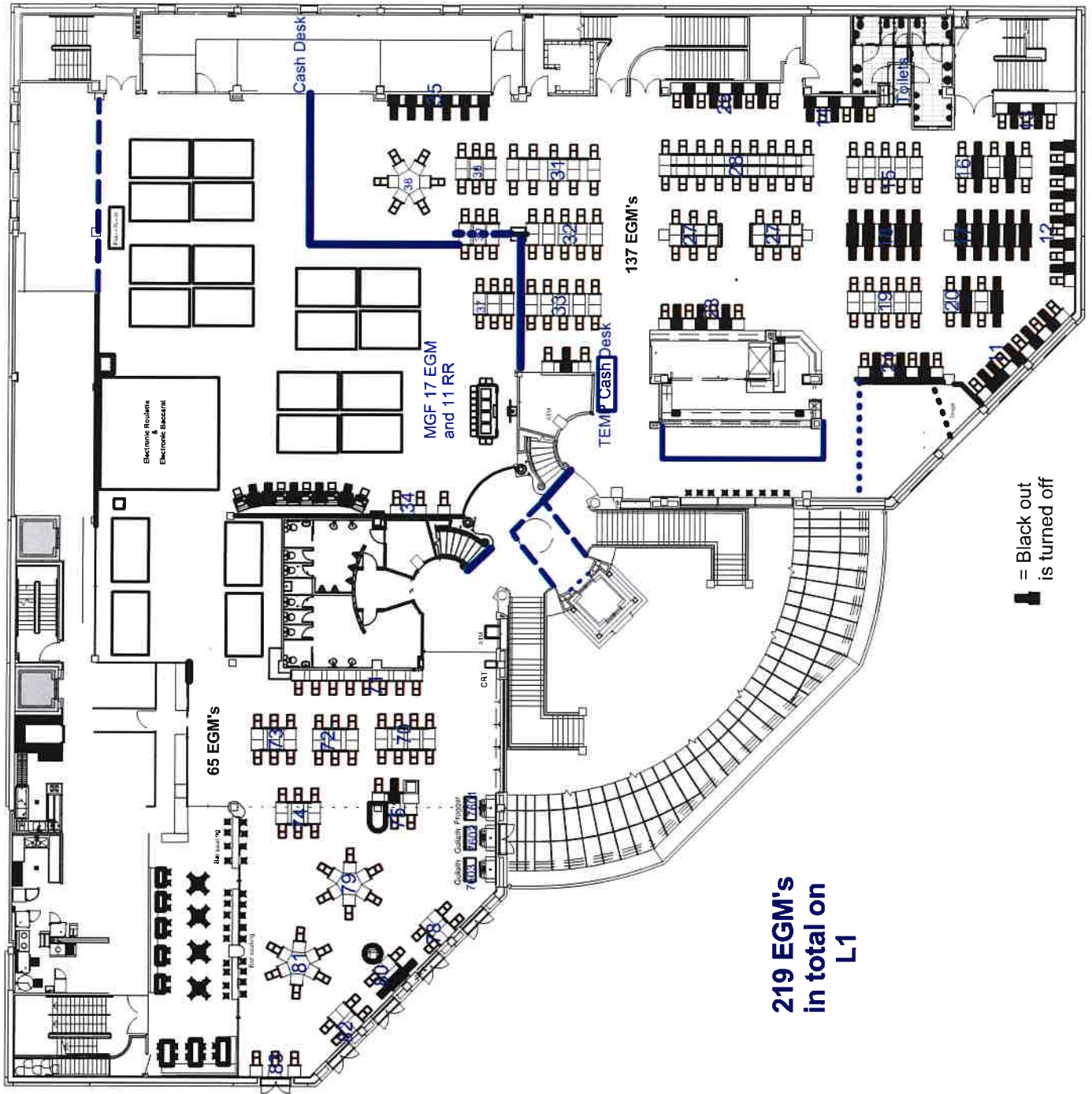

**219 EGM's  
 in total on  
 L1**