

**DECISION UNDER DELEGATED AUTHORITY ON AN APPLICATION
BY CHRISTCHURCH CASINOS LIMITED FOR APPROVAL OF
NEW FLOOR PLANS FOR THE CHRISTCHURCH CASINO**

Date of Decision:  August 2021

1. On 28 July 2021, Christchurch Casinos Limited (“CCL”) applied, pursuant to condition 12 of its operator’s licence, for approval of two new floor plans, “Level 1-Valley Floor Plans July 2021” and “Level 2 Gallery Floor Plan July 2021”.

2. Condition 12 provides as follows:

The Licence Holder shall obtain the approval of the Commission for new floor plans prior to relocating or installing tables or machines in positions not specified in approved floor layouts. When applying the Licence Holder must submit fresh plans showing the floor layout for the Gambling Area and details of the proposed CCTV layout for the consideration of the Commission. Any change must comply with the Surveillance Standard. The Executive Director and a single Gambling Commissioner may approve the new floor plans if they are satisfied that the floor layout has no potentially adverse effects. If they are not so satisfied, the proposed floor plan must be referred to the Commission for a decision on approval.

3. CCL submitted:

- It wants to make minor changes to Levels 1 and 2 of the casino, as follows:
 - to remove three EGMs adjacent to the Café to allow for increased seating;
 - to increase spacing by replacing a bank of 10 EGMs with a bank of 8.
- If approved, the number of EGMs deployed would decrease from 467 to 462, which is still below the 500 EGMs permitted pursuant to the licence conditions attached to its operator’s licence.

4. The proposal raises no issues of regulatory concern for the Commission. Accordingly plans “Level 1 – Valley Floor Plans July 2021” and “Level 2 – Gallery Floor Plan July 2021” are approved by the Chief Gambling Commissioner and the Executive Director under delegated authority pursuant to condition 12 of CCL’s operator’s licence for the Christchurch casino. The floor plans are **attached**.

5. Once CCL is reliant on plan “Level 1 – Valley Floor Plans July 2021”, plan “Level 1-MGF May (2) 2021” will cease to be valid.

- 6. Once CCL is reliant on plan "Level 2 – Gallery Floor Plan July 2021", plan "Level 2 – Gallery Floor Plan November 2020" will cease to be valid.



Lisa Hansen
Chief Gambling Commissioner
Gambling Commission

Blair Cairncross
Executive Director
Gambling Commission

3 August 2021



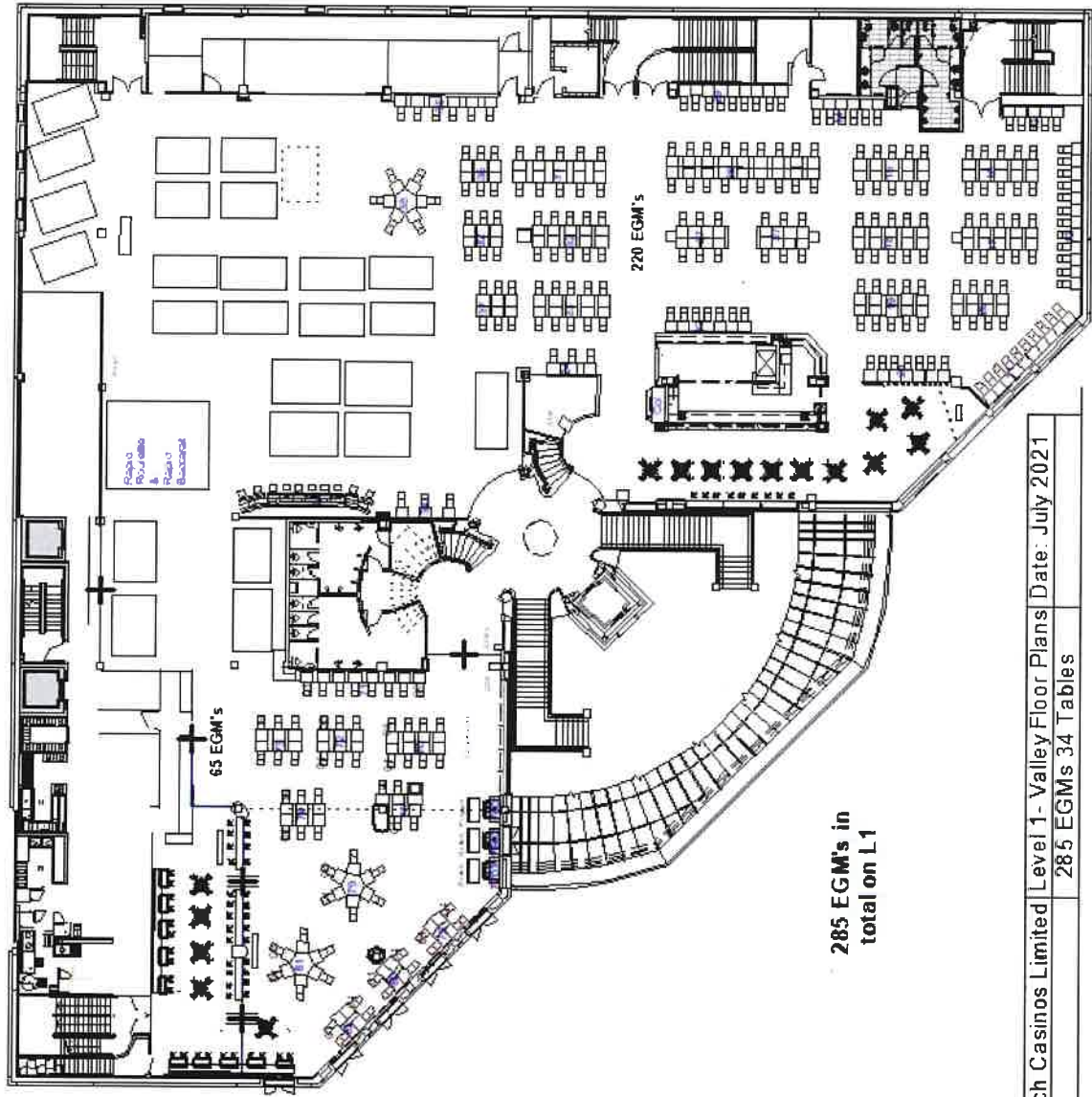

285 EGM's in
total on L1

Christchurch Casinos Limited	Level 1 - Valley Floor Plans	Date: July 2021
285 EGM's 34 Tables		

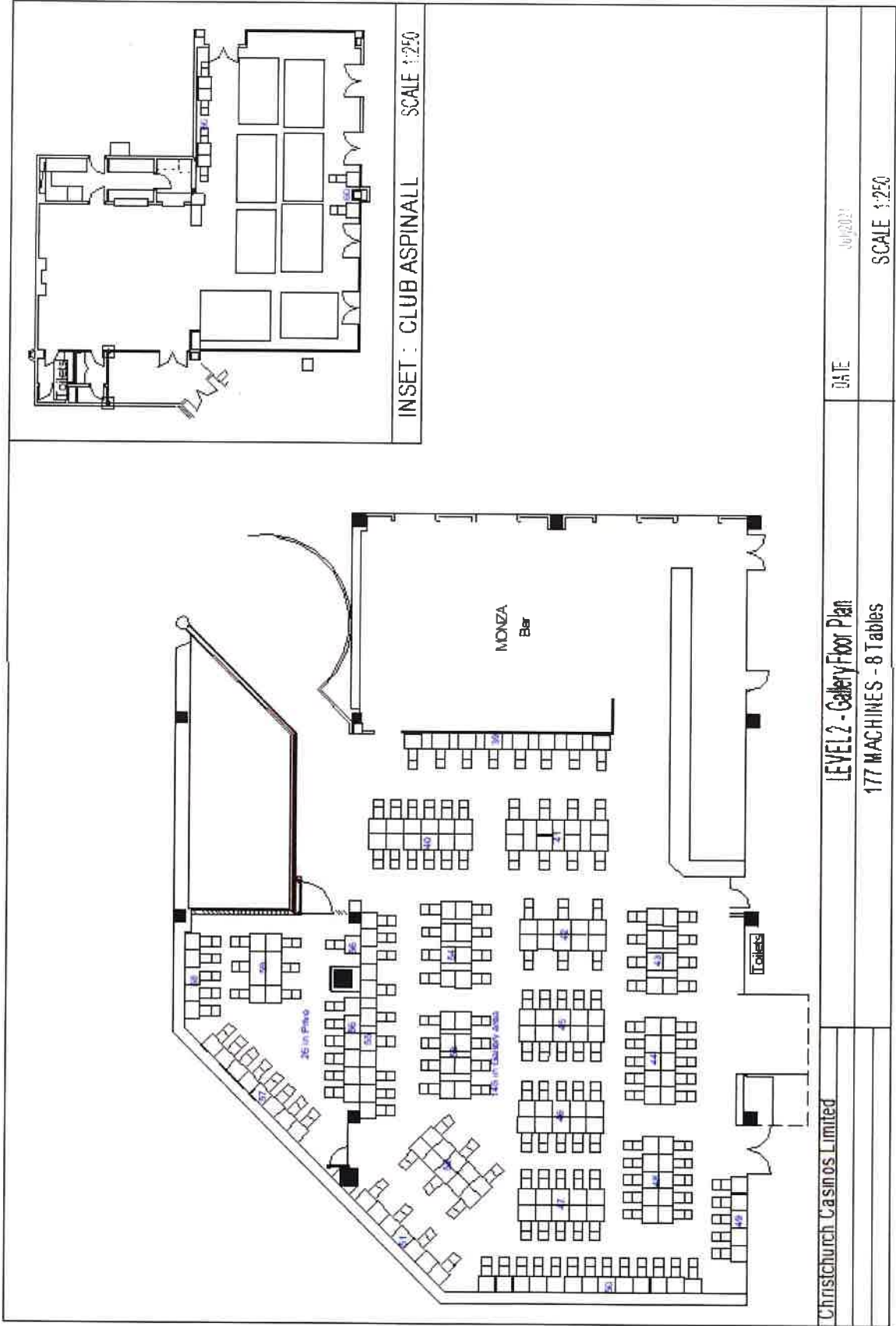

Christchurch Casinos Limited

LEVEL 2 - Gallery Floor Plan

177 MACHINES - 8 Tables

DATE

July 2011

SCALE 1:250

INSET : CLUB ASPINALL

SCALE 1:250