

**DECISION UNDER DELEGATED AUTHORITY ON AN APPLICATION
BY CHRISTCHURCH CASINOS LIMITED FOR APPROVAL OF
A NEW FLOOR PLAN FOR THE CHRISTCHURCH CASINO**

Date of Decision: 20 October 2020

1. On 13 October 2020, Christchurch Casinos Limited (“**CCL**”) applied, pursuant to condition 12 of its operator’s licence, for approval of a new floor plan, “Level 2-Gallery October 2020”.

2. Condition 12 provides as follows:

The Licence Holder shall obtain the approval of the Commission for new floor plans prior to relocating or installing tables or machines in positions not specified in approved floor layouts. When applying the Licence Holder must submit fresh plans showing the floor layout for the Gambling Area and details of the proposed CCTV layout for the consideration of the Commission. Any change must comply with the Surveillance Standard. The Executive Director and a single Gambling Commissioner may approve the new floor plans if they are satisfied that the floor layout has no potentially adverse effects. If they are not so satisfied, the proposed floor plan must be referred to the Commission for a decision on approval.

3. CCL submitted:

- It wants to remove two EGMs from the Prive area. The change would reduce the total number of EGMs in operation from 452 to 450. Level 2 EGM numbers would reduce from 177 to 175 and in the Prive Area from 28 to 26.
- The proposed new floor plan will create greater physical distancing around the EGMs. Also, it has recently purchased some new wider cabinets which will better fit in this space, with fewer machines on the same base.

4. The proposal raises no issues of regulatory concern for the Commission. Accordingly plan “Level 2-Gallery October 2020” (**attached**) is approved by the Chief Gambling Commissioner and the Executive Director under delegated authority pursuant to condition 12 of CCL’s operator’s licence for the Christchurch casino.

5. Once CCL is reliant on plan "Level 2-Gallery October 2020", plan "Level 2-Gallery July 2020" will cease to be valid.



Lisa Hansen
Chief Gambling Commissioner
Gambling Commission

Blair Cairncross
Executive Director
Gambling Commission

20 October 2020



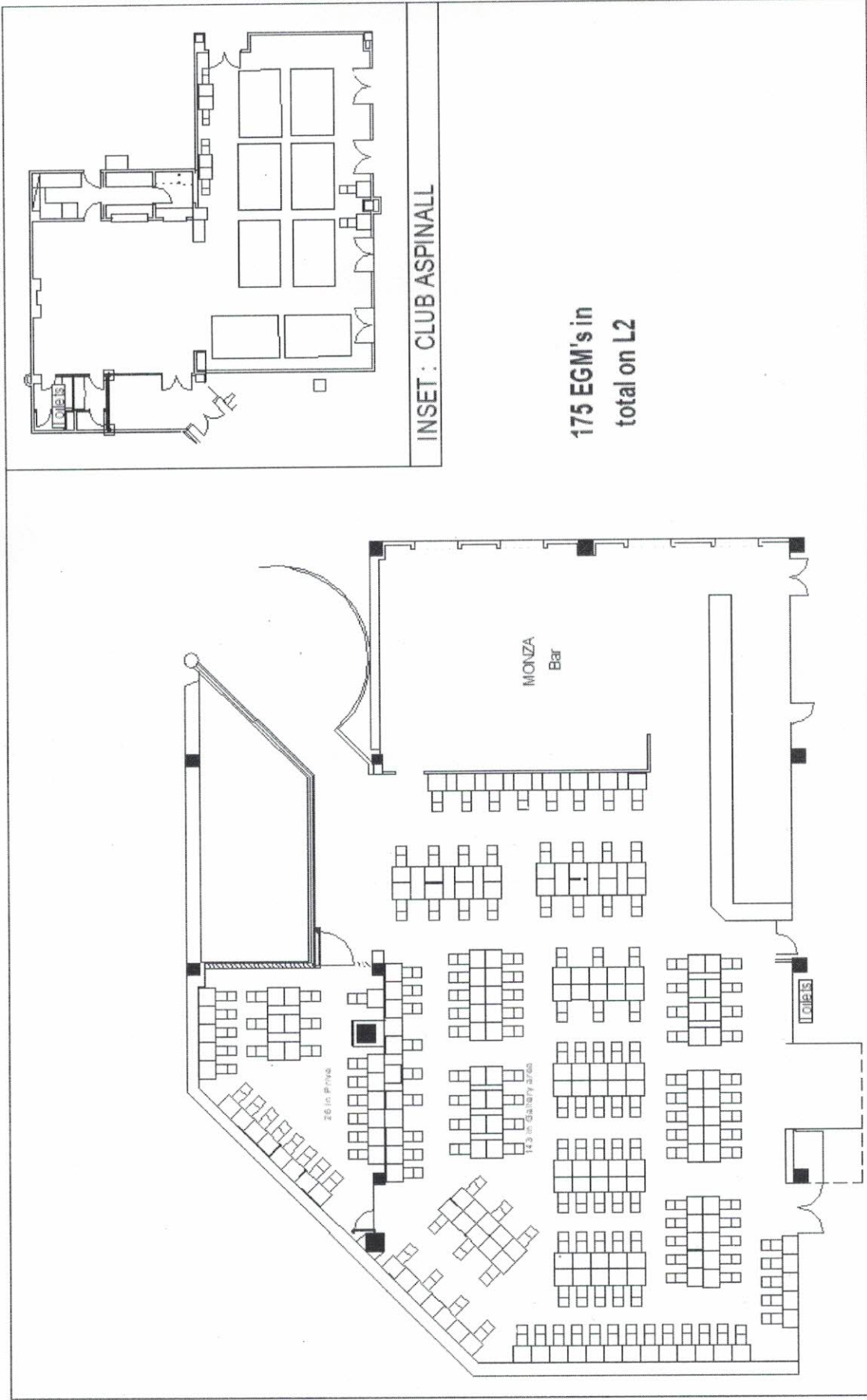

175 EGM's in total on L2

Christchurch Casinos Limited	LEVEL 2 - Gallery Floor Plan	DATE: October 2020
175 MACHINES - 8 Tables		SCALE 1:250