

IN THE MATTER of the Gambling Act 2003
AND on an application by **SKYCITY CASINOS MANAGEMENT LIMITED** for approval of a temporary floor layout plan

BEFORE THE GAMBLING COMMISSION

Members Present: P Chin (Chief Gambling Commissioner)
K M Ford
M M Lythe
P J Stanley
G L Reeves

Date of Application: 4 August 2006

Date of Decision: 12 September 2006

Date of Notification
of Decision: 19 September 2006

DECISION

**ON AN APPLICATION BY SKYCITY CASINOS MANAGEMENT LIMITED FOR APPROVAL OF
A TEMPORARY FLOOR LAYOUT PLAN**

Application

1. SKYCITY Casinos Management Limited (the "**Applicant**") applied to the Gambling Commission (the "**Commission**") for approval, under condition 11 of its operator's licence, for a temporary floor plan, Plan "J(Temp)".

Licence condition

2. The relevant licence condition is as follows:

SCML operator's licence

11. The Licence Holder shall operate in accordance with approved floor layouts showing the position of gaming tables and gaming machines. The Licence Holder shall obtain the approval of the Commission for new floor plans prior to relocating or installing tables or machines in positions not specified in approved floor layouts. When applying the Licence Holder must submit fresh plans showing the floor layout for the Gambling Area and details of the proposed CCTV layout for the consideration of the Commission. Any change must comply with the Surveillance Standard.



Submissions by the Applicant

3. The Applicant obtained approval for Plan "I(Temp)" in decision GC23/06, but has since decided that that plan no longer represents the most efficient way of utilising its limited floor space during the refurbishment of the Auckland casino. The Applicant submitted that Plan "J(Temp)" would better achieve this.
4. The Applicant submitted that Plan "J(Temp)" involves moving gaming machines and tables from "north-south" to "east-west" and that as there is no change to the game mix, sections 11 and 12 of the Act have no relevance. The Applicant submitted that Plan "J(Temp)" would require CCTV adjustments, but it would advise the DIA Inspectorate of any changes to ensure that it complies with the surveillance policy.

Submissions by the Secretary

5. The Secretary had no objections to Plan "J(Temp)" provided the Applicant complied with the surveillance policy.

Analysis

6. Plan "J(Temp)" involves a reconfiguration of machines and tables. It does not change the game mix or numbers of machines or tables and will not increase opportunities for casino gambling.

Decision

7. The Commission decided unanimously to approve floor Plan "J(Temp)" (**attached** to this decision) under condition 11 of the Applicant's operator's licence. The Applicant is to notify the DIA Inspectorate and the Commission when it becomes reliant upon Plan "J(Temp)".
8. The Commission revokes Plan "I(Temp)".



**GAMBLING
COMMISSION**

Peter Shin
Chief Gambling Commissioner

for and on behalf of the
Gambling Commission

19 September 2006

J(temp)

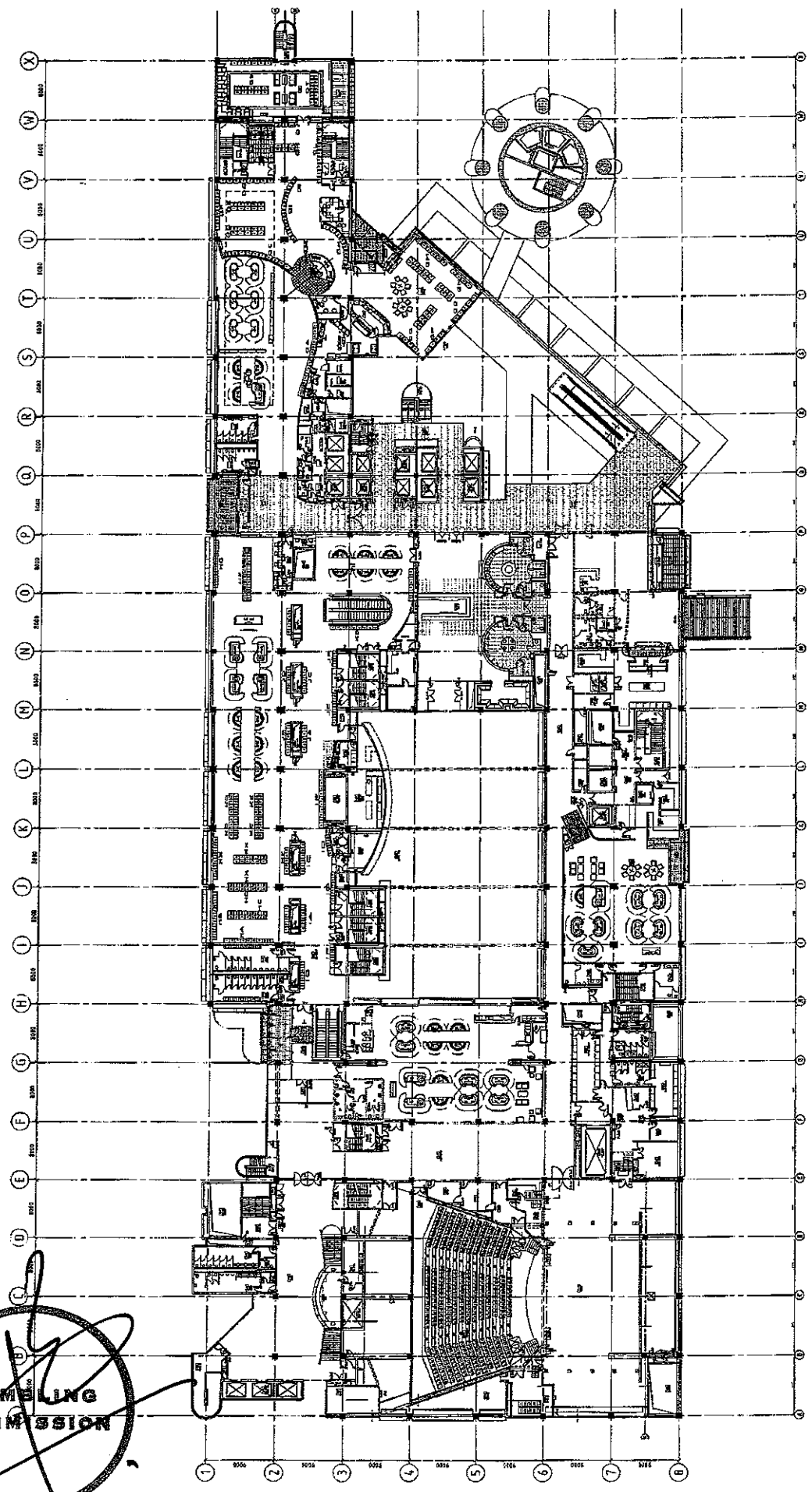

SCHEDULE

CEILING	01
FLOORING	02
WALLS	03
DOORS	04
WINDOWS	05
GLASS	06
MECHANICAL	07
ELECTRICAL	08
PLUMBING	09
PAINTING	10
FINISHES	11
MECHANICAL	12
ELECTRICAL	13
PLUMBING	14
PAINTING	15
FINISHES	16
MECHANICAL	17
ELECTRICAL	18
PLUMBING	19
PAINTING	20
FINISHES	21

REVISION

No.	Description	Date
1	ISSUED FOR PERMIT	12/12/07
2	ISSUED FOR PERMIT	12/12/07
3	ISSUED FOR PERMIT	12/12/07
4	ISSUED FOR PERMIT	12/12/07
5	ISSUED FOR PERMIT	12/12/07
6	ISSUED FOR PERMIT	12/12/07
7	ISSUED FOR PERMIT	12/12/07
8	ISSUED FOR PERMIT	12/12/07
9	ISSUED FOR PERMIT	12/12/07
10	ISSUED FOR PERMIT	12/12/07
11	ISSUED FOR PERMIT	12/12/07
12	ISSUED FOR PERMIT	12/12/07
13	ISSUED FOR PERMIT	12/12/07
14	ISSUED FOR PERMIT	12/12/07
15	ISSUED FOR PERMIT	12/12/07
16	ISSUED FOR PERMIT	12/12/07
17	ISSUED FOR PERMIT	12/12/07
18	ISSUED FOR PERMIT	12/12/07
19	ISSUED FOR PERMIT	12/12/07
20	ISSUED FOR PERMIT	12/12/07
21	ISSUED FOR PERMIT	12/12/07
22	ISSUED FOR PERMIT	12/12/07
23	ISSUED FOR PERMIT	12/12/07
24	ISSUED FOR PERMIT	12/12/07
25	ISSUED FOR PERMIT	12/12/07
26	ISSUED FOR PERMIT	12/12/07
27	ISSUED FOR PERMIT	12/12/07
28	ISSUED FOR PERMIT	12/12/07
29	ISSUED FOR PERMIT	12/12/07
30	ISSUED FOR PERMIT	12/12/07
31	ISSUED FOR PERMIT	12/12/07
32	ISSUED FOR PERMIT	12/12/07
33	ISSUED FOR PERMIT	12/12/07
34	ISSUED FOR PERMIT	12/12/07
35	ISSUED FOR PERMIT	12/12/07
36	ISSUED FOR PERMIT	12/12/07
37	ISSUED FOR PERMIT	12/12/07
38	ISSUED FOR PERMIT	12/12/07
39	ISSUED FOR PERMIT	12/12/07
40	ISSUED FOR PERMIT	12/12/07
41	ISSUED FOR PERMIT	12/12/07
42	ISSUED FOR PERMIT	12/12/07
43	ISSUED FOR PERMIT	12/12/07
44	ISSUED FOR PERMIT	12/12/07
45	ISSUED FOR PERMIT	12/12/07
46	ISSUED FOR PERMIT	12/12/07
47	ISSUED FOR PERMIT	12/12/07
48	ISSUED FOR PERMIT	12/12/07
49	ISSUED FOR PERMIT	12/12/07
50	ISSUED FOR PERMIT	12/12/07

SKY CITY ENTERTAINMENT GROUP
Gaming Layouts

SKY CITY ENTERTAINMENT GROUP

Moller Architects

Level 3 Gaming Layout
SKY CITY
A1203(B) REV/2 option 2.dwg

0031 | A 1203(B) | 03

DATE: 12/12/07
DRAWN: [Name]
CHECKED: [Name]
APPROVED: [Name]