

IN THE MATTER of the Gambling Act 2003

AND on an application by
**CHRISTCHURCH CASINOS
LIMITED** for approval of a new
floor plan

BEFORE THE GAMBLING COMMISSION

Members: P Chin (Chief Gambling Commissioner)
M M Lythe
P J Stanley
G L Reeves
M J Richardson

Date of Application: 4 September 2009

Date of Decision: 16 October 2009

Date of Notification
of Decision: 2 October 2009

**DECISION ON APPLICATION BY CHRISTCHURCH CASINOS LIMITED
FOR APPROVAL OF A NEW FLOOR PLAN**

Introduction

1 Christchurch Casinos Limited ("CCL") applied, under conditions 11 and 12 of its operator's licence, for approval of a new floor plan, "September 2009"

2 The relevant licence conditions are as follows:

- 11 The Licence Holder shall operate in accordance with approved floor layouts showing the position of gaming tables and gaming machines
- 12 The Licence Holder shall obtain the approval of the Commission for new floor plans prior to relocating or installing tables or machines in positions not specified in approved floor layouts. When applying the Licence Holder must submit fresh plans showing the floor layout for the Gambling Area and details of the proposed CCTV layout for the consideration of the Commission. Any change must comply with the Surveillance Standard

Submissions by CCL

3 CCL stated that it wanted to make the following changes to its floor layout:

Level 3

- (i) To reintroduce a single oversized gaming machine known as "Big Bertha"
- (ii) To reposition eight existing gaming machines into an octagonal shape



- (iii) To reposition the Touchbet Roulette terminals

Level 4

- (iv) To remove the door and glass partition from the Privé area
- (v) To remove two machines from a bank of machines (Bank 57) to facilitate egress through the back of Privé
- (vi) To remove the coffee station at the end of Bank 59 to allow one of the removed gaming machines from Bank 57 to be relocated to that position

4 CCL submitted that:

- (a) Its proposed changes involve the repositioning of a number of gaming machines and Touchbet Roulette terminals
- (b) The creation of the VIP gaming area, Privé, was implemented at the request of customers, but it has not been a success, and customers have asked that the area be opened up again
- (c) If Privé is opened up, it will improve the flow and access for customers and will make it easier for staff to check patrons from a harm minimisation perspective

The Secretary's submissions

5 The Secretary had no regulatory concerns with CCL's application

Analysis

6 CCL applied for approval to reposition a number of gaming machines at the Christchurch casino, and to reconfigure the Touchbet terminals used for electronic roulette. These amendments raise no issues of regulatory concern for the Secretary, or the Commission.

Decision of the Commission

7 The Commission decided:

- (a) to approve, under conditions 11 and 12 of CCL's operator's licence, floor plan "September 2009" (**attached**);



(b) that current floor plan "March 2009" ceases to be valid

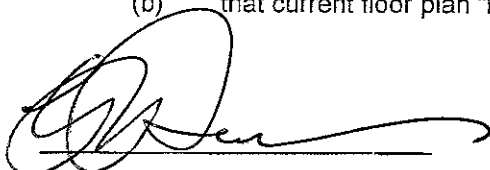

Graeme Reeves
Gambling Commissioner

for and on behalf of the
Gambling Commission

92nd October 2009



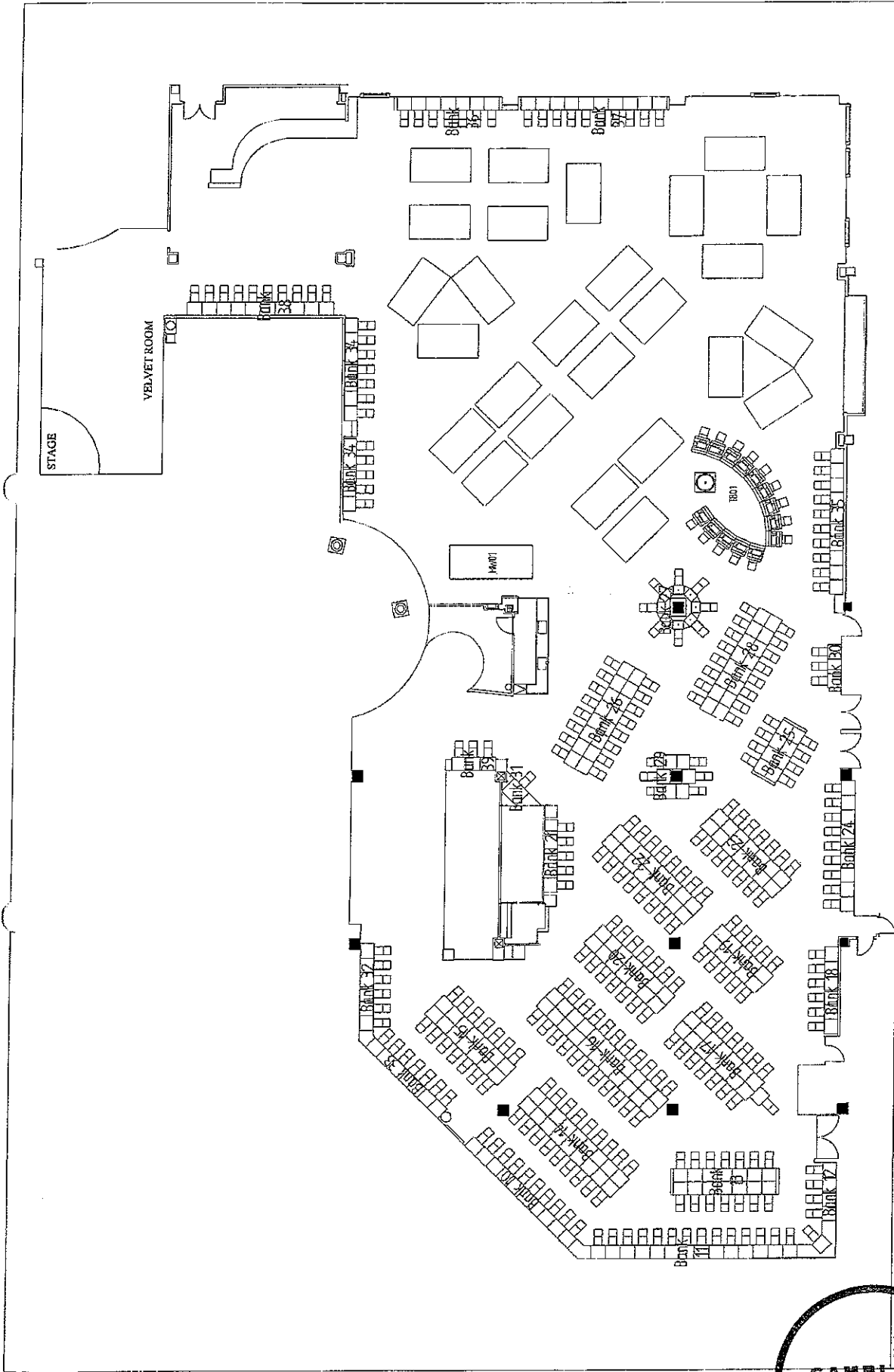

DATE: SEPTEMBER 2009
SCALE 1:250

LEVEL 3 - floor plan
309 MACHINES, 28 TABLES

Christchurch Casinos Limited
Stuart Scott



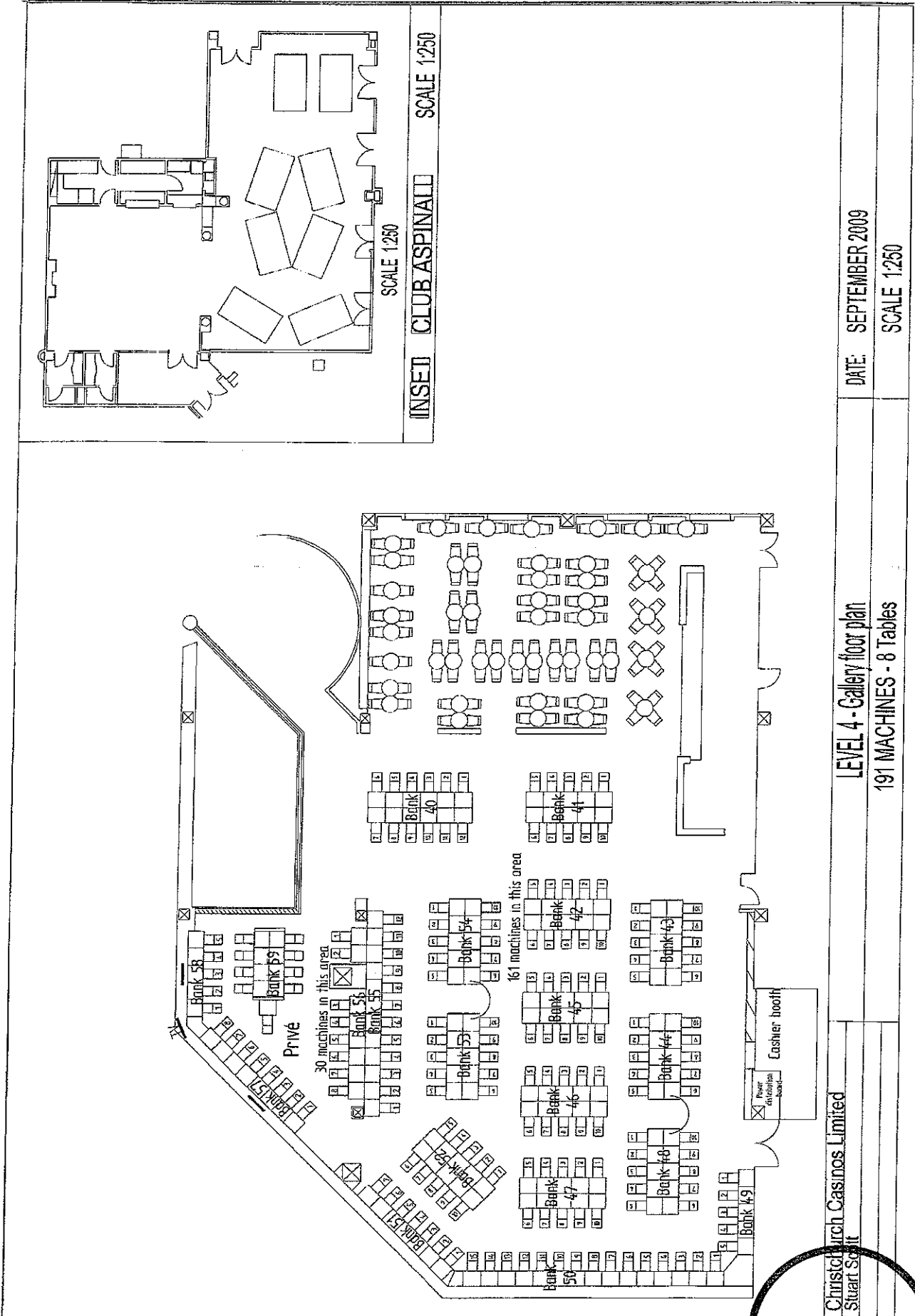

DATE: SEPTEMBER 2009

SCALE 1:250



Christchurch Casinos Limited
Stuart Scott