

IN THE MATTER of the Gambling Act 2003
AND on an application by
CHRISTCHURCH
CASINOS LIMITED for
approval of new floor plans
and game mixes

BEFORE THE GAMBLING COMMISSION

Members: P Chin (Chief Gambling Commissioner)
M M Lythe
P J Stanley
G L Reeves
M J Richardson

Date of Applications: 23 October 2008

Date of Decision: 5 December 2008

Date of Notification of Decision: 10 December 2008

**DECISION ON AN APPLICATION BY CHRISTCHURCH CASINOS LIMITED
FOR APPROVAL OF NEW FLOOR PLANS AND NEW GAME MIXES**

Application

1. Christchurch Casinos Limited ("**CCL**") applied to the Gambling Commission (the "**Commission**"), under condition 1 of its venue licence, for approval of:
 - (a) new floor plans for the Christchurch casino;
 - (b) new game mixes, H, I, J and K.
2. If the new game mixes are approved, the following game mixes would be available:

A large, stylized handwritten signature in black ink, consisting of several loops and a long horizontal stroke extending to the right.

Game mix	A	B	C	D	E	F	G	H	I	J	K
Roulette	9	8	8	9	8	8	8	8	8	8	8
Black Jack (7-box)	14	8	11	11	12	9	10	11	9	9	9
Black Jack (5-box)	0	0	0	0	0	0	2	0	2	0	0
Caribbean Stud Poker	3	3	3	3	3	2	2	2	2	2	2
Midi Baccarat	3	4	4	4	4	4	5	5	5	5	5
Mini Baccarat	1	1	1	1	1	1	1	1	1	0	1
Money Wheel	1	1	1	1	1	1	1	1	1	1	1
Poker	2	7	4	3	3	7	3	4	4	7	7
Tai Sai	1	1	1	1	1	1	1	1	1	1	0
Electronic Roulette		1	1	1	1	1	1	1	1	1	1
Total	34	34	34	34	34	34	34	34	34	34	34

Licence condition

3. Condition 1 of CCL's venue licence (as amended by the Commission by decision GC06/04) provides as follows:

Casino premises to be designed, developed, constructed, fitted out and commissioned for operation in accordance with application

The casino premises shall be designed, developed, constructed, fitted out and commissioned for operation generally in accordance with the application of the licence holder or with such changes as may from time to time be approved by the Commission, provided however that nothing in this condition shall apply in respect of any matter specified in the second schedule to the Casino Control Act 1990 (the "Act").

Submissions by CCL

4. CCL stated that:
- (a) it seeks approval of new floor plans for the Christchurch casino, following customer feedback on layout of gaming machines on Level 3;
 - (b) the most significant changes will be the reorientation of Bank 26 and the relocation of three gaming machines from Bank 34. Other gaming machines will either be added or removed from various banks on Level 3;
 - (c) it wants to introduce four new game mixes, H, I, J and K, to provide it with greater game mix flexibility.

5. CCL submitted that:

- (a) the new game mixes will not increase opportunities for casino gambling as they have fewer player spaces and a slower rate of play than game mix A, the regulatory benchmark for the Christchurch casino, as follows:

	Game mix A	Game mix H	Game mix I	Game mix J	Game mix K
Player numbers	662	659	647	626	635
Rounds per hour	1608	1542	1542	1546	1570

- (b) Should the Commission approve its applications, the current operational floor plans (approved in decision GC16/08 and entitled "September 2008") can be deleted.

Submissions by the Secretary

6. The Secretary submitted that he had no concern with the proposed reconfiguration of the gaming machines, and concurred with CCL's submission that the new game mixes will not increase opportunities for casino gambling.

Analysis

7. The relocation of the gaming machines on Level 3, as proposed by CCL raises no issues of regulatory concern.
8. CCL presently has seven approved game mixes and seeks approval to introduce four new game mixes. The Commission's approach when determining whether a new game mix may result in an increase in opportunities for casino gambling is to compare what is proposed against the game mix that provides the greatest level of opportunities for casino gambling. Game mix A presently provides the greatest level of opportunities to gamble.
9. The Commission compared proposed game mixes H, I, J and K with game mix A. The Commission did not adopt the game speed/rounds analysis submitted by CCL. It regards the underlying game speed data as less than ideal and noted some errors in the CCL calculations applying the data. However the Commission agreed that the new game mixes would involve fewer player spaces than game mix A and, as it did not appear that there would be any overall increase from game speed considerations, it concluded that the new game mixes would not increase opportunities for casino gambling compared to game mix A.
10. The deletion of the current operational floor plans "September 2008" raises no issues of regulatory concern.

Decision of Commission

11. The Commission decided:

- (a) to approve the new floor plans (which the Commission has labelled "December 2008") (**attached**), under condition 1 of CCL's venue licence;
- (b) to approve game mixes H, I, J and K, under condition 1 of CCL's venue licence.

(c) that floor plans "September 2008" will cease to be valid once CCL is fully reliant on plans "December 2008".

Peter Chin
Chief Gambling Commissioner
for and on behalf of the
Gambling Commission

10 December 2008

ANNEXURE

Pursuant to condition 1 of CCL's venue licence, the following table game mixes may be operated by the Licence Holder on casino gaming tables, subject to the following conditions and requirements:

- (a) Roulette – 9 games
Black Jack (7-box) – 14 games
Caribbean Stud Poker – 3 games
Midi Baccarat – 3 games
Mini Baccarat – 1 game
Money Wheel – 1 game
Poker – 2 games
Tai Sai – 1 game
- (b) Roulette – 8 games
Black Jack (7-box) – 8 games
Caribbean Stud Poker – 3 games
Midi Baccarat – 4 games
Mini Baccarat – 1 game
Money Wheel – 1 game
Poker – 7 games
Tai Sai – 1 game
Electronic Roulette – 1 game
- (c) Roulette – 8 games
Black Jack (7-box) – 11 games
Caribbean Stud Poker – 3 games
Midi Baccarat – 4 games
Mini Baccarat – 1 game
Money Wheel – 1 game
Poker – 4 games
Tai Sai – 1 game
Electronic Roulette – 1 game
- (d) Roulette – 9 games
Black Jack (7-box) – 11 games
Caribbean Stud Poker – 3 games
Midi Baccarat – 4 games
Mini Baccarat – 1 game
Money Wheel – 1 game
Poker – 3 games
Tai Sai – 1 game
Electronic Roulette – 1 game
- (e) Roulette – 8 games
Black Jack (7-box) – 12 games
Caribbean Stud Poker – 3 games
Midi Baccarat – 4 games
Mini Baccarat – 1 game
Money Wheel – 1 game
Poker – 3 games
Tai Sai – 1 game
Electronic Roulette – 1 game



- (f) Roulette – 8 games
Black Jack (7-box) – 9 games
Caribbean Stud Poker – 2 games
Midi Baccarat – 4 games
Mini Baccarat – 1 game
Money Wheel – 1 game
Poker – 7 games
Tai Sai (single) – 1 game
Electronic Roulette – 1 game
- (g) Roulette – 8 games
Black Jack (7-box) – 10 games
Black Jack (5-box) – 2 games
Caribbean Stud Poker – 2 games
Midi Baccarat – 5 games
Mini Baccarat – 1 game
Money Wheel – 1 game
Poker – 3 games
Tai Sai – 1 game
Electronic Roulette – 1 game
- (h) Roulette – 8 games
Black Jack (7-box) – 11 games
Caribbean Stud Poker – 2 games
Midi Baccarat – 5 games
Mini Baccarat – 1 game
Money Wheel – 1 game
Poker – 4 games
Tai Sai – 1 game
Electronic Roulette – 1 game
- (i) Roulette – 8 games
Black Jack (7-box) – 9 games
Black Jack (5-box) – 2 games
Caribbean Stud Poker – 2 games
Midi Baccarat – 5 games
Mini Baccarat – 1 game
Money Wheel – 1 game
Poker – 4 games
Tai Sai – 1 game
Electronic Roulette – 1 game
- (j) Roulette – 8 games
Black Jack (7-box) – 9 games
Caribbean Stud Poker – 2 games
Midi Baccarat – 5 games
Money Wheel – 1 game
Poker – 7 games
Tai Sai – 1 game
Electronic Roulette – 1 game



- (k) Roulette – 8 games
- Black Jack (7-box) – 9 games
- Caribbean Stud Poker – 2 games
- Midi Baccarat – 5 games
- Mini Baccarat – 1 game
- Money Wheel – 1 game
- Poker – 7 games
- Electronic Roulette – 1 game

Notes

- (a) The Licence Holder is permitted to change between the above approved table game mixes, subject to providing the inspectorate with weekly advice of the table game mix to be used for the forthcoming week, and five working days notice of any change from one approved game mix to another, except when alternating between table game mixes C and E, in which case the Licence Holder must telephone the local inspectorate prior to flipping.
- (b) The table game mixes refer (unless specified otherwise) to manual versions and do not extend to or permit the introduction of any electronic versions or new electronic aids or enhancements. If electronic versions, aids or enhancements are sought to be introduced, an application is required by the Licence Holder for approval of a revised floor layout and game mix.



December 2008

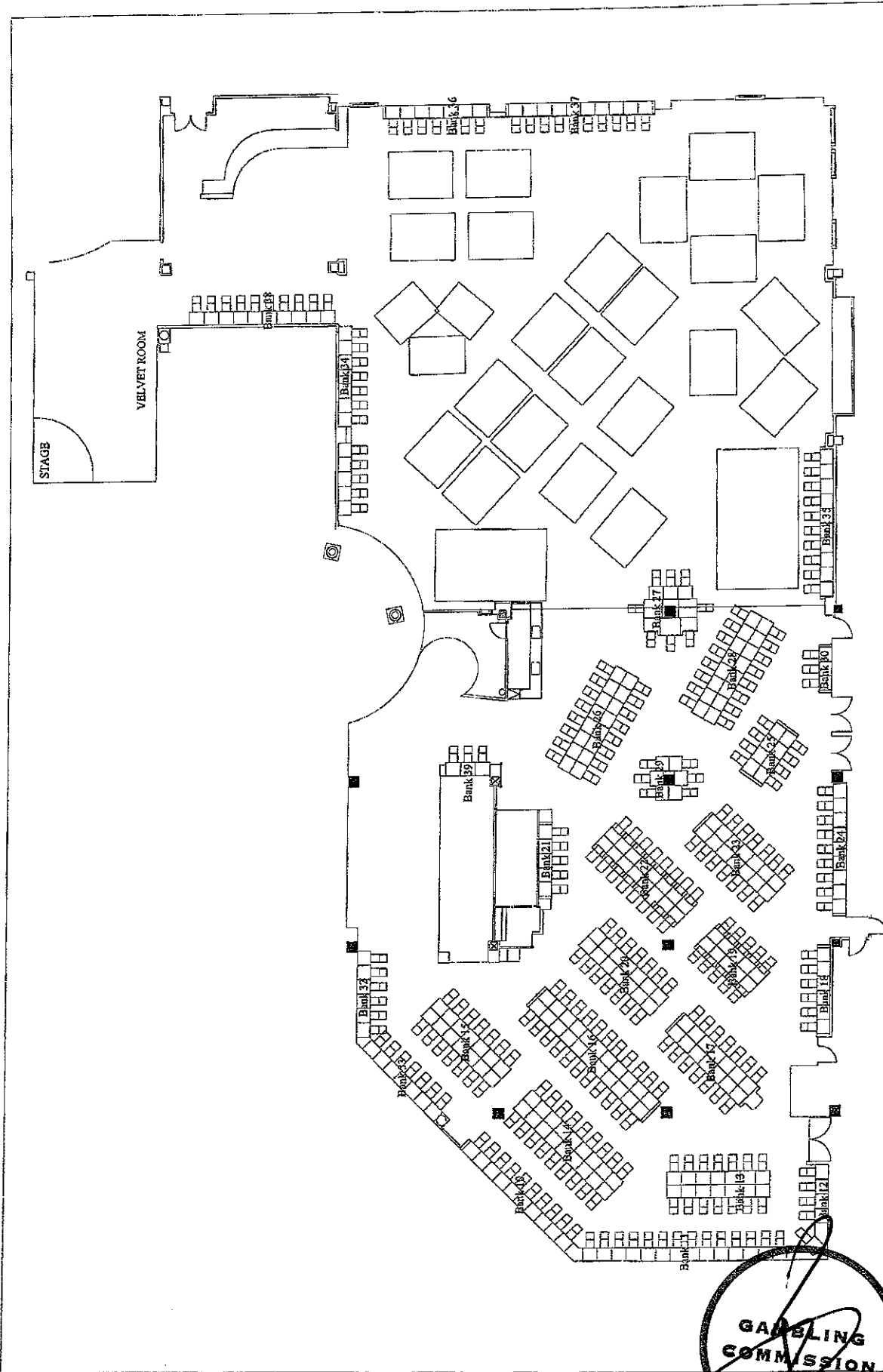

LEVEL 3 - floor plan
308 MACHINES, 27 TABLES

SCALE 1:250



Charlesworth Casinos Limited
Stuart Scott

December 2008

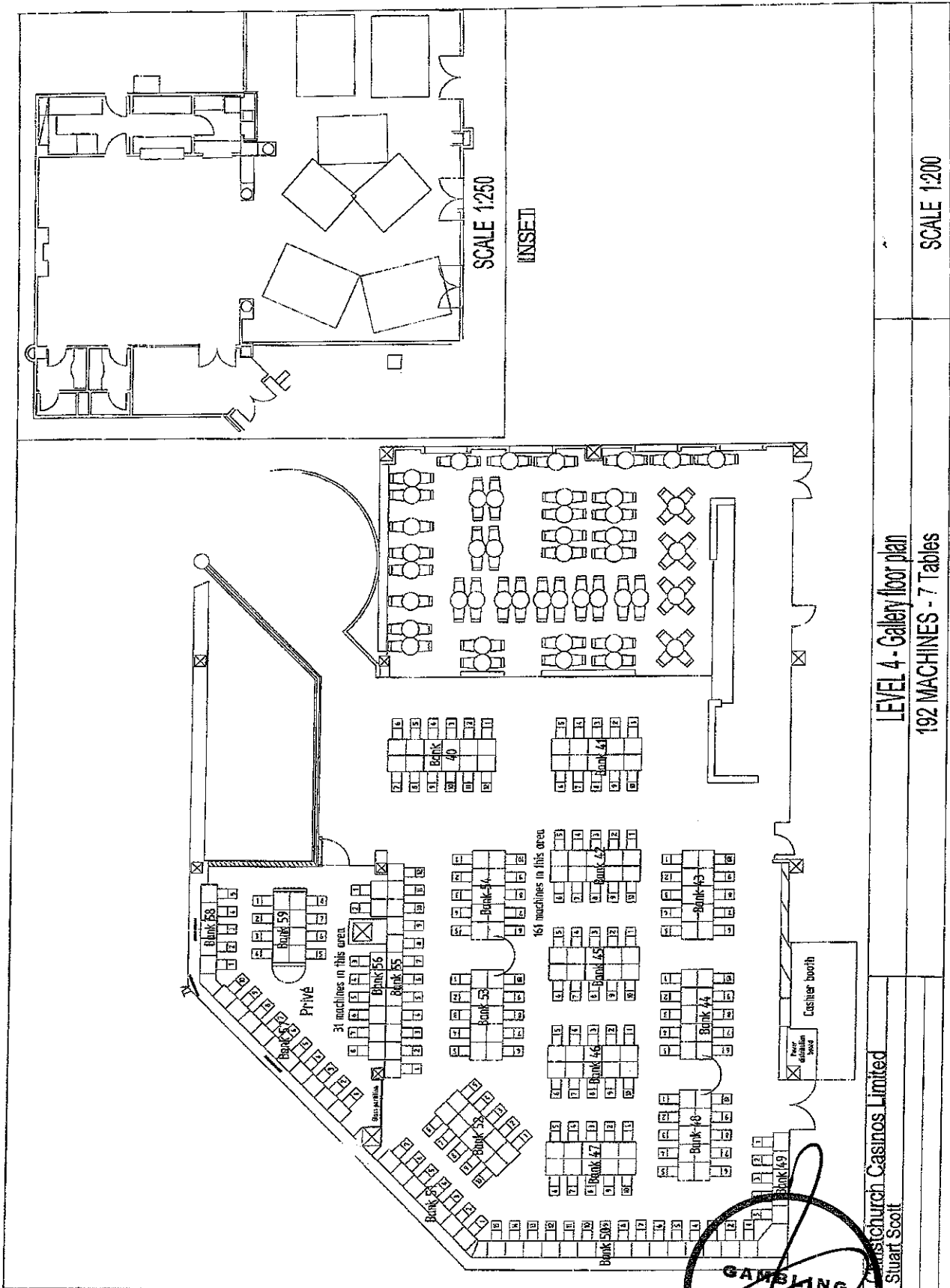

LEVEL 4 - Gallery floor plan
192 MACHINES - 7 Tables

Stuart Scott
Casinos Church Casinos Limited

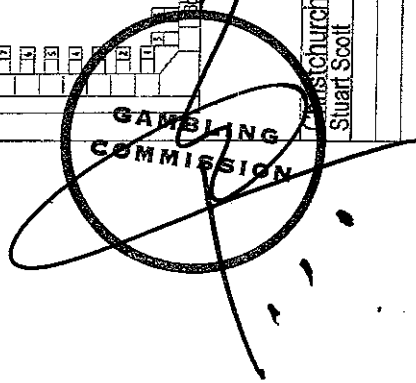

SCALE 1:200