

**IN THE MATTER** of the Gambling Act 2003  
**AND** of an application by  
**CHRISTCHURCH**  
**CASINOS LIMITED** for  
approval of temporary floor  
plans

**BEFORE THE GAMBLING COMMISSION**

Members: P Chin (Chief Gambling Commissioner)  
M M Lythe  
P J Stanley  
G L Reeves  
M J Richardson

Date of Application: 16 June 2008

Date of Decision: 18 July 2008

Date of Notification of Decision: 22 July 2008

**DECISION**

**ON AN APPLICATION BY CHRISTCHURCH CASINOS LIMITED  
FOR APPROVAL OF TEMPORARY FLOOR PLANS**

**Application**

1. Christchurch Casinos Limited ("**CCL**") applied to the Gambling Commission (the "**Commission**"), under condition 1 of its venue licence, for approval of temporary floor plans for Levels 3 and 4.

**Licence condition**

2. Condition 1 of CCL's venue licence (as amended by the Commission by decision GC06/04) provides as follows:

**Casino premises to be designed, developed, constructed, fitted out and commissioned for operation in accordance with application**

The casino premises shall be designed, developed, constructed, fitted out and commissioned for operation generally in accordance with the application of the licence holder or with such changes as may from time to time be approved by the Commission, provided however that nothing in this condition shall apply in respect of any matter specified in the second schedule to the Casino Control Act 1990 (the "**Act**").

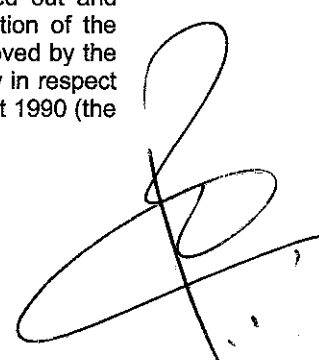

**Submissions by CCL**

3. CCL stated that:
- (a) Since the Commission approved temporary floor plans in decision GC06/08, its building contractors have advised that the refurbishment of the Christchurch casino could take up to 17 weeks to complete, rather than eight weeks as previously anticipated.
  - (b) Following this advice, it reviewed its gaming needs and seeks approval for new temporary floor plans to deploy during the refurbishment.
  - (c) The temporary floor plans involve the following changes:
    - (i) the temporary redesignation of the back half of the Diamond Bar as Gambling Area, and the placement of 18 gaming machines into this area;
    - (ii) the temporary placement of 18 gaming machines onto the main gaming floor outside the Diamond Bar;
    - (iii) the relocation of one gaming table from Level 3 to Level 4;
    - (iv) the temporary placement of 18 gaming machines onto the main gaming floor.
4. CCL submitted, in summary as follows:
- (a) the temporary floor plans will minimise disruption to patrons during the refurbishment, and allow it to maintain a high level of customer service; and
  - (b) the number of gaming machines and tables at the casino will never exceed approved levels, with additional gaming machines on Level 3 being installed only following the decommissioning of at least as many gaming machines on Level 4.

**Submissions by the Secretary**

5. The Secretary submitted that he was generally satisfied with CCL's proposal, but had some concerns, as follows:
- (a) Patrons playing on any of the 18 gaming machines in the back half of the Diamond Bar may not be well supervised by casino staff as the room is separate from the main gaming floor and not readily visible to casino employees. In reply, CCL submitted that patrons would be overseen in this area as they would elsewhere in the casino;

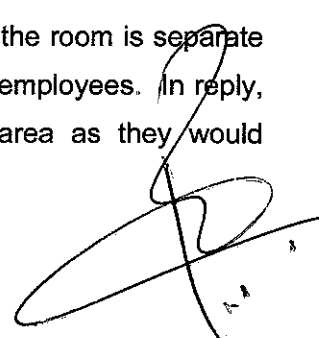

- (b) The placement of additional gaming machines on the main gaming floor and outside the Diamond Bar may result in staff and patron congestion, and suggested that the requirements of condition 8(e) of CCL's original venue licence (now repealed) be attached to the Commission's approval. This condition provides that all casino walkways must conform to fire and building regulations and have clearances of not less than 2.2 metres between parallel banks of machines and 2.5 metres for main perambulations within the gaming machine area. In reply, CCL submitted that it would meet these requirements;
- (c) That there may not be adequate camera coverage of CCL's proposed changes. In reply, CCL submitted that it would ensure that adequate camera coverage is maintained;
- (d) Each stage of the refurbishment need not to be approved by the Commission provided that his local inspectorate is provided with:
  - (i) 24 hours notice of any changes to camera positions, table games and/or gaming machines; and
  - (ii) current and accurate camera/game layout.

### **Analysis**

6. As the refurbishment of the Christchurch casino will take longer than originally anticipated, CCL has sought approval for new temporary floor plans to deploy during the refurbishment. The temporary plans depict a total of 552 gaming machines, well above CCL's permitted maximum. CCL will not simultaneously deploy all 552 gaming machines, rather the refurbishment will take place in stages with CCL introducing additional machines into one part of the casino, while removing machines from other parts, until the refurbishment is complete.
7. CCL has confirmed that at no stage will the number of gaming machines and gaming tables exceed approved levels, currently 500 gaming machines and 34 gaming tables.
8. The Secretary expressed concern about possible congestion at the casino with the proposed gaming machine layout. In order to address this, CCL submitted that in order to address the Secretary's concern, it would comply with the requirements of condition 8(e) of its original premises licence, even though that condition has been repealed and is of no effect. The Commission considers this prudent.

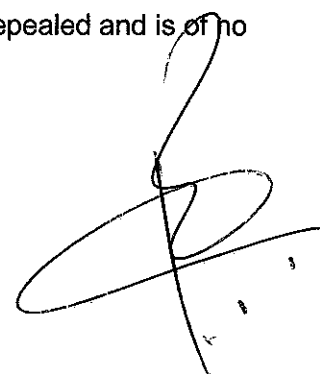
A large, stylized handwritten signature in black ink, located in the bottom right corner of the page. The signature is cursive and appears to be a name, possibly 'R. J. ...', with a long horizontal stroke at the bottom.

9. As the refurbishment of the casino will take place in stages, the Secretary requested that CCL provide the local inspectorate with accurate floor and camera plans, and be provided with 24 hours notice of any changes. The Commission considers this to be appropriate.
10. The Secretary did not express any concerns about the temporary redesignation of the back half of the Diamond Bar, and the Commission does not consider this to raise any issues of regulatory concern.

#### **Decision of Commission**

11. The Commission decided to approve the temporary floor plans for Levels 3 and 4 of the casino (**attached**), under condition 1 of the Applicant's venue licence. This approval is conditional on:
  - (a) all walkways within the casino conforming with fire and building regulations, and having clearances of not less than 2.2 metres between parallel banks of machines and 2.5m for main perambulations;
  - (b) no more than 34 tables and 500 gaming machines being deployed at any one time;
  - (c) CCL providing the local inspectorate with:
    - (i) 24 hours notice of any changes to camera positions, table games and/or gaming machines; and
    - (ii) current and accurate camera/game layout.
12. The temporary floor plans cease to be valid once CCL is fully reliant upon permanent floor plans B3 and B4, approved by the Commission in decision GC06/08.

13. The temporary floor plan approved in decision GC06/08 ceases to be valid from the date of this decision.

**GAMBLING  
COMMISSION**

**Peter Chin**  
Chief Gambling Commissioner

for and on behalf of the  
Gambling Commission

22 July 2008

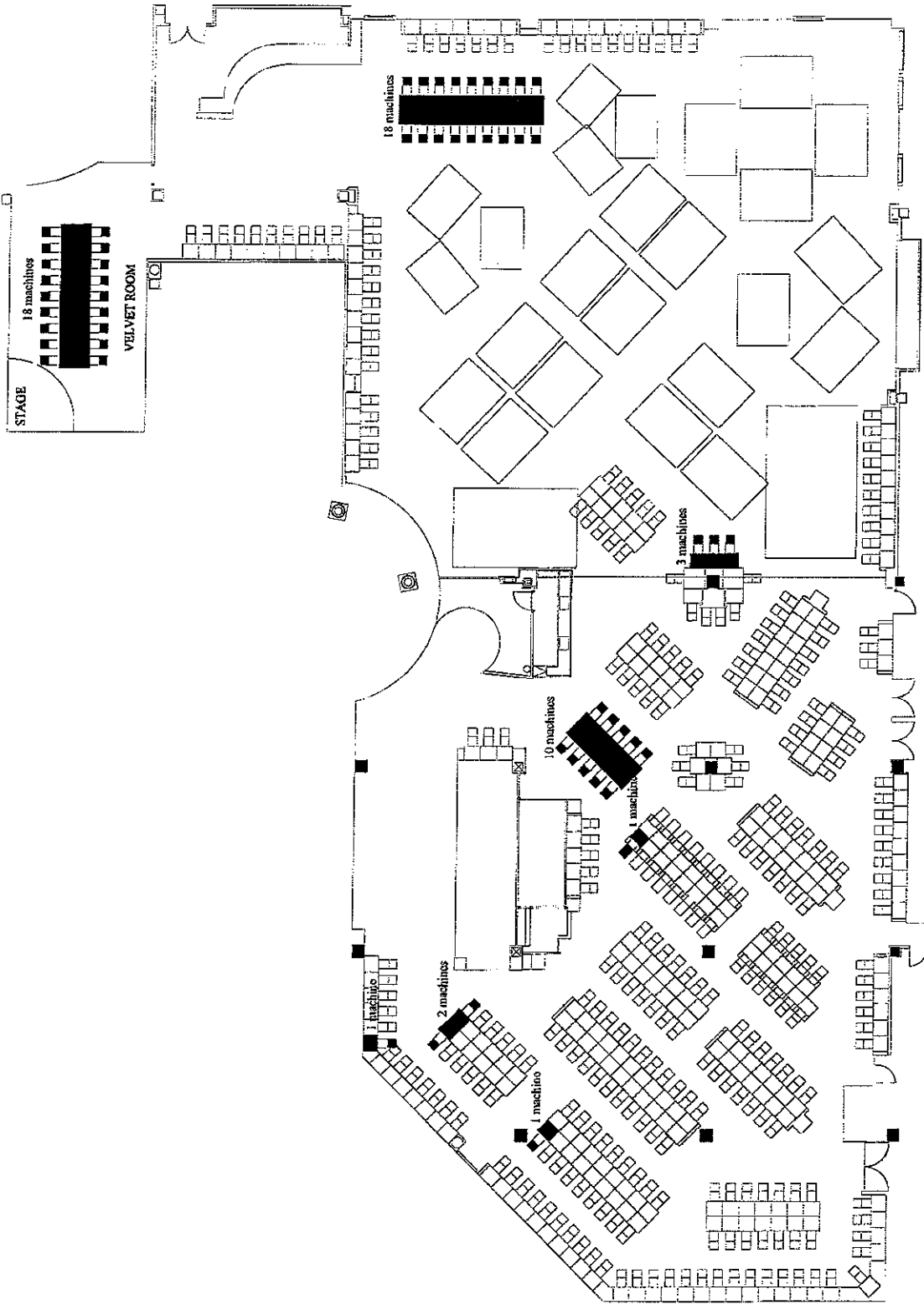

STAGE  
18 machines  
VELVET ROOM

18 machines

3 machines

10 machines

1 machine

2 machines

1 machine

Christchurch Casinos Limited  
Stuart Scott

**LEVEL 3 - Interim floor plan**

360 MACHINES, 26 TABLES

SCALE 1:250

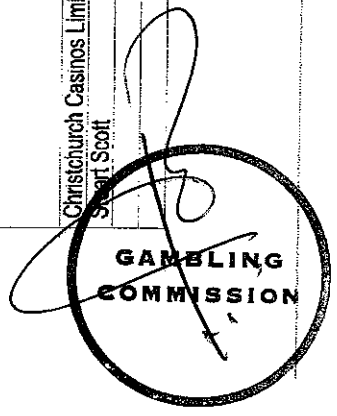

GAMBLING  
COMMISSION

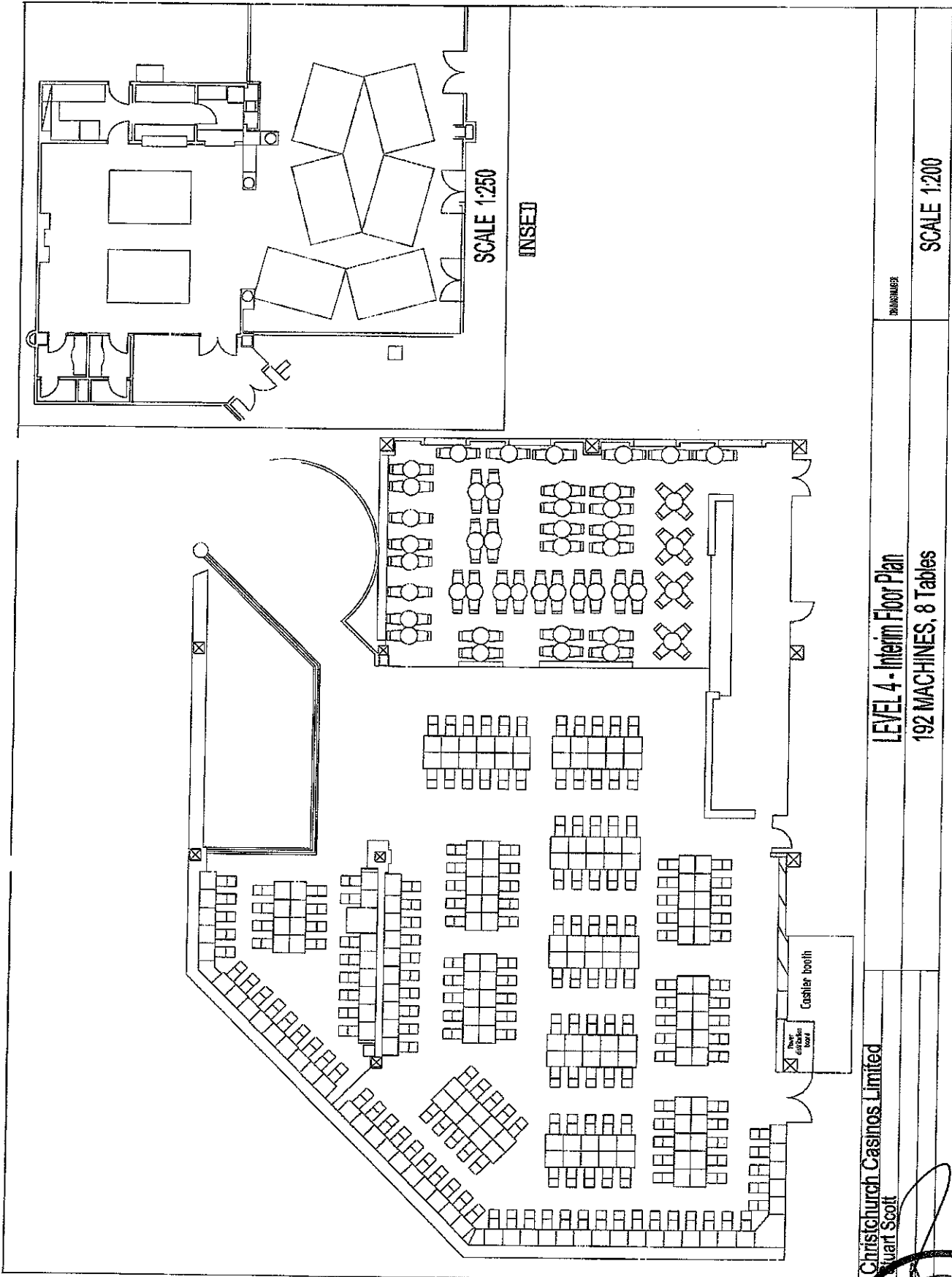

Christchurch Casinos Limited  
 Stuart Scott

LEVEL 4 - Interim Floor Plan  
 192 MACHINES, 8 Tables

DRAWN BY

SCALE 1:200

