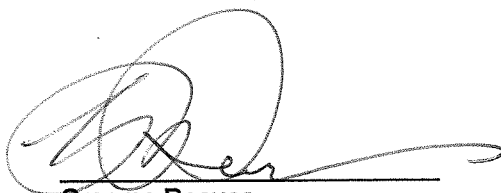

**DECISION UNDER DELEGATED AUTHORITY ON AN APPLICATION
BY SKYCITY CASINO MANAGEMENT LIMITED FOR APPROVAL OF
A NEW FLOOR PLAN FOR THE AUCKLAND CASINO**

Date of Decision: 25th July 2011

1. On 25 July 2011, SKYCITY Casino Management Limited ("**SCML**") applied, pursuant to condition 11 of its operator's licence for the Auckland casino, for approval of a new floor plan "July 2011 Temporary".
2. The variation sought was to substitute a Black Jack table and a Roulette table for two Baccarat tables in a VIP salon to the south of the lifts on level 5.
3. The application raises no issues the Commission needs to consider. Accordingly the new plans are approved by the Chief Gambling Commissioner and the Executive Director under delegated authority pursuant to condition 11 of SCML's operator's licence.
4. Plan "July 2011 Temporary" is **attached**.

Graeme Reeves
Chief Gambling Commissioner
Gambling Commission

25th July 2011

**GAMBLING
COMMISSION**

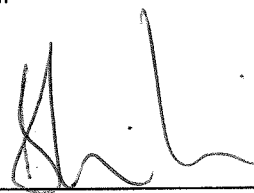
Blair Cairncross
Executive Director
Gambling Commission

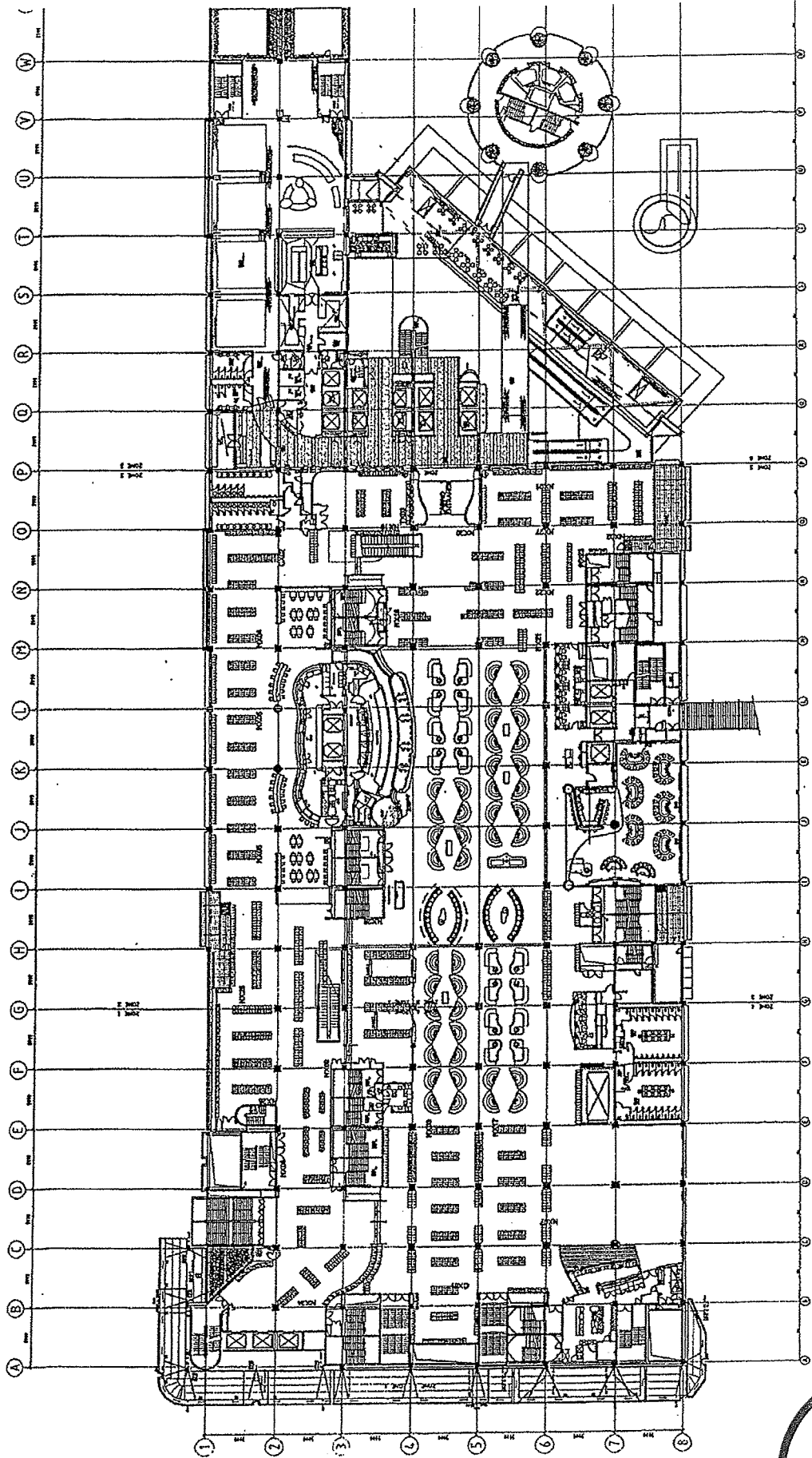

REVISIONS

NO.	DATE	DESCRIPTION
1	07/11/11	ISSUED FOR PERMIT
2	07/11/11	ISSUED FOR PERMIT
3	07/11/11	ISSUED FOR PERMIT
4	07/11/11	ISSUED FOR PERMIT
5	07/11/11	ISSUED FOR PERMIT
6	07/11/11	ISSUED FOR PERMIT
7	07/11/11	ISSUED FOR PERMIT
8	07/11/11	ISSUED FOR PERMIT
9	07/11/11	ISSUED FOR PERMIT
10	07/11/11	ISSUED FOR PERMIT

CLIENT AND PROJECT

Client: Sky City Entertainment Group
Project: Gaming Layouts
Address: 1234 Main Street, Suite 500, Denver, CO 80202
Phone: (303) 555-1234
Fax: (303) 555-5678
Email: info@skycity.com
Website: www.skycity.com

DESIGNER

Designer: Moller Architects
Address: 1234 Main Street, Suite 500, Denver, CO 80202
Phone: (303) 555-1234
Fax: (303) 555-5678
Email: info@moller.com
Website: www.moller.com

PROJECT INFORMATION

Project Name: Sky City Entertainment Group Gaming Layouts
Project Number: SKY-2011-001
Project Date: 07/11/11
Project Status: Issued for Permit

DESIGNED TITLE

Level 2 Gaming Layout
SKYCITY
DIA 12 Diamond Room Hoarding

REVISIONS

NO.	DATE	DESCRIPTION
1	07/11/11	ISSUED FOR PERMIT
2	07/11/11	ISSUED FOR PERMIT
3	07/11/11	ISSUED FOR PERMIT
4	07/11/11	ISSUED FOR PERMIT
5	07/11/11	ISSUED FOR PERMIT
6	07/11/11	ISSUED FOR PERMIT
7	07/11/11	ISSUED FOR PERMIT
8	07/11/11	ISSUED FOR PERMIT
9	07/11/11	ISSUED FOR PERMIT
10	07/11/11	ISSUED FOR PERMIT

SCALE

1" = 10'-0"



moller architects

1234 Main Street, Suite 500
Denver, CO 80202
Phone: (303) 555-1234
Fax: (303) 555-5678
Email: info@moller.com
Website: www.moller.com

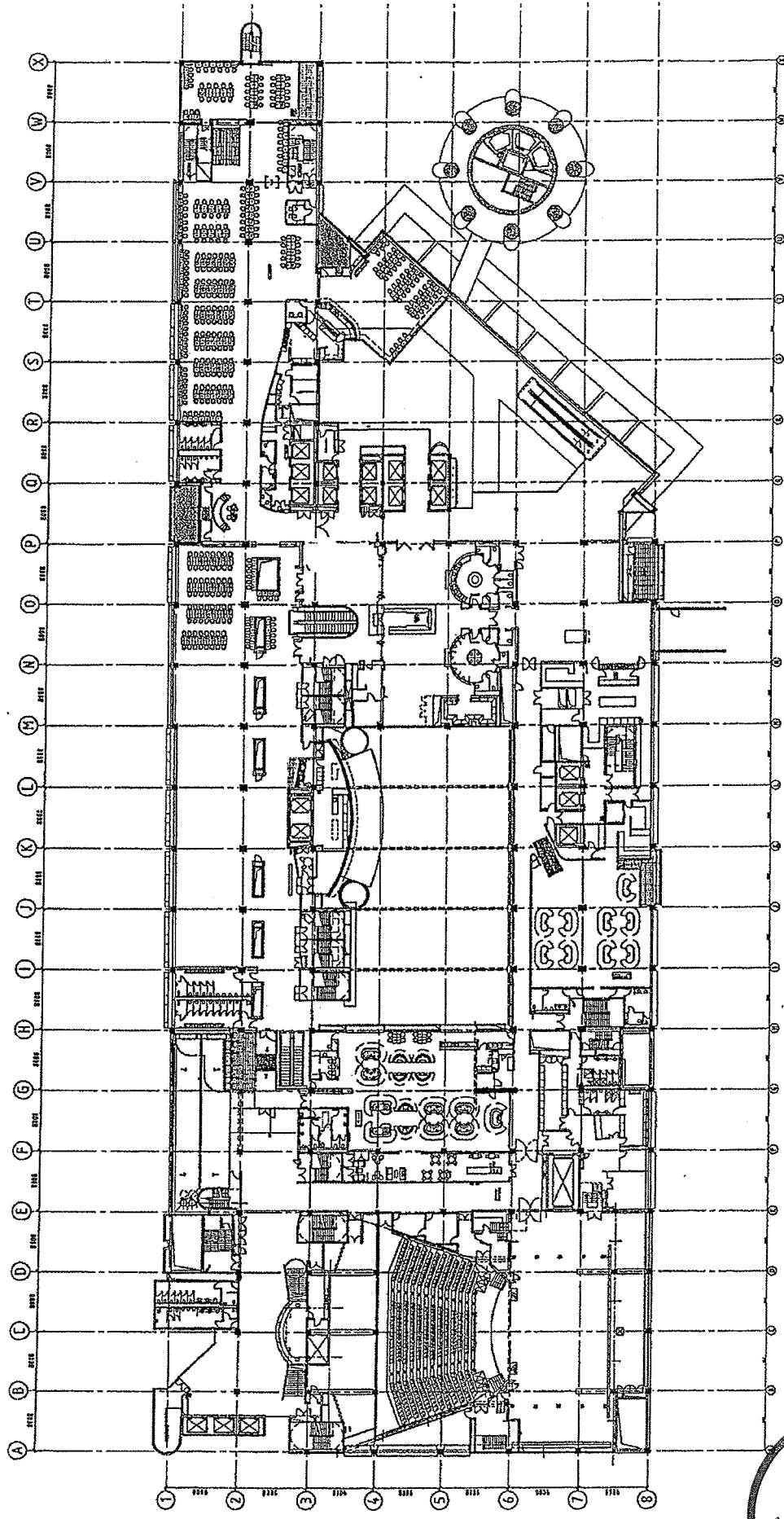
[illegible][illegible]

SKY CITY
ENTERTAINMENT GROUP
Gaming Layouts

Call +64 9 3570834
Fax +64 9 3570859
Email: info@v3.com
Web: www.v3.com

Moller Architects.

Fortuna Stage 2 DIA 4/07/2011

5132C	A1205	B
-------	-------	---

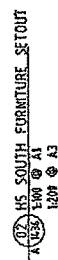

SKYCITY
LEVEL H4, H5 & H6
New VIP Gaming for
SKYCITY
SKYCITY

1. DATE OF BIRTH _____
 2. DATE OF DEATH _____
 3. DATE OF BURIAL _____
 4. DATE OF CREMATION _____
 5. DATE OF INTERMENT _____
 6. DATE OF REINTERMENT _____
 7. DATE OF EXHUMATION _____
 8. DATE OF REINTERMENT _____
 9. DATE OF EXHUMATION _____
 10. DATE OF REINTERMENT _____
 11. DATE OF EXHUMATION _____
 12. DATE OF REINTERMENT _____
 13. DATE OF EXHUMATION _____
 14. DATE OF REINTERMENT _____
 15. DATE OF EXHUMATION _____
 16. DATE OF REINTERMENT _____
 17. DATE OF EXHUMATION _____
 18. DATE OF REINTERMENT _____
 19. DATE OF EXHUMATION _____
 20. DATE OF REINTERMENT _____
 21. DATE OF EXHUMATION _____
 22. DATE OF REINTERMENT _____
 23. DATE OF EXHUMATION _____
 24. DATE OF REINTERMENT _____
 25. DATE OF EXHUMATION _____
 26. DATE OF REINTERMENT _____
 27. DATE OF EXHUMATION _____
 28. DATE OF REINTERMENT _____
 29. DATE OF EXHUMATION _____
 30. DATE OF REINTERMENT _____
 31. DATE OF EXHUMATION _____
 32. DATE OF REINTERMENT _____
 33. DATE OF EXHUMATION _____
 34. DATE OF REINTERMENT _____
 35. DATE OF EXHUMATION _____
 36. DATE OF REINTERMENT _____
 37. DATE OF EXHUMATION _____
 38. DATE OF REINTERMENT _____
 39. DATE OF EXHUMATION _____
 40. DATE OF REINTERMENT _____
 41. DATE OF EXHUMATION _____
 42. DATE OF REINTERMENT _____
 43. DATE OF EXHUMATION _____
 44. DATE OF REINTERMENT _____
 45. DATE OF EXHUMATION _____
 46. DATE OF REINTERMENT _____
 47. DATE OF EXHUMATION _____
 48. DATE OF REINTERMENT _____
 49. DATE OF EXHUMATION _____
 50. DATE OF REINTERMENT _____
 51. DATE OF EXHUMATION _____
 52. DATE OF REINTERMENT _____
 53. DATE OF EXHUMATION _____
 54. DATE OF REINTERMENT _____
 55. DATE OF EXHUMATION _____
 56. DATE OF REINTERMENT _____
 57. DATE OF EXHUMATION _____
 58. DATE OF REINTERMENT _____
 59. DATE OF EXHUMATION _____
 60. DATE OF REINTERMENT _____
 61. DATE OF EXHUMATION _____
 62. DATE OF REINTERMENT _____
 63. DATE OF EXHUMATION _____
 64. DATE OF REINTERMENT _____
 65. DATE OF EXHUMATION _____
 66. DATE OF REINTERMENT _____
 67. DATE OF EXHUMATION _____
 68. DATE OF REINTERMENT _____
 69. DATE OF EXHUMATION _____
 70. DATE OF REINTERMENT _____
 71. DATE OF EXHUMATION _____
 72. DATE OF REINTERMENT _____
 73. DATE OF EXHUMATION _____
 74. DATE OF REINTERMENT _____
 75. DATE OF EXHUMATION _____
 76. DATE OF REINTERMENT _____
 77. DATE OF EXHUMATION _____
 78. DATE OF REINTERMENT _____
 79. DATE OF EXHUMATION _____
 80. DATE OF REINTERMENT _____
 81. DATE OF EXHUMATION _____
 82. DATE OF REINTERMENT _____
 83. DATE OF EXHUMATION _____
 84. DATE OF REINTERMENT _____
 85. DATE OF EXHUMATION _____
 86. DATE OF REINTERMENT _____
 87. DATE OF EXHUMATION _____
 88. DATE OF REINTERMENT _____
 89. DATE OF EXHUMATION _____
 90. DATE OF REINTERMENT _____
 91. DATE OF EXHUMATION _____
 92. DATE OF REINTERMENT _____
 93. DATE OF EXHUMATION _____
 94. DATE OF REINTERMENT _____
 95. DATE OF EXHUMATION _____
 96. DATE OF REINTERMENT _____
 97. DATE OF EXHUMATION _____
 98. DATE OF REINTERMENT _____
 99. DATE OF EXHUMATION _____
 100. DATE OF REINTERMENT _____

FURNITURE PLANS

DIA. VERSION

LEVEL 4
COUNTY

SOUTH

[illegible]

A5255

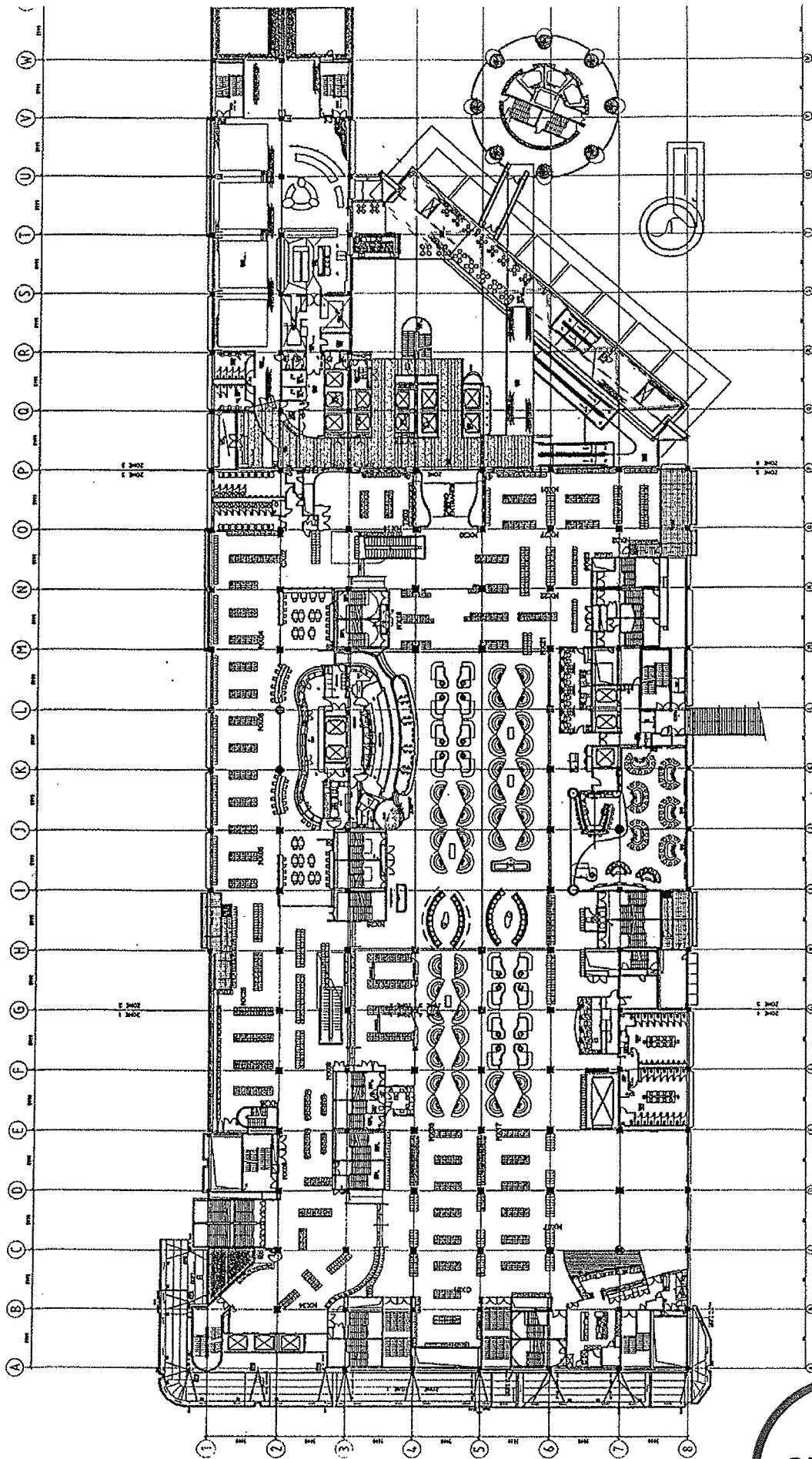

1	2	3	4	5	6	7	8	9	10	11	12	13	14	15	16	17	18	19	20	21	22	23	24	25	26	27	28	29	30	31	32	33	34	35	36	37	38	39	40	41	42	43	44	45	46	47	48	49	50	51	52	53	54	55	56	57	58	59	60	61	62	63	64	65	66	67	68	69	70	71	72	73	74	75	76	77	78	79	80	81	82	83	84	85	86	87	88	89	90	91	92	93	94	95	96	97	98	99	100
1	2	3	4	5	6	7	8	9	10	11	12	13	14	15	16	17	18	19	20	21	22	23	24	25	26	27	28	29	30	31	32	33	34	35	36	37	38	39	40	41	42	43	44	45	46	47	48	49	50	51	52	53	54	55	56	57	58	59	60	61	62	63	64	65	66	67	68	69	70	71	72	73	74	75	76	77	78	79	80	81	82	83	84	85	86	87	88	89	90	91	92	93	94	95	96	97	98	99	100
1	2	3	4	5	6	7	8	9	10	11	12	13	14	15	16	17	18	19	20	21	22	23	24	25	26	27	28	29	30	31	32	33	34	35	36	37	38	39	40	41	42	43	44	45	46	47	48	49	50	51	52	53	54	55	56	57	58	59	60	61	62	63	64	65	66	67	68	69	70	71	72	73	74	75	76	77	78	79	80	81	82	83	84	85	86	87	88	89	90	91	92	93	94	95	96	97	98	99	100
1	2	3	4	5	6	7	8	9	10	11	12	13	14	15	16	17	18	19	20	21	22	23	24	25	26	27	28	29	30	31	32	33	34	35	36	37	38	39	40	41	42	43	44	45	46	47	48	49	50	51	52	53	54	55	56	57	58	59	60	61	62	63	64	65	66	67	68	69	70	71	72	73	74	75	76	77	78	79	80	81	82	83	84	85	86	87	88	89	90	91	92	93	94	95	96	97	98	99	100
1	2	3	4	5	6	7	8	9	10	11	12	13	14	15	16	17	18	19	20	21	22	23	24	25	26	27	28	29	30	31	32	33	34	35	36	37	38	39	40	41	42	43	44	45	46	47	48	49	50	51	52	53	54	55	56	57	58	59	60	61	62	63	64	65	66	67	68	69	70	71	72	73	74	75	76	77	78	79	80	81	82	83	84	85	86	87	88	89	90	91	92	93	94	95	96	97	98	99	100
1	2	3	4	5	6	7	8	9	10	11	12	13</																																																																																							

REV	DESCRIPTION	DATE	BY	CHK
01	R1933 CHANG SACHO (A001)			
02	REV 04/01/01			
03	REV 04/01/01			
04	REV 04/01/01			
05	REV 04/01/01			
06	REV 04/01/01			
07	REV 04/01/01			
08	REV 04/01/01			
09	REV 04/01/01			
10	REV 04/01/01			
11	REV 04/01/01			
12	REV 04/01/01			
13	REV 04/01/01			
14	REV 04/01/01			
15	REV 04/01/01			
16	REV 04/01/01			
17	REV 04/01/01			
18	REV 04/01/01			
19	REV 04/01/01			
20	REV 04/01/01			
21	REV 04/01/01			
22	REV 04/01/01			
23	REV 04/01/01			
24	REV 04/01/01			
25	REV 04/01/01			
26	REV 04/01/01			
27	REV 04/01/01			
28	REV 04/01/01			
29	REV 04/01/01			
30	REV 04/01/01			
31	REV 04/01/01			
32	REV 04/01/01			
33	REV 04/01/01			
34	REV 04/01/01			
35	REV 04/01/01			
36	REV 04/01/01			
37	REV 04/01/01			
38	REV 04/01/01			
39	REV 04/01/01			
40	REV 04/01/01			
41	REV 04/01/01			
42	REV 04/01/01			
43	REV 04/01/01			
44	REV 04/01/01			
45	REV 04/01/01			
46	REV 04/01/01			
47	REV 04/01/01			
48	REV 04/01/01			
49	REV 04/01/01			
50	REV 04/01/01			
51	REV 04/01/01			
52	REV 04/01/01			
53	REV 04/01/01			
54	REV 04/01/01			
55	REV 04/01/01			
56	REV 04/01/01			
57	REV 04/01/01			
58	REV 04/01/01			
59	REV 04/01/01			
60	REV 04/01/01			
61	REV 04/01/01			
62	REV 04/01/01			
63	REV 04/01/01			
64	REV 04/01/01			
65	REV 04/01/01			
66	REV 04/01/01			
67	REV 04/01/01			
68	REV 04/01/01			
69	REV 04/01/01			
70	REV 04/01/01			
71	REV 04/01/01			
72	REV 04/01/01			
73	REV 04/01/01			
74	REV 04/01/01			
75	REV 04/01/01			
76	REV 04/01/01			
77	REV 04/01/01			
78	REV 04/01/01			
79	REV 04/01/01			
80	REV 04/01/01			
81	REV 04/01/01			
82	REV 04/01/01			
83	REV 04/01/01			
84	REV 04/01/01			
85	REV 04/01/01			
86	REV 04/01/01			
87	REV 04/01/01			
88	REV 04/01/01			
89	REV 04/01/01			
90	REV 04/01/01			
91	REV 04/01/01			
92	REV 04/01/01			
93	REV 04/01/01			
94	REV 04/01/01			
95	REV 04/01/01			
96	REV 04/01/01			
97	REV 04/01/01			
98	REV 04/01/01			
99	REV 04/01/01			
100	REV 04/01/01			

5132C

1202 M

DRAWING NO.

Level 2 Gaming Layout
SKY CITY
DIA 12 Diamond Room Hoarding

* Refer to Section 1 for Diagram Symbols
 Main Contractor shall verify all dimensions before commencing work.
 This drawing shall not be used in conjunction with all relevant documents.
 Copyright © Engho Only under Licensee Limited 2002

[illegible]

Sky City Entertainment Group
Gaming Layouts

Call +84 9 35700005
Fax +84 9 35700009

MEHL. Moller Architects®

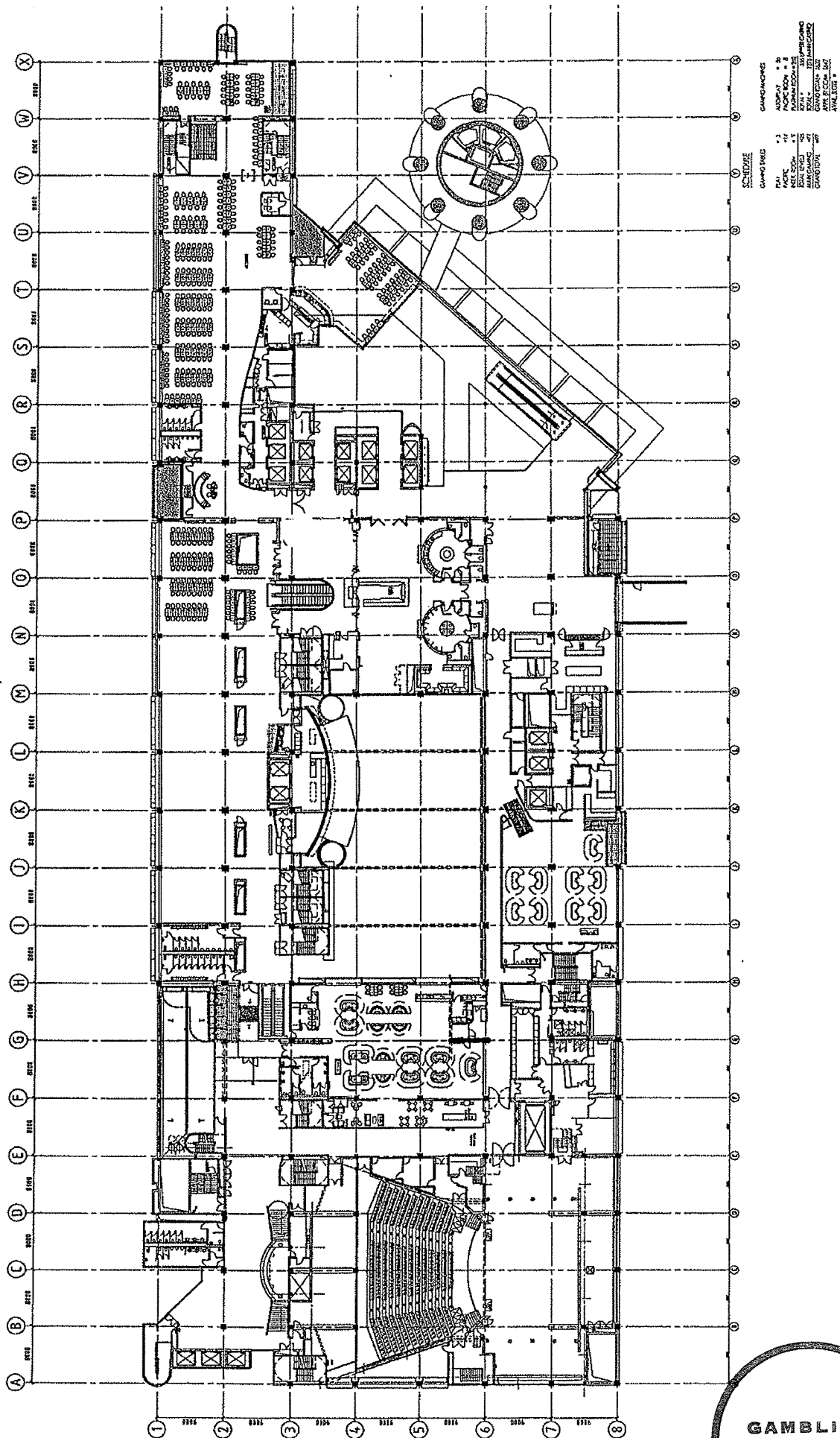
[illegible]

moller.
Moller
Architects
200-454-8300
200-454-8300
200-454-8300
200-454-8300

SKY CITY
LEVEL H4, H5 & H6
New VIP Gaming for
SkyCity

SKY CITY
LEVEL H4, H5 & H6
New VIP Gaming for
SkyCity

FURNITURE PLANS
DIA. VERSION
LEVEL H5
SOUTH

NO.	DESCRIPTION	QTY	UNIT	REMARKS
1	BAR	1	EA	
2	BAR	1	EA	
3	BAR	1	EA	
4	BAR	1	EA	
5	BAR	1	EA	
6	BAR	1	EA	
7	BAR	1	EA	
8	BAR	1	EA	
9	BAR	1	EA	
10	BAR	1	EA	
11	BAR	1	EA	
12	BAR	1	EA	
13	BAR	1	EA	
14	BAR	1	EA	
15	BAR	1	EA	
16	BAR	1	EA	
17	BAR	1	EA	
18	BAR	1	EA	
19	BAR	1	EA	
20	BAR	1	EA	
21	BAR	1	EA	
22	BAR	1	EA	
23	BAR	1	EA	
24	BAR	1	EA	
25	BAR	1	EA	
26	BAR	1	EA	
27	BAR	1	EA	
28	BAR	1	EA	
29	BAR	1	EA	
30	BAR	1	EA	
31	BAR	1	EA	
32	BAR	1	EA	
33	BAR	1	EA	
34	BAR	1	EA	
35	BAR	1	EA	
36	BAR	1	EA	
37	BAR	1	EA	
38	BAR	1	EA	
39	BAR	1	EA	
40	BAR	1	EA	
41	BAR	1	EA	
42	BAR	1	EA	
43	BAR	1	EA	
44	BAR	1	EA	
45	BAR	1	EA	
46	BAR	1	EA	
47	BAR	1	EA	
48	BAR	1	EA	
49	BAR	1	EA	
50	BAR	1	EA	
51	BAR	1	EA	
52	BAR	1	EA	
53	BAR	1	EA	
54	BAR	1	EA	
55	BAR	1	EA	
56	BAR	1	EA	
57	BAR	1	EA	
58	BAR	1	EA	
59	BAR	1	EA	
60	BAR	1	EA	
61	BAR	1	EA	
62	BAR	1	EA	
63	BAR	1	EA	
64	BAR	1	EA	
65	BAR	1	EA	
66	BAR	1	EA	
67	BAR	1	EA	
68	BAR	1	EA	
69	BAR	1	EA	
70	BAR	1	EA	
71	BAR	1	EA	
72	BAR	1	EA	
73	BAR	1	EA	
74	BAR	1	EA	
75	BAR	1	EA	
76	BAR	1	EA	
77	BAR	1	EA	
78	BAR	1	EA	
79	BAR	1	EA	
80	BAR	1	EA	
81	BAR	1	EA	
82	BAR	1	EA	
83	BAR	1	EA	
84	BAR	1	EA	
85	BAR	1	EA	
86	BAR	1	EA	
87	BAR	1	EA	
88	BAR	1	EA	
89	BAR	1	EA	
90	BAR	1	EA	
91	BAR	1	EA	
92	BAR	1	EA	
93	BAR	1	EA	
94	BAR	1	EA	
95	BAR	1	EA	
96	BAR	1	EA	
97	BAR	1	EA	
98	BAR	1	EA	
99	BAR	1	EA	
100	BAR	1	EA	

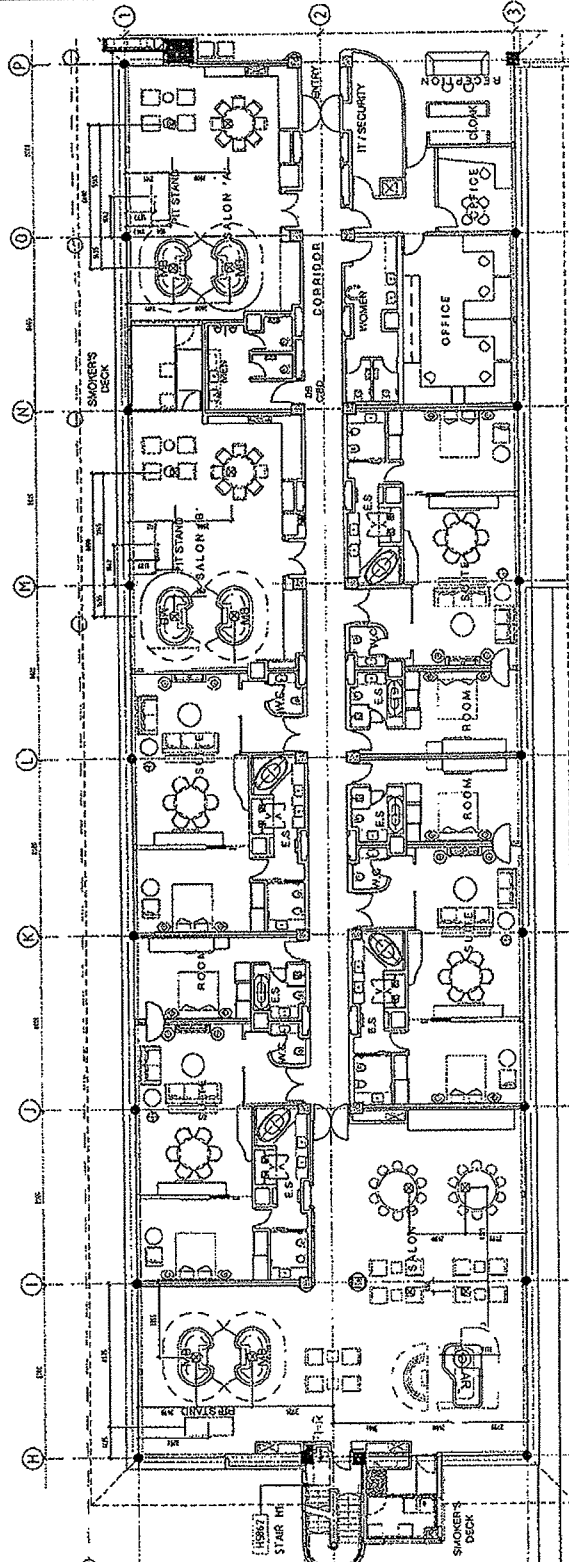

42 H5 SOUTH FURNITURE SETOUT
A 1/8" = 1'-0" @ A1
1/8" = 1'-0" @ A3



