

**DECISION UNDER DELEGATED AUTHORITY ON AN APPLICATION
BY SKYCITY CASINO MANAGEMENT LIMITED FOR APPROVAL
OF NEW FLOOR PLANS FOR THE AUCKLAND CASINO**

Date of Decision: 2 February 2011

1. On 27 January 2011, SKYCITY Casino Management Limited ("SCML") applied, pursuant to condition 11 of its operator's licence for the Auckland casino, for approval of new temporary floor plans, "Platinum Stage 7 Temporary" and "Platinum Stage 8 Temporary"
2. SCML is currently reliant on "Platinum Stage 6 Temporary" and seeks approval of the new temporary floor plans to allow it to continue with its refurbishment of the Platinum Room. The proposed floor plans relocate a number of gaming machines within the Platinum Room
3. The application raises no issues the Commission needs to consider. Accordingly the application is approved by the Chief Gambling Commissioner and the Executive Director under delegated authority pursuant to condition 11 of SCML's operator's licence. Floor plans "Platinum Stage 7 Temporary" and "Platinum Stage 8 Temporary" (attached) are approved.
4. Floor plan "Platinum Stage 6 Temporary" ceases to be valid once SCML is fully reliant on "Platinum Stage 7 Temporary" and "Platinum Stage 7 Temporary" ceases to be valid once SCML is fully reliant on "Platinum Stage 8 Temporary"

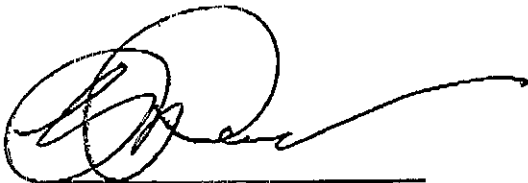

Graeme Reeves
Chief Gambling Commissioner
Gambling Commission

2nd February 2011



Blair Cairncross
Executive Director
Gambling Commission

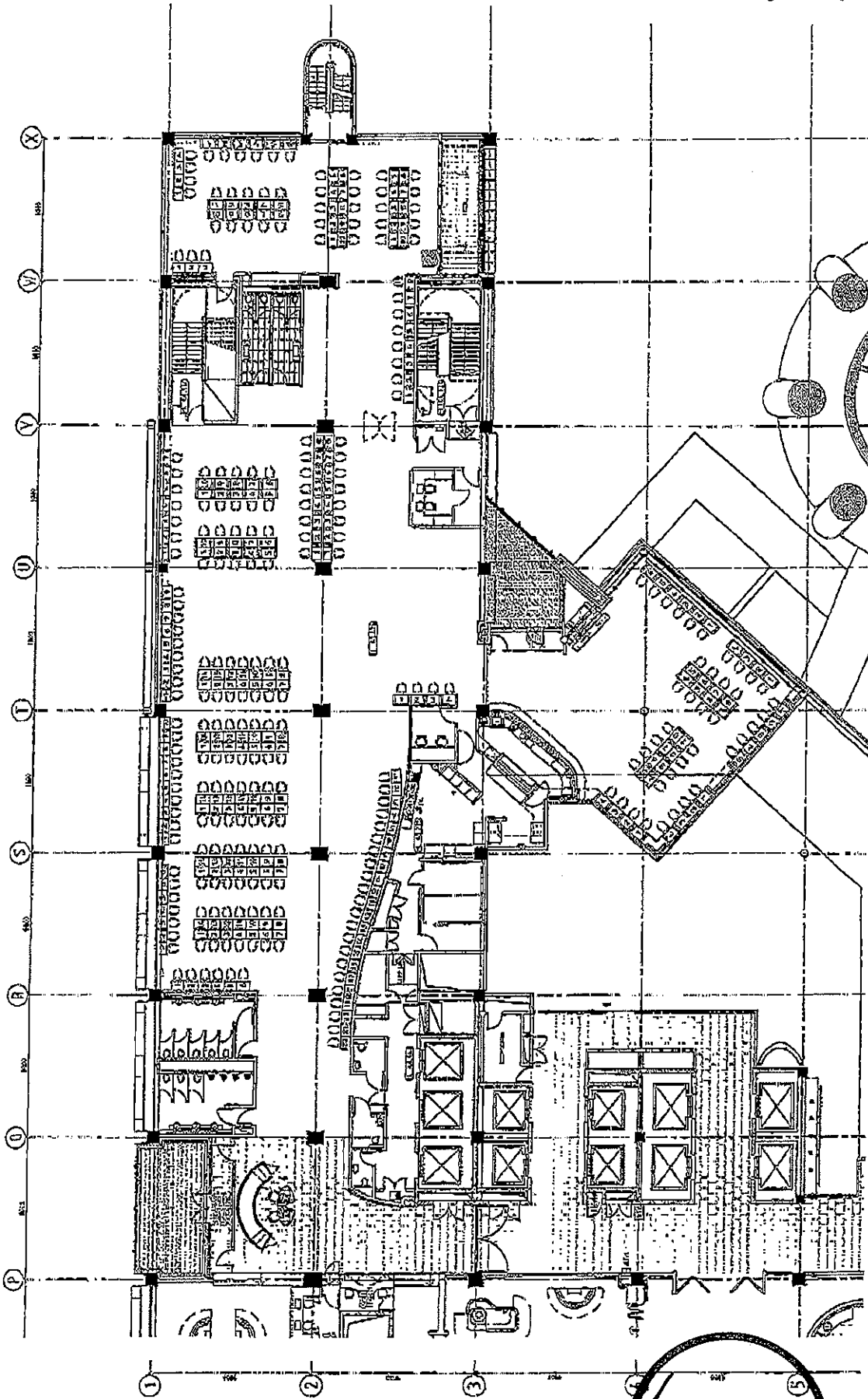

FOR THE RECORD
 PLANNING DEPARTMENT
 CITY OF LAS VEGAS
 200 N. LAS VEGAS BLVD.
 LAS VEGAS, NV 89101

SKY CITY
 ENTERTAINMENT GROUP
 GAMING LAYOUTS

Level 3 Gaming Layout
 SKY CITY

DATE: 10/15/2010
 BY: [Signature]
 FOR: [Signature]

100% TO BE SUBMITTED
 FOR REVIEW AND APPROVAL
 BY THE GAMING BOARD

61920 / A1920(8) / 23

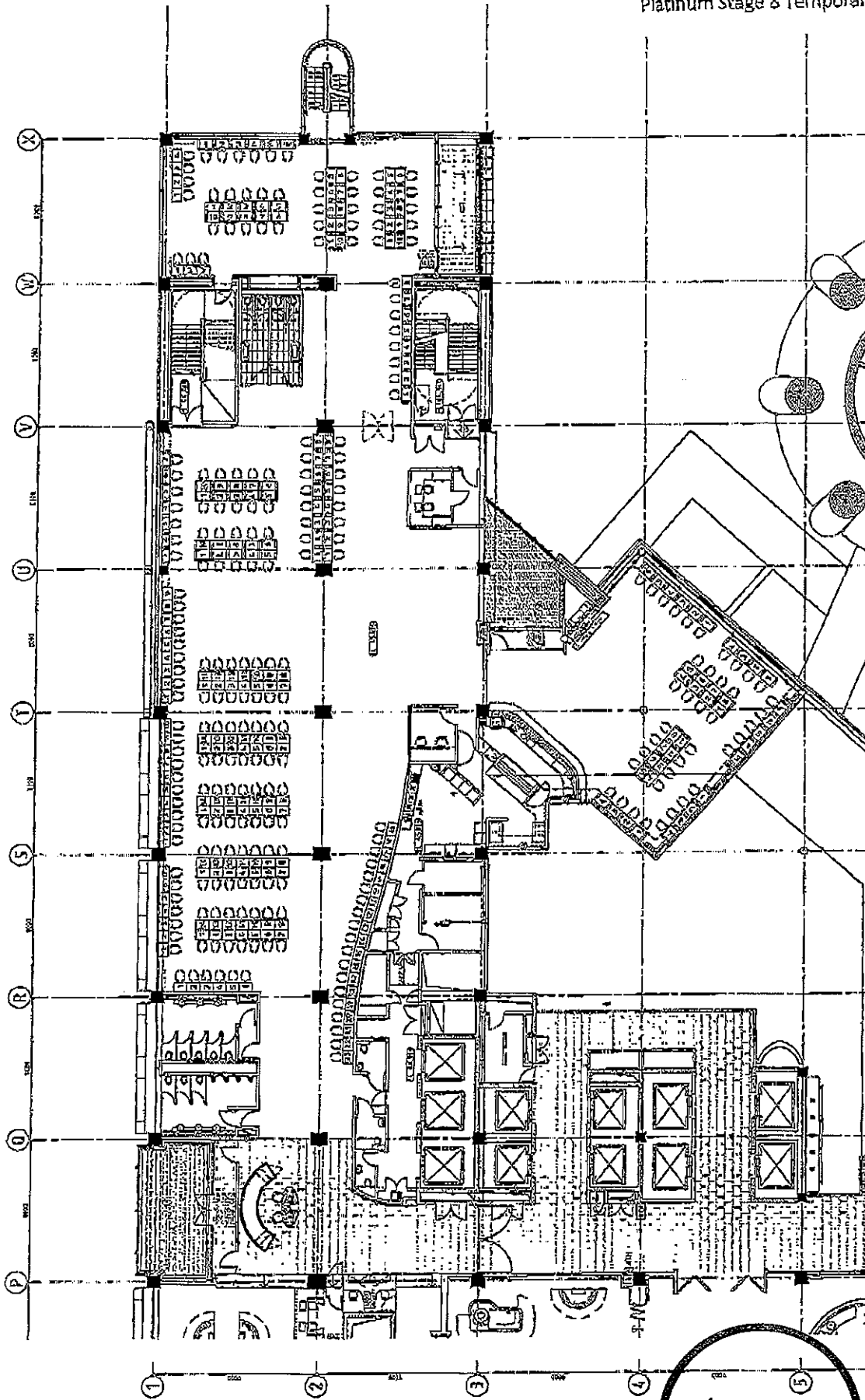

100-443644-1
 100-443644-2
 100-443644-3
 100-443644-4
 100-443644-5
 100-443644-6
 100-443644-7
 100-443644-8
 100-443644-9
 100-443644-10
 100-443644-11
 100-443644-12
 100-443644-13
 100-443644-14
 100-443644-15
 100-443644-16
 100-443644-17
 100-443644-18
 100-443644-19
 100-443644-20
 100-443644-21
 100-443644-22
 100-443644-23
 100-443644-24
 100-443644-25
 100-443644-26
 100-443644-27
 100-443644-28
 100-443644-29
 100-443644-30
 100-443644-31
 100-443644-32
 100-443644-33
 100-443644-34
 100-443644-35
 100-443644-36
 100-443644-37
 100-443644-38
 100-443644-39
 100-443644-40
 100-443644-41
 100-443644-42
 100-443644-43
 100-443644-44
 100-443644-45
 100-443644-46
 100-443644-47
 100-443644-48
 100-443644-49
 100-443644-50
 100-443644-51
 100-443644-52
 100-443644-53
 100-443644-54
 100-443644-55
 100-443644-56
 100-443644-57
 100-443644-58
 100-443644-59
 100-443644-60
 100-443644-61
 100-443644-62
 100-443644-63
 100-443644-64
 100-443644-65
 100-443644-66
 100-443644-67
 100-443644-68
 100-443644-69
 100-443644-70
 100-443644-71
 100-443644-72
 100-443644-73
 100-443644-74
 100-443644-75
 100-443644-76
 100-443644-77
 100-443644-78
 100-443644-79
 100-443644-80
 100-443644-81
 100-443644-82
 100-443644-83
 100-443644-84
 100-443644-85
 100-443644-86
 100-443644-87
 100-443644-88
 100-443644-89
 100-443644-90
 100-443644-91
 100-443644-92
 100-443644-93
 100-443644-94
 100-443644-95
 100-443644-96
 100-443644-97
 100-443644-98
 100-443644-99
 100-443644-100

muller Moller Architects®

SKY CITY ENTERTAINMENT GROUP
 GAMING LAYOUTS

[illegible]

Level 3 Gaming Layout
SIXGATE
platinum 1151

[illegible]