

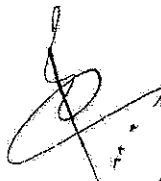

**DECISION UNDER DELEGATED AUTHORITY ON AN APPLICATION
BY DUNEDIN CASINOS MANAGEMENT LIMITED FOR APPROVAL
OF A NEW FLOOR PLAN FOR THE DUNEDIN CASINO**

Date of Decision: 23 November 2010

Introduction

1. On 17 November 2010, Dunedin Casinos Management Limited ("**DCML**") applied, pursuant to condition 12 of its operator's licence, for approval of a new gaming machine floor layout
2. DCML wants to relocate 2 gaming machines within its designated gambling area.
3. The application raises no issues the Commission needs to consider. Accordingly the application is approved by the Chief Gambling Commissioner and the Executive Director under delegated authority pursuant to condition 12 of DCML's operator's licence.
4. DCML's current gaming machine floor plan ceases to be valid once DCML is fully reliant on its new plan. DCML's new plan is attached.



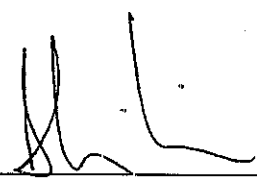

Peter Chin
Chief Gambling Commissioner
Gambling Commission

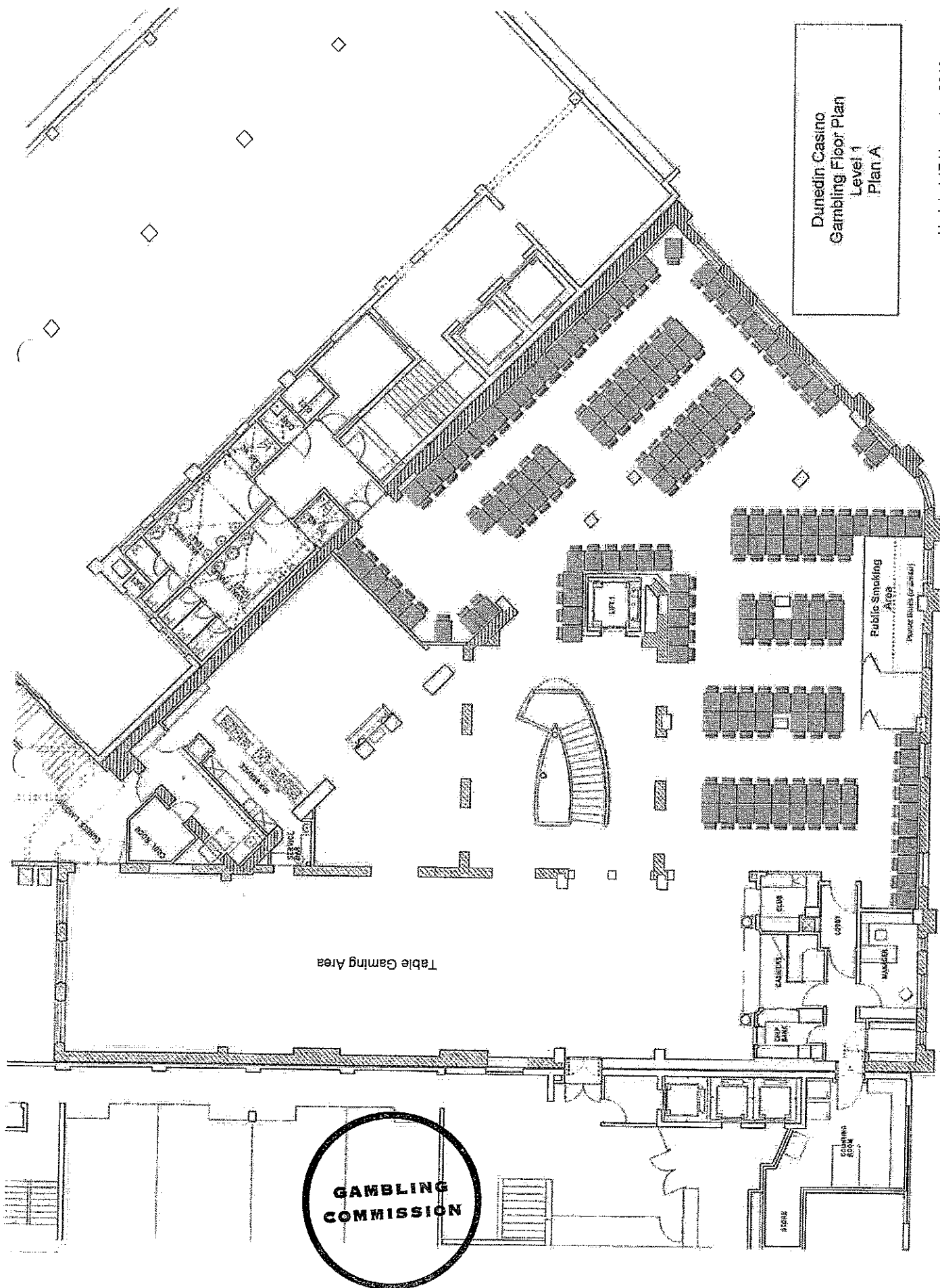

Blair Cairncross
Executive Director
Gambling Commission

23 November 2010



Dunedin Casino
Gambling Floor Plan
Level 1
Plan A

Updated 17 November 2010