

**DECISION UNDER DELEGATED AUTHORITY ON AN  
APPLICATION BY SKYCITY CASINO MANAGEMENT LIMITED FOR APPROVAL  
OF NEW FLOOR PLANS FOR THE AUCKLAND CASINO**

**Date of Decision:** 18 September 2009

- 1 On 11 September 2009, SKYCITY Casino Management Limited ("SCML") applied, pursuant to condition 11 of its operator's licence for the Auckland casino, for approval of new floor plans, "Sept 09"
- 2 The application raises no issues the Commission needs to consider. Accordingly the application is approved by the Chief Gambling Commissioner and the Executive Director under delegated authority pursuant to condition 11 of SCML's operator's licence
- 3 Floor plan "April 2009 V2" ceases to be valid once SCML is fully reliant on plan "Sept 09"
- 4 Floor plans "Sept 2009" are attached

  
**Peter Chin**  
Chief Gambling Commissioner  
Gambling Commission

  
**Blair Cairncross**  
Acting Executive Director  
Gambling Commission

18 September 2009

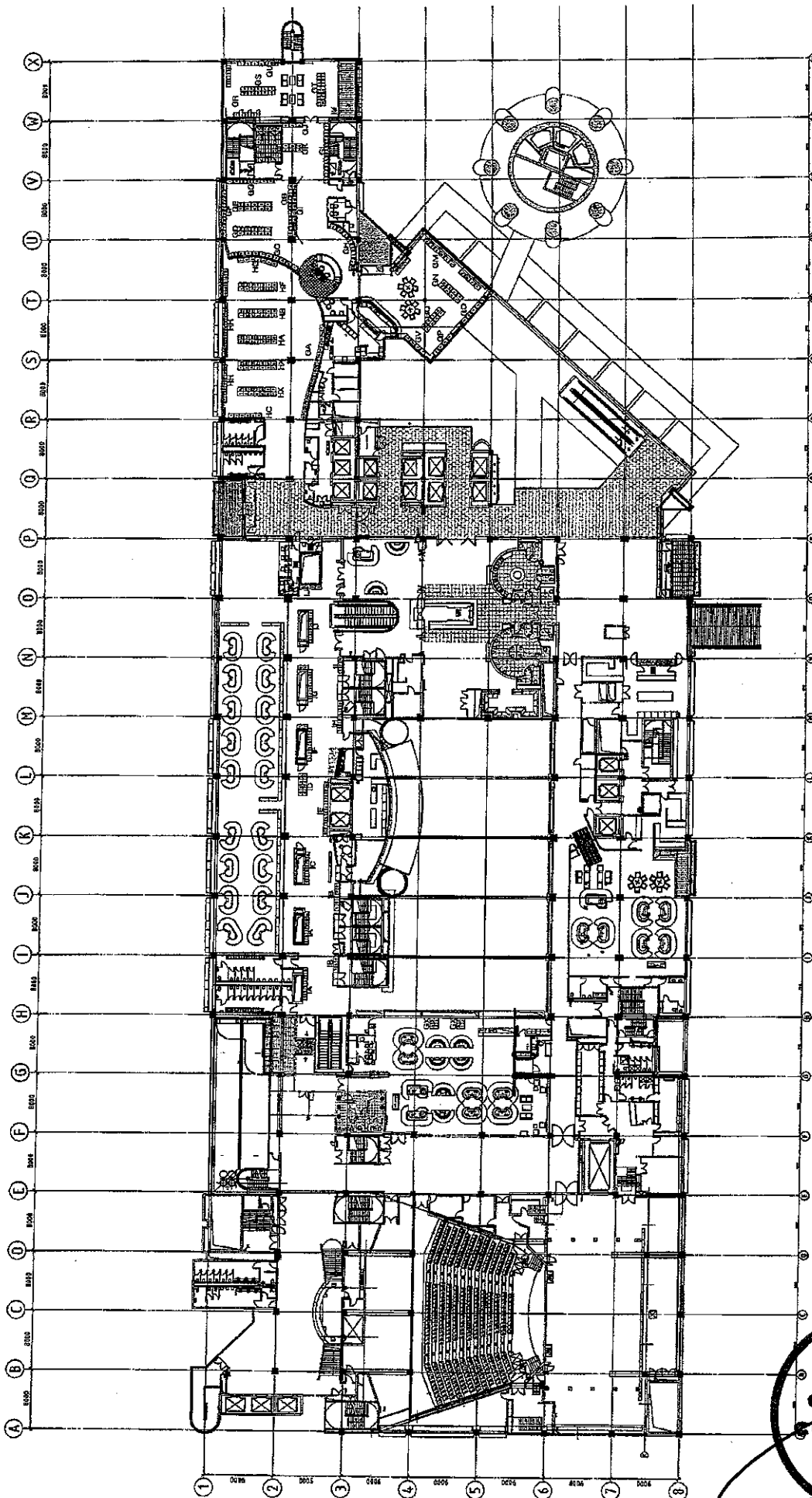

SCHEDULE		GAMING MACHINES	
PLAY	= 12	ADULTS	= 27
PACIFIC	= 14	PACIFIC ROOM	= 4
WEST ROOM	= 6	WESTERN ROOM	= 24
BAR LINES	= 27	POOL	= 1
BAR	= 27	BAR	= 1
GRAND TOTAL	= 110	GRAND TOTAL	= 112
		ADULTS	= 144
		ADULTS	= 6

**SCHEDULE**  
GAMING TABLE  
PLAY  
PACIFIC  
WHEEL ROOM  
WHEEL LEVEL  
MAIN GAMING  
GRAND TOTAL

REVISED	BY	DATE
10	10	10
11	11	11
12	12	12
13	13	13
14	14	14
15	15	15
16	16	16
17	17	17
18	18	18
19	19	19
20	20	20
21	21	21
22	22	22
23	23	23
24	24	24
25	25	25
26	26	26
27	27	27
28	28	28
29	29	29
30	30	30
31	31	31
32	32	32
33	33	33
34	34	34
35	35	35
36	36	36
37	37	37
38	38	38
39	39	39
40	40	40
41	41	41
42	42	42
43	43	43
44	44	44
45	45	45
46	46	46
47	47	47
48	48	48
49	49	49
50	50	50
51	51	51
52	52	52
53	53	53
54	54	54
55	55	55
56	56	56
57	57	57
58	58	58
59	59	59
60	60	60
61	61	61
62	62	62
63	63	63
64	64	64
65	65	65
66	66	66
67	67	67
68	68	68
69	69	69
70	70	70
71	71	71
72	72	72
73	73	73
74	74	74
75	75	75
76	76	76
77	77	77
78	78	78
79	79	79
80	80	80
81	81	81
82	82	82
83	83	83
84	84	84
85	85	85
86	86	86
87	87	87
88	88	88
89	89	89
90	90	90
91	91	91
92	92	92
93	93	93
94	94	94
95	95	95
96	96	96
97	97	97
98	98	98
99	99	99
100	100	100

**DRAWING TITLE**  
**Level 3 Gaming Layout**  
**SKYCITY**  
**Post Refurb Proposed Layout**

• Refer to Section 1 for Original Schedule  
This Contract was made by and between the undersigned  
This drawing shall be read in conjunction with all of the related documents  
Copyright © Civil Engineering Limited 2002

[illegible]

## Sky City Entertainment Group Gaining Layouts



SKYCITY  
ENTERTAINMENT GROUP

Call +64 9 357 0608  
Fax +64 9 357 0609  
Level 13 Viaduct Place  
131 Albert Street  
PO Box 20200  
Auckland, New Zealand  
[enquiries@machitect.co.nz](mailto:enquiries@machitect.co.nz)

Moller  
architects®

# THE

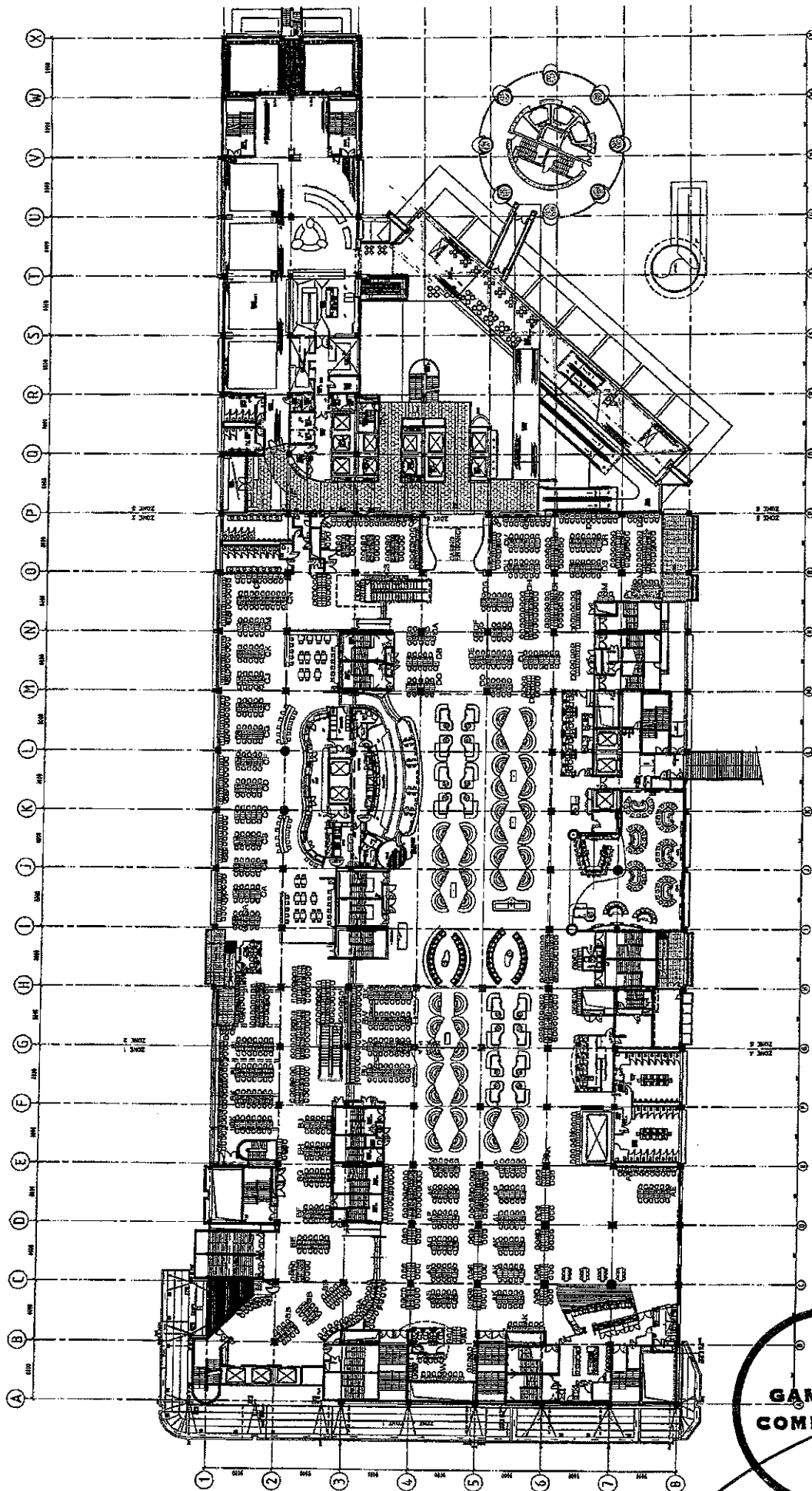

SCHEDULE	
GAMING TABLES	
PLAY PACIFIC	• 17
PACIFIC	• 6
BEST TOTAL	• 8
TOTAL TOOLS	• 29
MANAGEMENT	• 21
BOULET TOTAL	• 71

CASINO MACHINES	
TOTAL •	24177
TOTAL •	127
APPS. BY CASH	• 140
AVAL. SLOTS	• 6

REVISION		BY	DATE
1	FOR APPROVAL	JS	10/20/00
2	REVISED DRAINAGE WORK	JS	11/20/00
3	REVISED DRAINAGE WORK	JS	12/20/00
4	REVISED DRAINAGE WORK	JS	1/20/01
5	REVISED DRAINAGE WORK	JS	2/20/01
6	REVISED DRAINAGE WORK	JS	3/20/01
7	REVISED DRAINAGE WORK	JS	4/20/01
8	REVISED DRAINAGE WORK	JS	5/20/01
9	REVISED DRAINAGE WORK	JS	6/20/01
10	REVISED DRAINAGE WORK	JS	7/20/01
11	REVISED DRAINAGE WORK	JS	8/20/01
12	REVISED DRAINAGE WORK	JS	9/20/01
13	REVISED DRAINAGE WORK	JS	10/20/01
14	REVISED DRAINAGE WORK	JS	11/20/01
15	REVISED DRAINAGE WORK	JS	12/20/01
16	REVISED DRAINAGE WORK	JS	1/20/02
17	REVISED DRAINAGE WORK	JS	2/20/02
18	REVISED DRAINAGE WORK	JS	3/20/02
19	REVISED DRAINAGE WORK	JS	4/20/02
20	REVISED DRAINAGE WORK	JS	5/20/02
21	REVISED DRAINAGE WORK	JS	6/20/02
22	REVISED DRAINAGE WORK	JS	7/20/02
23	REVISED DRAINAGE WORK	JS	8/20/02
24	REVISED DRAINAGE WORK	JS	9/20/02
25	REVISED DRAINAGE WORK	JS	10/20/02
26	REVISED DRAINAGE WORK	JS	11/20/02
27	REVISED DRAINAGE WORK	JS	12/20/02
28	REVISED DRAINAGE WORK	JS	1/20/03
29	REVISED DRAINAGE WORK	JS	2/20/03
30	REVISED DRAINAGE WORK	JS	3/20/03
31	REVISED DRAINAGE WORK	JS	4/20/03
32	REVISED DRAINAGE WORK	JS	5/20/03
33	REVISED DRAINAGE WORK	JS	6/20/03
34	REVISED DRAINAGE WORK	JS	7/20/03
35	REVISED DRAINAGE WORK	JS	8/20/03
36	REVISED DRAINAGE WORK	JS	9/20/03
37	REVISED DRAINAGE WORK	JS	10/20/03
38	REVISED DRAINAGE WORK	JS	11/20/03
39	REVISED DRAINAGE WORK	JS	12/20/03
40	REVISED DRAINAGE WORK	JS	1/20/04
41	REVISED DRAINAGE WORK	JS	2/20/04
42	REVISED DRAINAGE WORK	JS	3/20/04
43	REVISED DRAINAGE WORK	JS	4/20/04
44	REVISED DRAINAGE WORK	JS	5/20/04
45	REVISED DRAINAGE WORK	JS	6/20/04
46	REVISED DRAINAGE WORK	JS	7/20/04
47	REVISED DRAINAGE WORK	JS	8/20/04
48	REVISED DRAINAGE WORK	JS	9/20/04
49	REVISED DRAINAGE WORK	JS	10/20/04
50	REVISED DRAINAGE WORK	JS	11/20/04
51	REVISED DRAINAGE WORK	JS	12/20/04
52	REVISED DRAINAGE WORK	JS	1/20/05
53	REVISED DRAINAGE WORK	JS	2/20/05
54	REVISED DRAINAGE WORK	JS	3/20/05
55	REVISED DRAINAGE WORK	JS	4/20/05
56	REVISED DRAINAGE WORK	JS	5/20/05
57	REVISED DRAINAGE WORK	JS	6/20/05
58	REVISED DRAINAGE WORK	JS	7/20/05
59	REVISED DRAINAGE WORK	JS	8/20/05
60	REVISED DRAINAGE WORK	JS	9/20/05
61	REVISED DRAINAGE WORK	JS	10/20/05
62	REVISED DRAINAGE WORK	JS	11/20/05
63	REVISED DRAINAGE WORK	JS	12/20/05
64	REVISED DRAINAGE WORK	JS	1/20/06
65	REVISED DRAINAGE WORK	JS	2/20/06
66	REVISED DRAINAGE WORK	JS	3/20/06
67	REVISED DRAINAGE WORK	JS	4/20/06
68	REVISED DRAINAGE WORK	JS	5/20/06
69	REVISED DRAINAGE WORK	JS	6/20/06
70	REVISED DRAINAGE WORK	JS	7/20/06
71	REVISED DRAINAGE WORK	JS	8/20/06
72	REVISED DRAINAGE WORK	JS	9/20/06
73	REVISED DRAINAGE WORK	JS	10/20/06
74	REVISED DRAINAGE WORK	JS	11/20/06
75	REVISED DRAINAGE WORK	JS	12/20/06
76	REVISED DRAINAGE WORK	JS	1/20/07
77	REVISED DRAINAGE WORK	JS	2/20/07
78	REVISED DRAINAGE WORK	JS	3/20/07
79	REVISED DRAINAGE WORK	JS	4/20/07
80	REVISED DRAINAGE WORK	JS	5/20/07
81	REVISED DRAINAGE WORK	JS	6/20/07
82	REVISED DRAINAGE WORK	JS	7/20/07
83	REVISED DRAINAGE WORK	JS	8/20/07
84	REVISED DRAINAGE WORK	JS	9/20/07
85	REVISED DRAINAGE WORK	JS	10/20/07
86	REVISED DRAINAGE WORK	JS	11/20/07

**DRAWING TITLE**  
Level 2 Gaming Layout  
SKYCity  
Proposed Layout - Post Reliub  
1202 (M)

\* Near to Station 1 for Digital Signature  
Main Contractor shall verify all dimensions before commencing work  
This drawing shall be used in conjunction with all relevant documents  
Copyright © Craig Cooksley Architects Limited 2002

SEAWORTH INFORMATION					
Vessel		Dated	File #	(M)	TOD
Status	A/C	Received Date	File #	2009	
Dep. Chg.	TWO	Approved for Production Date			
Est. On	/	/	/		
COS File	K:\N0125-107 Seaworth Legends\2009-10-REITS-9-12-seaworth Legend				
Print Date	Monday 7 September 2008 9:12:44 am				

**Skv City Entertainment Group  
Gaming Layouts**

**SKY**  
 ABOVE THE HORIZON

Call +54 9 3570686  
Fax +54 9 3570689

Level 13 City of Mexico  
P.O. Box 300  
Mexico 067-000  
No. 305-205  
Humboldt, 16 Ave. 23 July 2000

[www.embassyofmexico.com](http://www.embassyofmexico.com)

**Moller  
Architects®**

1. **Introduction**  
 2. **Background**  
 3. **Methodology**  
 4. **Results**  
 5. **Discussion**  
 6. **Conclusion**  
 7. **References**  
 8. **Appendix**  
 9. **Figure 1**  
 10. **Figure 2**  
 11. **Figure 3**  
 12. **Figure 4**  
 13. **Figure 5**  
 14. **Figure 6**  
 15. **Figure 7**  
 16. **Figure 8**  
 17. **Figure 9**  
 18. **Figure 10**  
 19. **Figure 11**  
 20. **Figure 12**  
 21. **Figure 13**  
 22. **Figure 14**  
 23. **Figure 15**  
 24. **Figure 16**  
 25. **Figure 17**  
 26. **Figure 18**  
 27. **Figure 19**  
 28. **Figure 20**  
 29. **Figure 21**  
 30. **Figure 22**  
 31. **Figure 23**  
 32. **Figure 24**  
 33. **Figure 25**  
 34. **Figure 26**  
 35. **Figure 27**  
 36. **Figure 28**  
 37. **Figure 29**  
 38. **Figure 30**  
 39. **Figure 31**  
 40. **Figure 32**  
 41. **Figure 33**  
 42. **Figure 34**  
 43. **Figure 35**  
 44. **Figure 36**  
 45. **Figure 37**  
 46. **Figure 38**  
 47. **Figure 39**  
 48. **Figure 40**  
 49. **Figure 41**  
 50. **Figure 42**  
 51. **Figure 43**  
 52. **Figure 44**  
 53. **Figure 45**  
 54. **Figure 46**  
 55. **Figure 47**  
 56. **Figure 48**  
 57. **Figure 49**  
 58. **Figure 50**  
 59. **Figure 51**  
 60. **Figure 52**  
 61. **Figure 53**  
 62. **Figure 54**  
 63. **Figure 55**  
 64. **Figure 56**  
 65. **Figure 57**  
 66. **Figure 58**  
 67. **Figure 59**  
 68. **Figure 60**  
 69. **Figure 61**  
 70. **Figure 62**  
 71. **Figure 63**  
 72. **Figure 64**  
 73. **Figure 65**  
 74. **Figure 66**  
 75. **Figure 67**  
 76. **Figure 68**  
 77. **Figure 69**  
 78. **Figure 70**  
 79. **Figure 71**  
 80. **Figure 72**  
 81. **Figure 73**  
 82. **Figure 74**  
 83. **Figure 75**  
 84. **Figure 76**  
 85. **Figure 77**  
 86. **Figure 78**  
 87. **Figure 79**  
 88. **Figure 80**  
 89. **Figure 81**  
 90. **Figure 82**  
 91. **Figure 83**  
 92. **Figure 84**  
 93. **Figure 85**  
 94. **Figure 86**  
 95. **Figure 87**  
 96. **Figure 88**  
 97. **Figure 89**  
 98. **Figure 90**  
 99. **Figure 91**  
 100. **Figure 92**  
 101. **Figure 93**  
 102. **Figure 94**  
 103. **Figure 95**  
 104. **Figure 96**  
 105. **Figure 97**  
 106. **Figure 98**  
 107. **Figure 99**  
 108. **Figure 100**  
 109. **Figure 101**  
 110. **Figure 102**  
 111. **Figure 103**  
 112. **Figure 104**  
 113. **Figure 105**  
 114. **Figure 106**  
 115. **Figure 107**  
 116. **Figure 108**  
 117. **Figure 109**  
 118. **Figure 110**  
 119. **Figure 111**  
 120. **Figure 112**  
 121. **Figure 113**  
 122. **Figure 114**  
 123. **Figure 115**  
 124. **Figure 116**  
 125. **Figure 117**  
 126. **Figure 118**  
 127. **Figure 119**  
 128. **Figure 120**  
 129. **Figure 121**  
 130. **Figure 122**  
 131. **Figure 123**  
 132. **Figure 124**  
 133. **Figure 125**  
 134. **Figure 126**  
 135. **Figure 127**  
 136. **Figure 128**  
 137. **Figure 129**  
 138. **Figure 130**  
 139. **Figure 131**  
 140. **Figure 132**  
 141. **Figure 133**  
 142. **Figure 134**  
 143. **Figure 135**  
 144. **Figure 136**  
 145. **Figure 137**  
 146. **Figure 138**  
 147. **Figure 139**  
 148. **Figure 140**  
 149. **Figure 141**  
 150. **Figure 142**  
 151. **Figure 143**  
 152. **Figure 144**  
 153. **Figure 145**  
 154. **Figure 146**  
 155. **Figure 147**  
 156. **Figure 148**  
 157. **Figure 149**  
 158. **Figure 150**  
 159. **Figure 151**  
 160. **Figure 152**  
 161. **Figure 153**  
 162. **Figure 154**  
 163. **Figure 155**  
 164. **Figure 156**  
 165. **Figure 157**  
 166. **Figure 158**  
 167. **Figure 159**  
 168. **Figure 160**  
 169. **Figure 161**  
 170. **Figure 162**  
 171. **Figure 163**  
 172. **Figure 164**  
 173. **Figure 165**  
 174. **Figure 166**  
 175. **Figure 167**  
 176. **Figure 168**  
 177. **Figure 169**  
 178. **Figure 170**  
 179. **Figure 171**  
 180. **Figure 172**  
 181. **Figure 173**  
 182. **Figure 174**  
 183. **Figure 175**  
 184. **Figure 176**  
 185. **Figure 177**  
 186. **Figure 178**  
 187. **Figure 179**  
 188. **Figure 180**  
 189. **Figure 181**  
 190. **Figure 182**  
 191. **Figure 183**  
 192. **Figure 184**  
 193. **Figure 185**  
 194. **Figure 186**  
 195. **Figure 187**  
 196. **Figure 188**  
 197. **Figure 189**  
 198. **Figure 190**  
 199. **Figure 191**  
 200. **Figure 192**  
 201. **Figure 193**  
 202. **Figure 194**  
 203. **Figure 195**  
 204. **Figure 196**  
 205. **Figure 197**  
 206. **Figure 198**  
 207. **Figure 199**  
 208. **Figure 200**  
 209. **Figure 201**  
 210. **Figure 202**  
 211. **Figure 203**  
 212. **Figure 204**  
 213. **Figure 205**  
 214. **Figure 206**  
 215. **Figure 207**  
 216. **Figure 208**  
 217. **Figure 209**