



**DECISION UNDER DELEGATED AUTHORITY ON AN APPLICATION  
BY DUNEDIN CASINOS MANAGEMENT LIMITED FOR APPROVAL  
OF A NEW FLOOR PLAN FOR THE DUNEDIN CASINO**

**Date of Decision:**     /     **March 2013**

1. On 27 February 2013, Dunedin Casinos Management Limited ("DCML") applied, pursuant to conditions 11 and 12 of its operator's licence, for approval of a new gaming machine floor layout. Conditions 11 and 12 provide as follows:
  11. The Licence Holder shall operate in accordance with approved floor layouts showing the position of gaming tables and gaming machines.
  12. The Licence Holder shall obtain approval for new floor plans prior to relocating or installing tables or machines in positions not specified in approved floor layouts. When applying, the Licence Holder must submit fresh plans showing the floor layout for the Gambling Area and details of the proposed CCTV layout for consideration. Any change must comply with the Surveillance Standard. The Executive Director and a single Gambling Commissioner may approve the new floor plans if they are satisfied that the floor layout has no potentially adverse effects. If they are not so satisfied, the proposed floor plan must be referred to the Commission for a decision on approval.
2. DCML stated that it wants to rotate two gaming machines 90 degrees from their current position.
3. The application raises no issues the Commission needs to consider. Accordingly the application is approved by the Chief Gambling Commissioner and the Executive Director under delegated authority pursuant to conditions 11 and 12 of DCML's operator's licence.
4. DCML's current gaming machine floor plan labelled "June 2012" ceases to be valid once DCML is fully reliant on its new plan. DCML's new plan (labelled "February 2013") is attached.

  
**Graeme Reeves**  
Chief Gambling Commissioner  
Gambling Commission

  
**Blair Cairncross**  
Executive Director  
Gambling Commission

/ March 2013

**GAMBLING  
COMMISSION**

February 2013

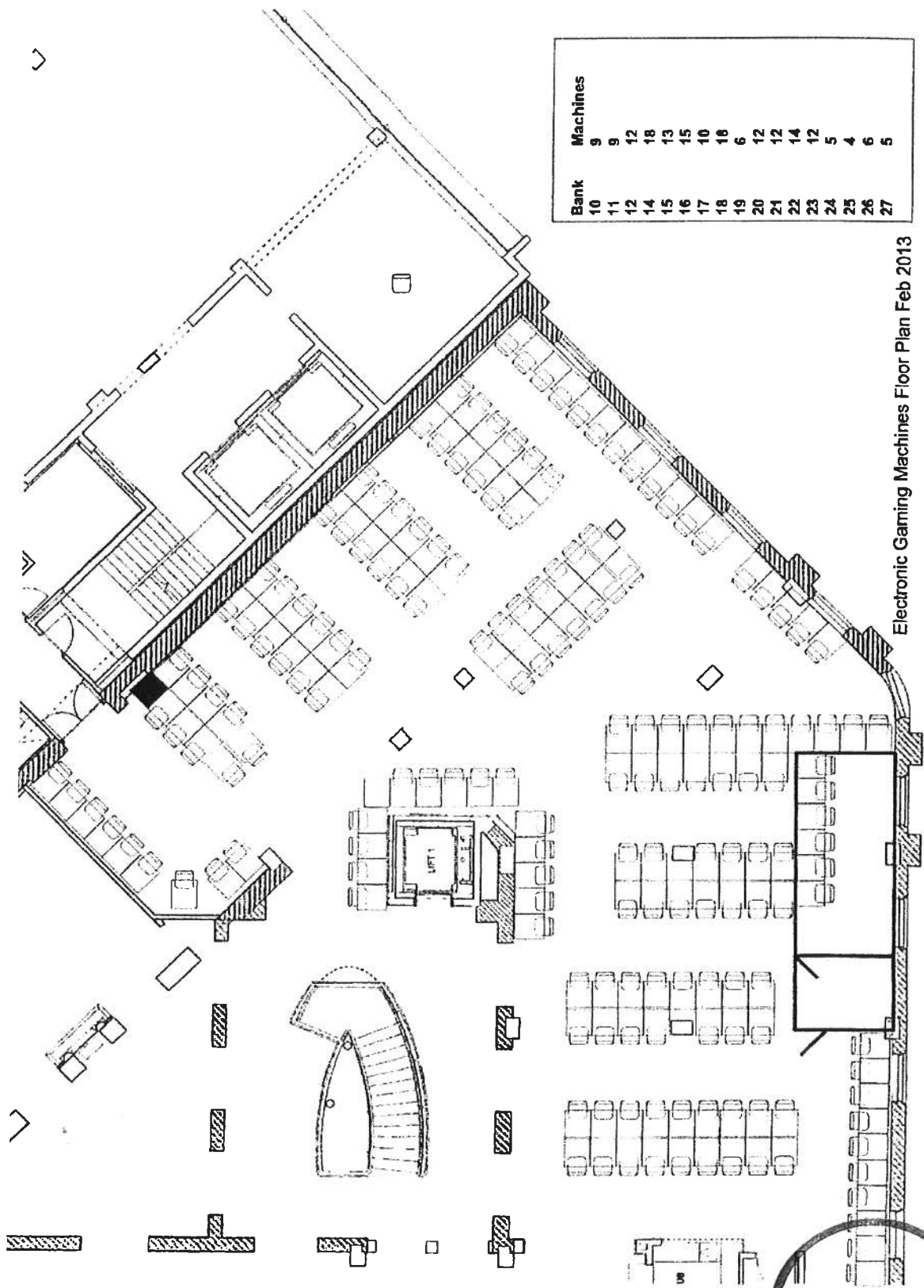

Electronic Gaming Machines Floor Plan Feb 2013

**GAMBLING  
COMMISSION**