

**DECISION UNDER DELEGATED AUTHORITY ON AN APPLICATION
BY SKYCITY CASINO MANAGEMENT LIMITED FOR APPROVAL OF
NEW FLOOR PLANS FOR THE AUCKLAND CASINO**

Date of Decision: 4 December 2012

1. On 30 November 2012, SKYCITY Casino Management Limited ("SCML") applied, pursuant to condition 11 of its operator's licence for the Auckland casino, for approval of new floor plans. The plans will be labelled 2012 L2 001K and 2012 L2 001L.
2. Condition 11 provides as follows:
 11. The Licence Holder shall operate in accordance with approved floor layouts showing the position of gaming tables and gaming machines. The Licence Holder shall obtain approval for new floor plans prior to relocating or installing tables or machines in positions not specified in approved floor layouts. When applying, the Licence Holder must submit fresh plans showing the floor layout for the Gambling Area and details of the proposed CCTV layout for consideration. Any change must comply with the Surveillance Standard. The Executive Director and a single Gambling Commissioner may approve the new floor plans if they are satisfied that the floor layout has no potentially adverse effects. If they are not so satisfied, the proposed floor plan must be referred to the Commission for a decision on approval.
3. SCML stated that it will adopt one of its game mixes which allows for the deployment of a third Rapid Roulette table. To accommodate the installation of this table, a number of tables will be relocated to other parts of the floor, including the location of its two substitute tables.
4. SCML is currently reliant on floor plan 2012 L2 001J. On or around 6 December, it will transition to new floor plan 2012 L2 001K.
5. Following completion of changes to the "Rouge Room" on or around 17 December, the Mini Tai Sai table previously located in this area (and temporarily relocated to "Sammy's Place") will be returned to its original location, as depicted on plan 2012 L2 001L.
6. The proposal raises no issues of regulatory concern for the Commission. Accordingly the proposed new floor plans are approved by the Chief Gambling Commissioner and the Executive Director under delegated authority pursuant to condition 11 of SCML's operator's licence for the Auckland casino. Plans 2012 L2 001K and 2012 L2 001H are attached.



7. Once SCML is reliant on plan 2012 L2 001K, plans 2012 L2 001J and 2012 L2 001H will cease to be valid. Once reliant on plan 2012 L2 001L, plan 2012 L2 001K will cease to be valid.



Graeme Reeves
Chief Gambling Commissioner
Gambling Commission

4 December 2012



**GAMBLING
COMMISSION**



Blair Cairncross
Executive Director
Gambling Commission

A B C D E F G H I J K L M N O P Q R S T U V W X

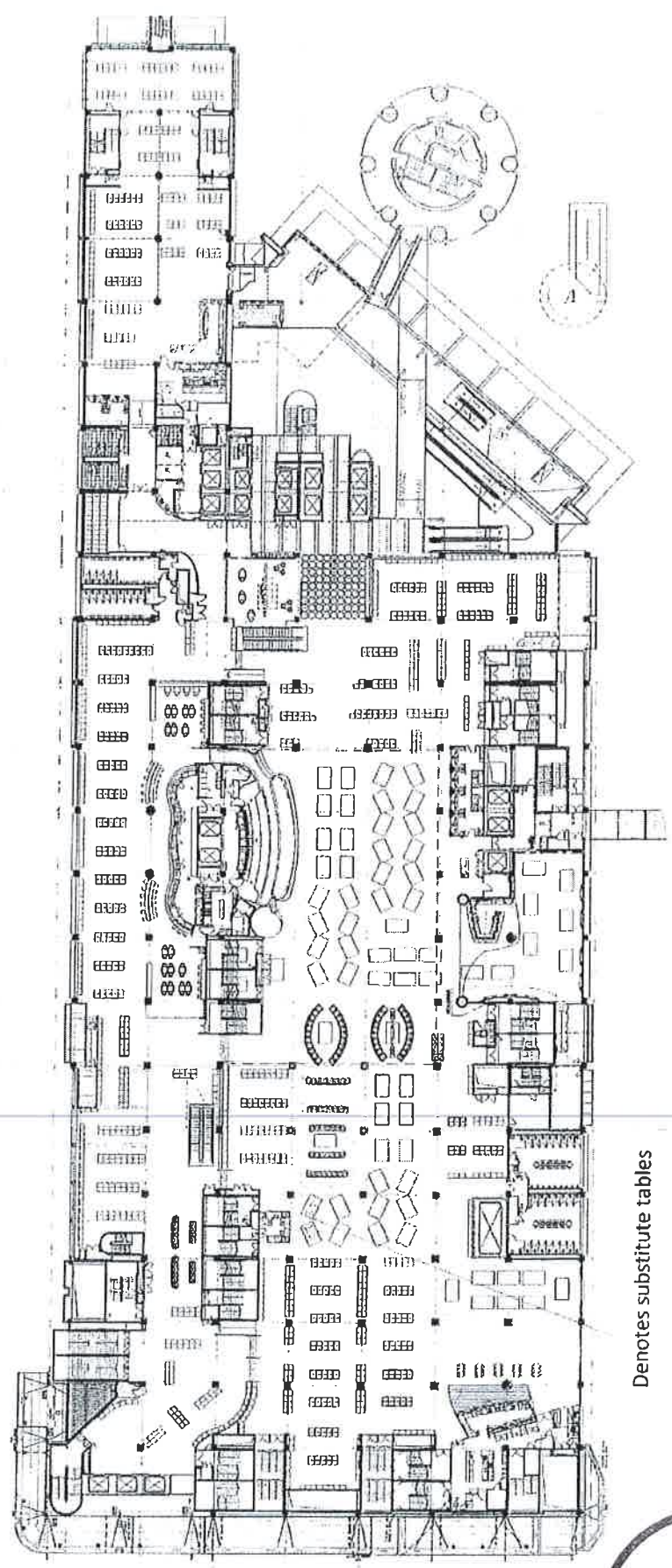

Denotes substitute tables



moller. Architects

404-465-2570
Fax: 404-525-0025
1000 Peachtree Street, N.E.
Atlanta, Georgia 30309

SKY CITY
ENTERTAINMENT GROUP

Level 2 Gaming Layout
SKY CITY
December 10th Stage Part A
29/11/2012

Project Name: Level 2 Gaming Layout
Project No: 1000
Revision: 1000
Date: 29/11/2012
Author: [Name]
Checker: [Name]
Approver: [Name]

5132C A1202

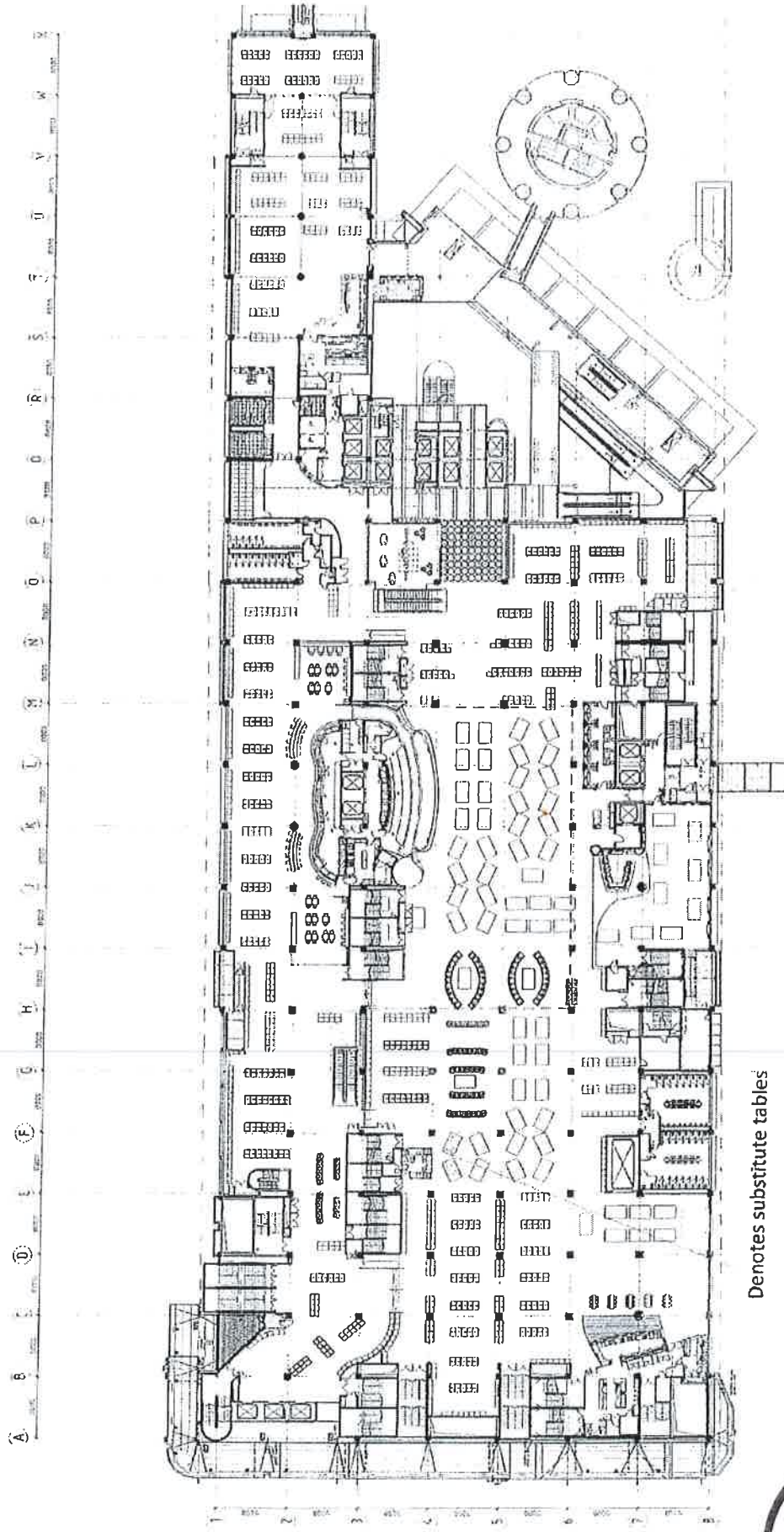

Denotes substitute tables



moller. Moller Architects[®]

Cell: 416 937-0066
Fax: 416 937-0069
100 King Street West
Suite 1200
Toronto, Ontario M5X 1C5
Canada

SKYCITY
100 King Street West
Toronto, Ontario M5X 1C5
Canada

Sky City Entertainment Group
Gaming Layouts

Level 2 Gaming Layout
SKYCITY
December 17th Stage Part B
29/11/2012

5132C

A1202